



OG 2014-Up Touring Drop 1" Triple Trees kit Installation-1.0

Before beginning the installation, please note: If your bike still has the OEM Ignition switch/Fork lock, you will need to have your bike flashed with the "keyless CVO feature" at your local shop prior to starting the installation.

Please refer to your bike service manual for additional guidance.

1. Remove the instrument nacelle.
2. Disconnect Wiring:
 - a. Disconnect left and right handlebar switch connectors.
 - b. Disconnect the ignition switch connector.
 - c. Disconnect the throttle sensor connector.
 - d. Disconnect the upper fork bracket ground connector.
 - e. If equipped, disconnect heated hand grip connectors.

*For a smoother installation, keep your hand controls and switches installed on the handlebar.

3. Separate the handlebar from the top triple tree.
4. Remove the OEM top triple tree.
5. Remove the OEM lower triple tree and fork stem.
6. Slide the **OG Fork Stem** into the **OG Lower Triple Tree**. Refer to the attached diagram. Do not torque the Fork Stem pinch bolt yet.
7. Install lower neck bearing on the **OG Fork Stem**.
8. Install the upper neck bearing & slide the **OG Fork Stem/Lower Triple Tree** assembly into the neck.
9. Thread the OG Stem Nut on the OG Fork Stem. Torque the Stem Nut until the bearings are properly seated.
10. Torque the lower Fork Stem pinch bolt to: **30 ft-lbs**
11. Install your new OG Top Triple Tree. **Do not torque the bolts yet. The tension on the neck bearing needs to be adjusted first.**
12. The risers mounting blocks can be flipped for a 2" pullback setup. 1" Pullback Mounting Blocks are available and sold separately. FL models with batwing fairing will need to run +2" pullback risers position in order to clear the inner fairing.
13. Install Touring Risers bushing. We strongly recommend polyurethane bushings for risers lower than 9" and solid bushings for risers higher than 9".
14. Install your handlebar and risers on the top triple tree.
15. Reconnect the wiring.
16. Carefully route your wires using the supplied P-clamps.
17. Lift the front wheel and adjust the tension on the steering stem.
 - a. Turn the handlebar completely to the left.
 - b. Let go of the handlebar
 - c. It should:
 - i. Pass the neutral point and go right (1)
 - ii. Go left and pass the neutral point (2)
 - iii. Go back and stay at the neutral point (3)
 - d. Add or remove tension on the steering stem bolt depending on the results

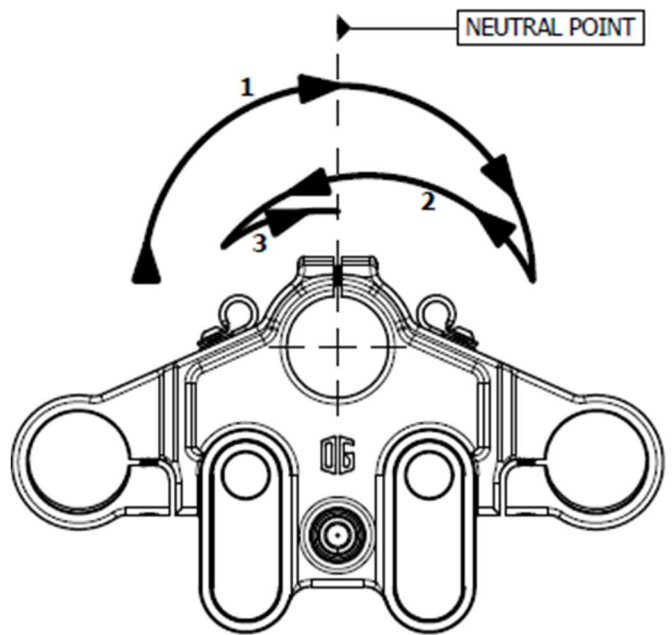

Need help? info@originalgaragemoto.com



OG 2014-Up Touring Drop 1" Triple Trees kit Installation-1.0

18. Torque the Top Triple Tree bolts. **Refer to the attached diagram** for torque specifications and parts assembly.
19. When adjusting the front end height, ensure that the fork tube does not sit below the top of the top triple tree.

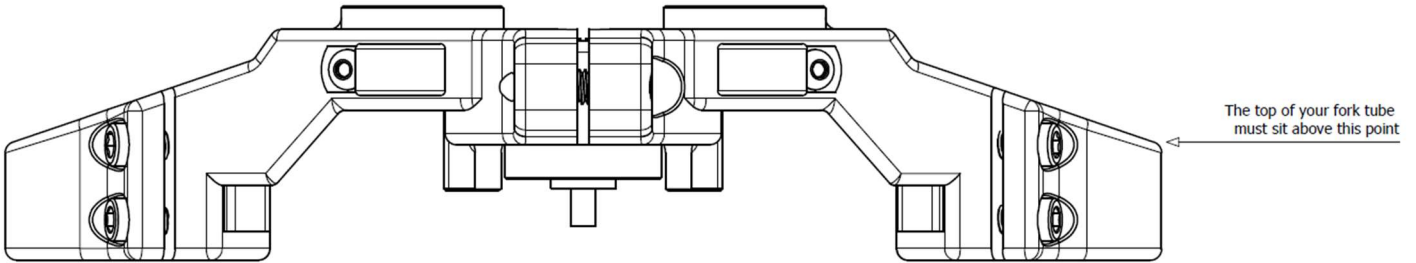

Need help? info@originalgaragemoto.com

OG 2014-2023 Touring Drop 1" Top Triple Tree H-AC-101-XX

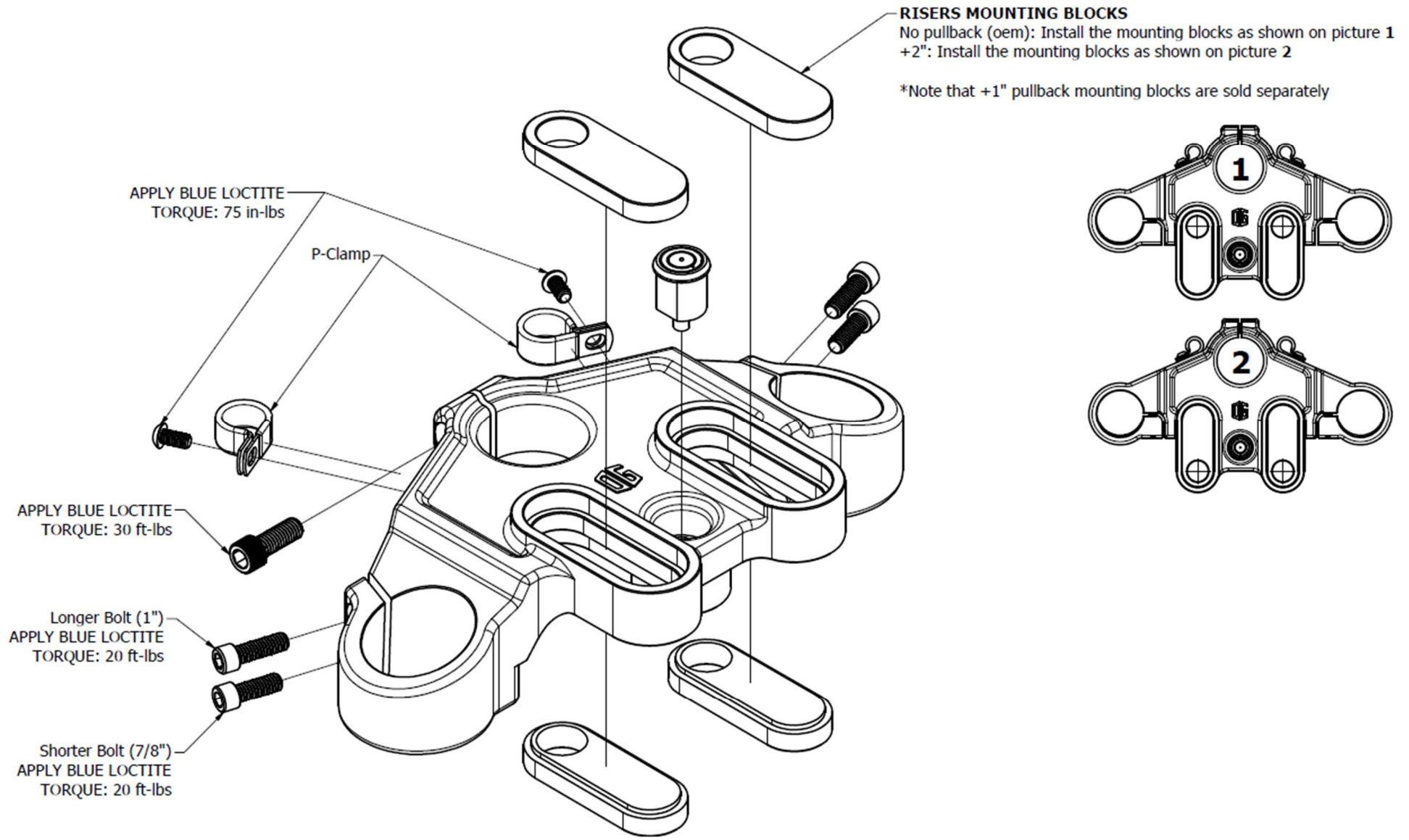

OG 2014-Up Touring Lower Triple Tree kit H-AC-81-XX

