

KAWASAKI MULE PRO FXT

PLOW MOUNT PART #106035

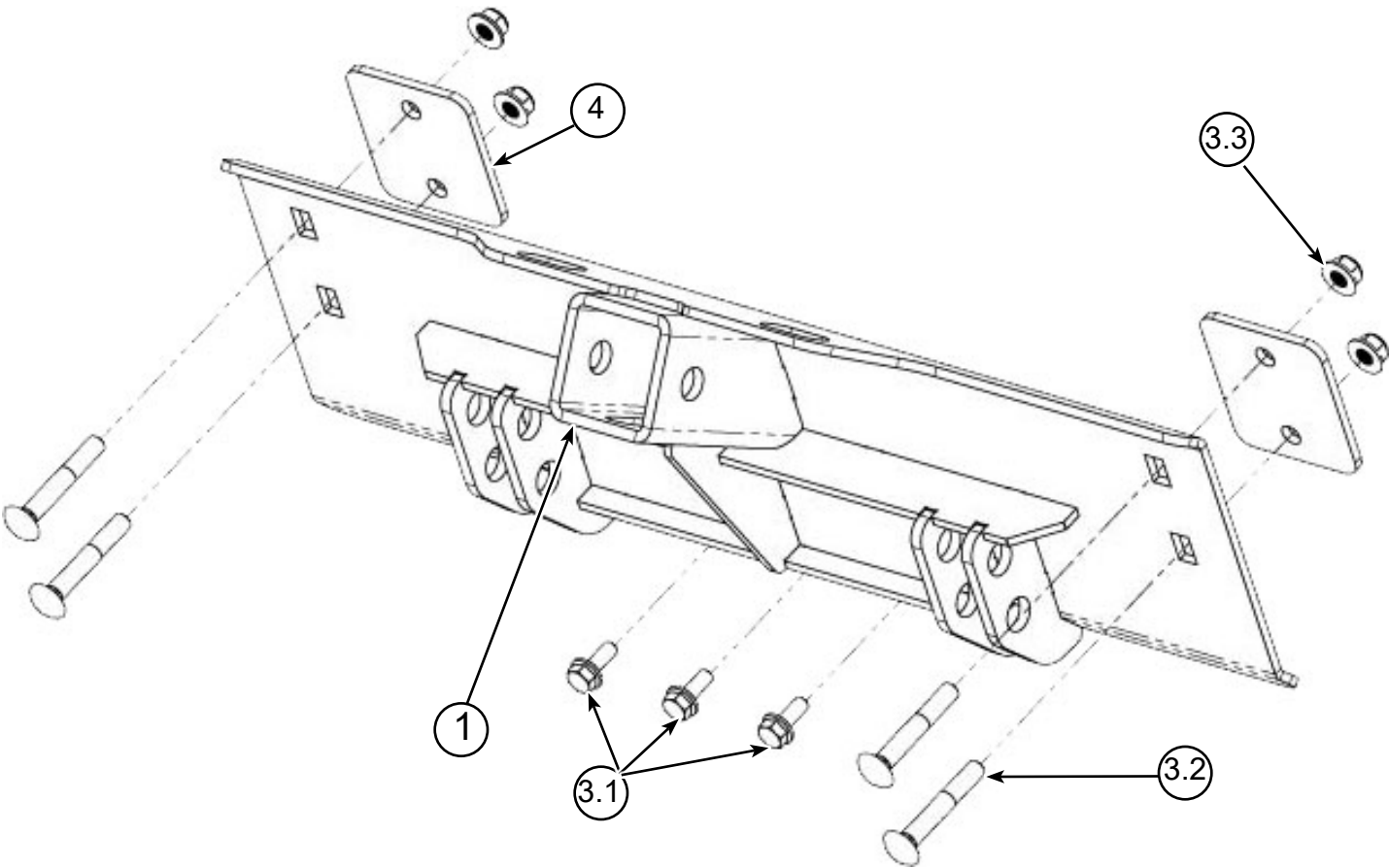

Kit Components:

Item #	Qty.	Description
1	1	Plow mount Mule Pro FXT (106036)
2	2	Backer Plate Mule Pro FXT (105624)

Item #	Qty.	Description
3	1	Hardware Kit HK-451
3.1	3	M8-1.25 X 20 HEX BOLT FLANGE GR8.8 ZINC
3.2	4	3/8"-16 X 2.50 CARRIAGE BOLT GR5 ZINC
3.3	4	3/8"-16 HEX NUT FLANGE NYLOCK GR5 ZINC



INSTALLATION INSTRUCTIONS

Note: Ensure all necessary hardware is included in the package before beginning installation. Carefully read and fully understand the instructions before proceeding..

1. During installation, leave all hardware hand-tight until the manual instructs you to fully tighten. Tightening hardware too early may cause alignment issues.
2. Locate the four small pilot holes on the front lower bumper of the vehicle as noted at locations (B) in **Figures 1 & 2**. You need to drill these holes out to allow for hardware installation.
3. Using a **7/16"** drill bit, drill out the four holes at locations **(B)** thru the front wall of the bumper tubes. (See **Figure 1 & 2**)
4. Position the Plow Mount plate against the front bumper as shown in **Figure 3 & 4**, and temporarily hold it in place. Assemble to the vehicle shown in **Figure 4**. Use bolts **(3.2)** through holes at locations **(B)**. Place a Backer Plate **(2)** over the bolts (see **Figure 3**) and sandwich the tube by loosely installing four nuts **(3.3)** as shown in **Figure 3**. Work one side at a time. Repeat opposite side.
5. From the front of the vehicle install the 3 bolts **(3.1)** as shown in **Figure 4**. Start bolts by hand.
6. Finally, evenly tighten all hardware to complete installation.

Figure 1

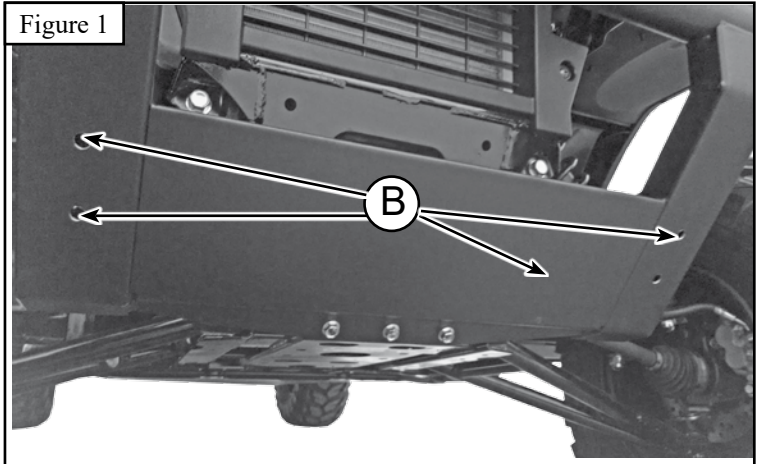

Figure 2

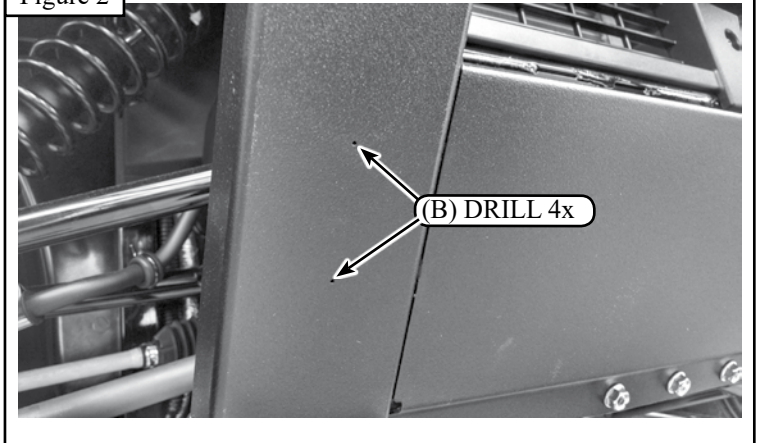

Figure 3

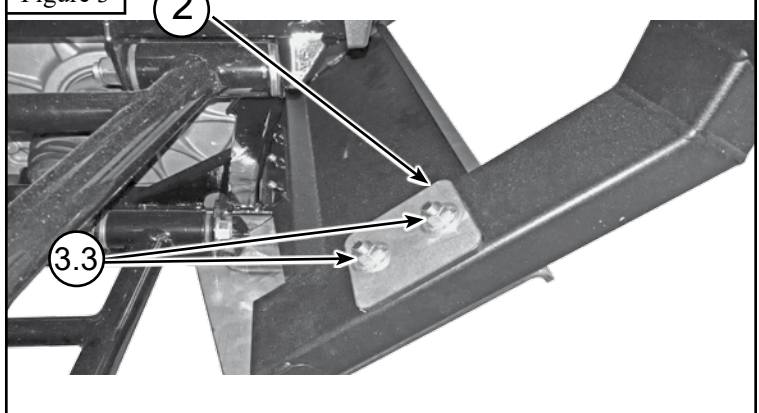

Figure 4

