

WOODCRAFT CFMOTORSPORTS

105 Baldwinville Rd. Winchendon, MA 01475

(978) 297-2977

www.woodcraft-cfm.com

05-0459B Yamaha R9Rearset Instruction Sheet – Racing Use Only

Thank you for selecting CFMOTORSPORTS rearsets. Please note that these components are intended and approved for **racing use only**. As such, the footpegs are solid-mount and provisions for brake light switches are generally not provided with the kit.

- 1) Remove stock rearsets, footpegs and associated hardware. All components that are re-used in this kit should be cleaned and inspected for damage before re-installation.

IMPORTANT

Tighten all fasteners to factory specification or industry standard. FAILURE TO PROPERLY TIGHTEN ALL FASTENERS MAY CAUSE DAMAGE TO THE MOTORCYCLE, LOSS OF CONTROL AND SERIOUS INJURY OR DEATH

Shift Side Assembly Installation

- 1) **IMPORTANT** - Secure all bolts with BLUE LOCTITE.
- 2) Test the footpeg in several positions and select the bolt hole and eccentric position that gives you the height you want. Once selected, bolt the footpeg to the bracket for final assembly using the included 10mm hardware.
- 3) Assemble the main shaft to the 08-0459P shift pivot. Attach the pedal to the OEM shifter location using the OEM shifter mounting hardware. Be sure to apply quality waterproof grease to the sliding surface of the pin, and maintain this grease throughout the season.
- 4) You will use the complete OEM shift rod assembly and bolt it to with the OEM hardware to the 08-0459P as seen below. Note the position at the bottom for both standard and GP shift.
- 5) Adjust the pedal to the desired height using a combination of the shift rod and the eccentric 7099E plate. Be sure to lock the shift rod in place with the shift rod free-flow nuts.
- 6) Bolt the main shift bracket assembly to the frame using the OEM hardware.

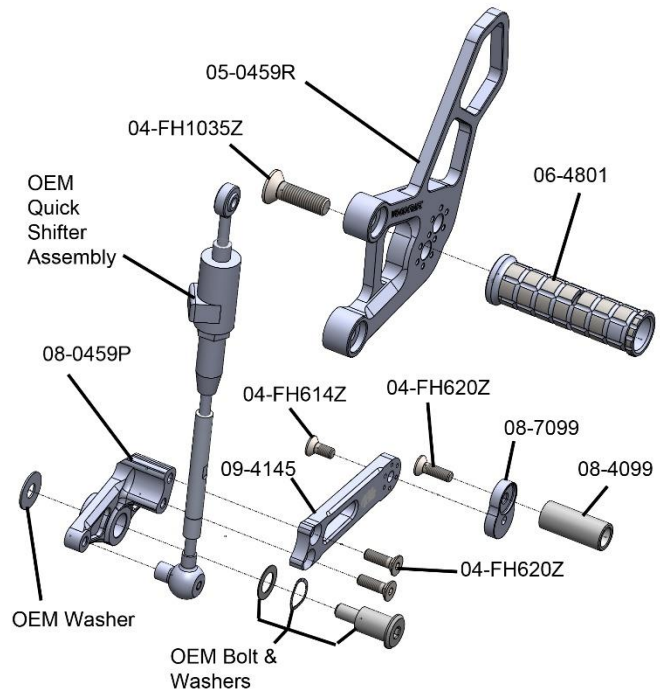

You will mount the shift rod to the 08-0459P pivot as shown for either STD or GP shift.

Standard Shift

GP Shift



Brake Side Assembly Installation

- 1) **IMPORTANT** - Secure all bolts with **BLUE LOCTITE**
- 2) Bolt the CFM footpeg to the bracket using the included 10mm hardware in the same position selected on the shift side.
- 3) Assemble the main shaft to the brake pedal. Be sure to apply quality waterproof grease to the surface of the 05-0419P brake pin and insert this pin and wave washer into the 09-0419P brake pivot as shown.
- 4) Attach the 05-0419P brake pin using the included 8mm button head bolt to the back of the bracket.
- 5) Attach the master cylinder to the brake pedal using the stock hardware. Connect the clevice to the back side of the brake pedal and adjust the brake pedal to your desired height using a combination of the eccentric offset plate and the OEM adjuster at the base of the master cylinder.
- 6) Optional: If you need the brake light to operate you can attach the OEM switch and bracket to the back side of the RH rearsset plate. You can then attach the spring to the arm on the brake pedal as shown. Be sure to check light operation and adjust the switch position as needed using the OEM nut.
- 7) Bolt the brake bracket assembly to the frame using the OEM hardware for final assembly.

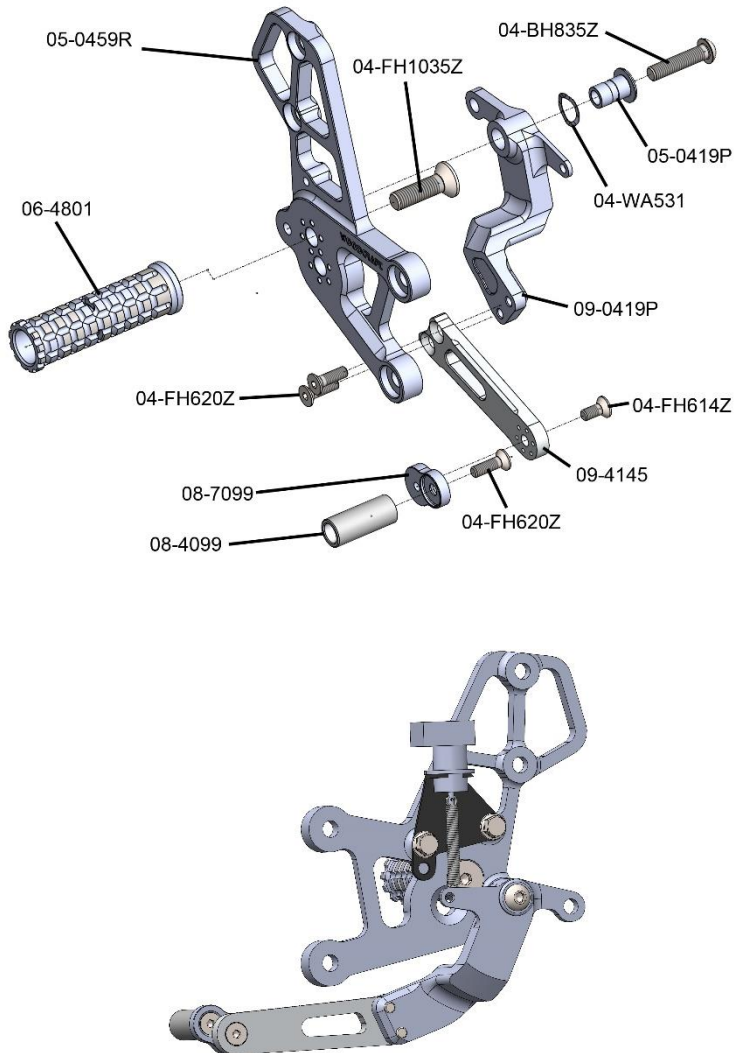

NOTE: If you want a brake pedal return spring (not required for racing applications) Woodcraft has one available. The model 09-7125 brake return spring assembly is recommended.

BE SURE THAT ALL COMPONENTS OPERATE AND RETURN FREELY BEFORE USE

If you have any questions regarding installation, please feel free to contact us.

IMPORTANT

Installation and use of this product will change the response of the motorcycle to rider control inputs. Failure of the rider to adapt to these changes may result in a loss of control, and serious injury or death. Improper installation and/or failure to comply with all warnings and instructions may cause a loss of control and serious injury or death. **DO NOT INSTALL OR USE THIS PRODUCT IF YOU ARE UNABLE TO DO SO IN COMPLIANCE WITH ALL INSTRUCTIONS AND WARNINGS. SEEK THE ASSISTANCE OF A TRAINED PROFESSIONAL TECHNICIAN.** Installation of this product releases the Woodcraft Technologies, Inc. from all liabilities as to the use of this product. The user recognizes that any alteration or modification to any motorcycle may increase the risk of injury or accident and may also render the motorcycle illegal for public road use