



SN. . . . .

# Dr. Jekyll & Mr. Hyde®

## THE EXHAUST

MANUAL : HARLEY-DAVIDSON® | USA

**NEW IN THIS MANUAL:**  
**- HAND ADJUSTABLE VALVE**



**Touring**  
**2017 ->**

**REQUIRED TOOLS:**

- RATCHET (S/M)
- TORX SOCKET, SIZE 20
- SOCKET, METRIC SIZE 13
- TORX SOCKET, SIZE 27
- SOCKET, METRIC SIZE 15
- WRENCH METRIC SIZE 8
- 1/2" SOCKET
- WRENCH METRIC SIZE 10
- TORQUE WRENCH

1

# Touring 2017 -> USA

## Assembly kit

- B1 4x
- W1 4x
- SW1 4x
- W2 1x
- SP1 4x
- BR1 2x
- TR 16x
- SC 1x

## Hand adjuster

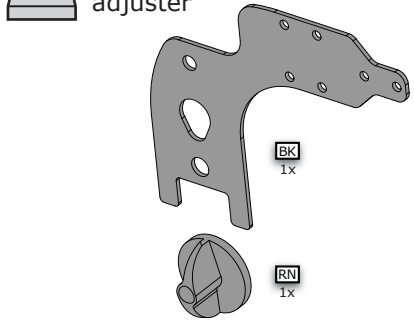

BK 1x

RN 1x

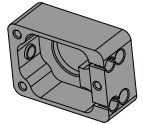

RH 1x

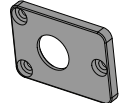

HL 1x



AX 1x

B2 6x

B3 1x

W3 3x

W4 1x

## Exhausts

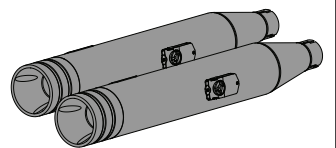

2

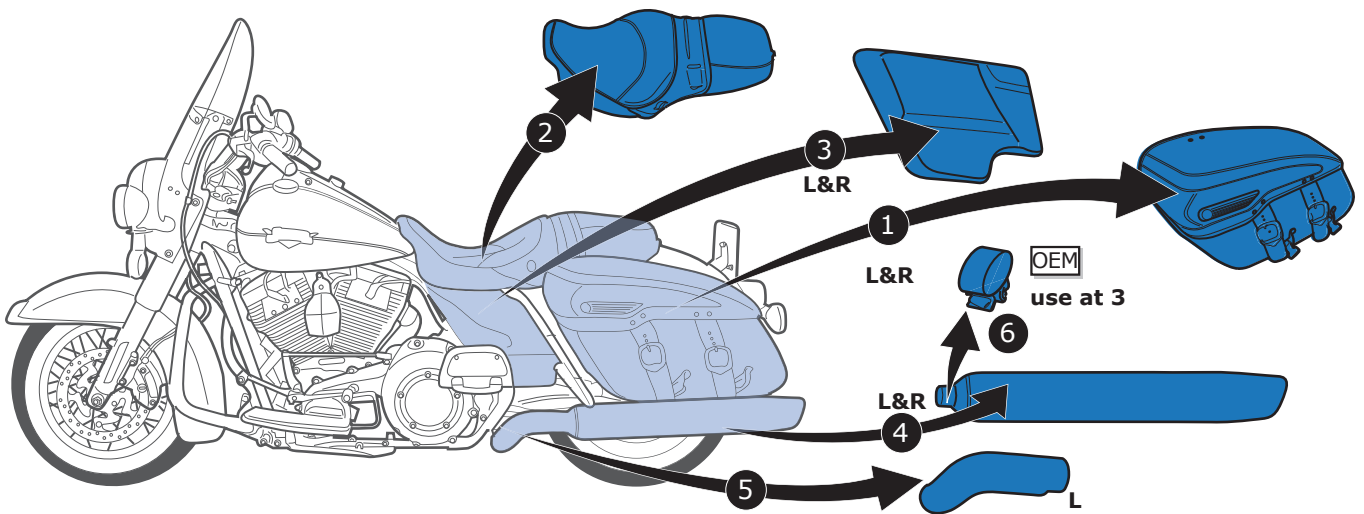

OEM components vary per touring model ⚠

3

## Install left & right exhaust

- SP1 4x
- B1 4x
- SW1 4x
- W1 4x
- BR1 2x
- TR 6x

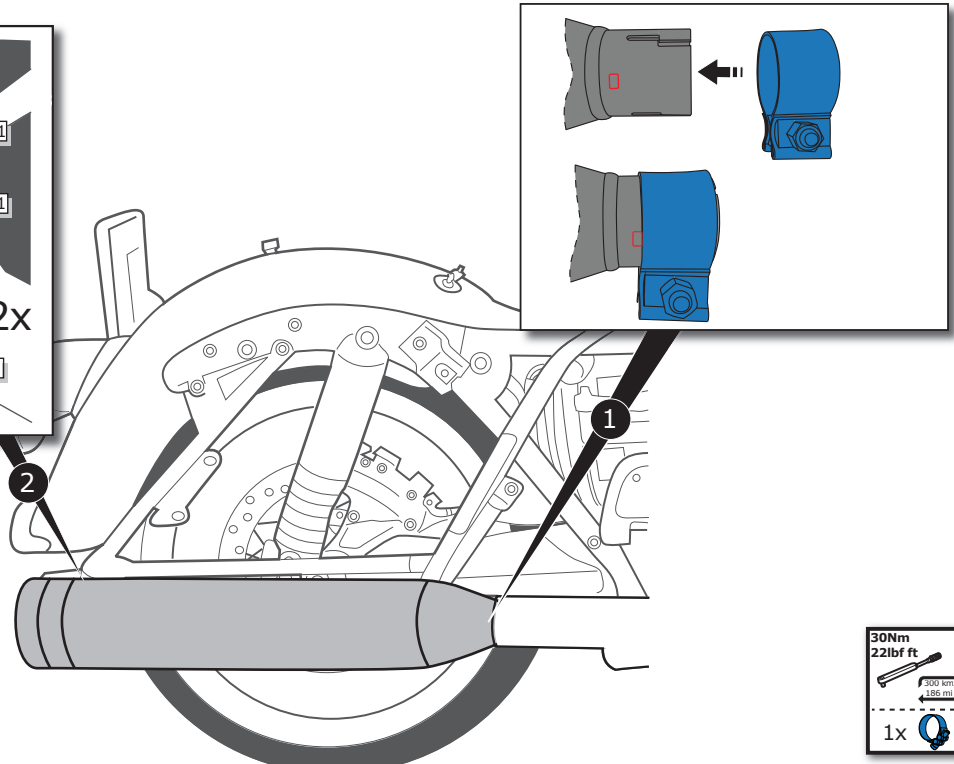
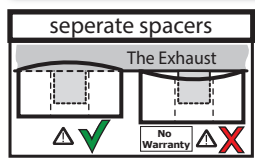
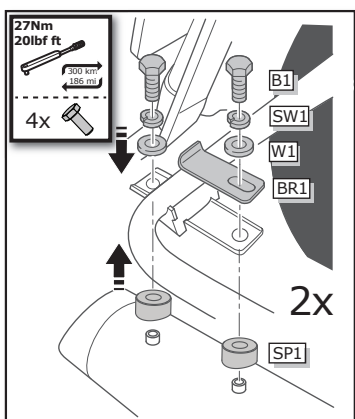

4

### Cable routing right hand side

|||||| = J&H cable is behind an OEM part

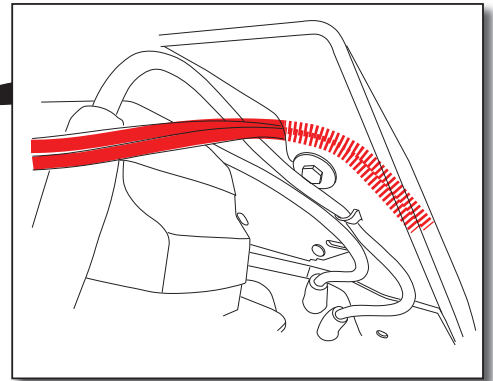
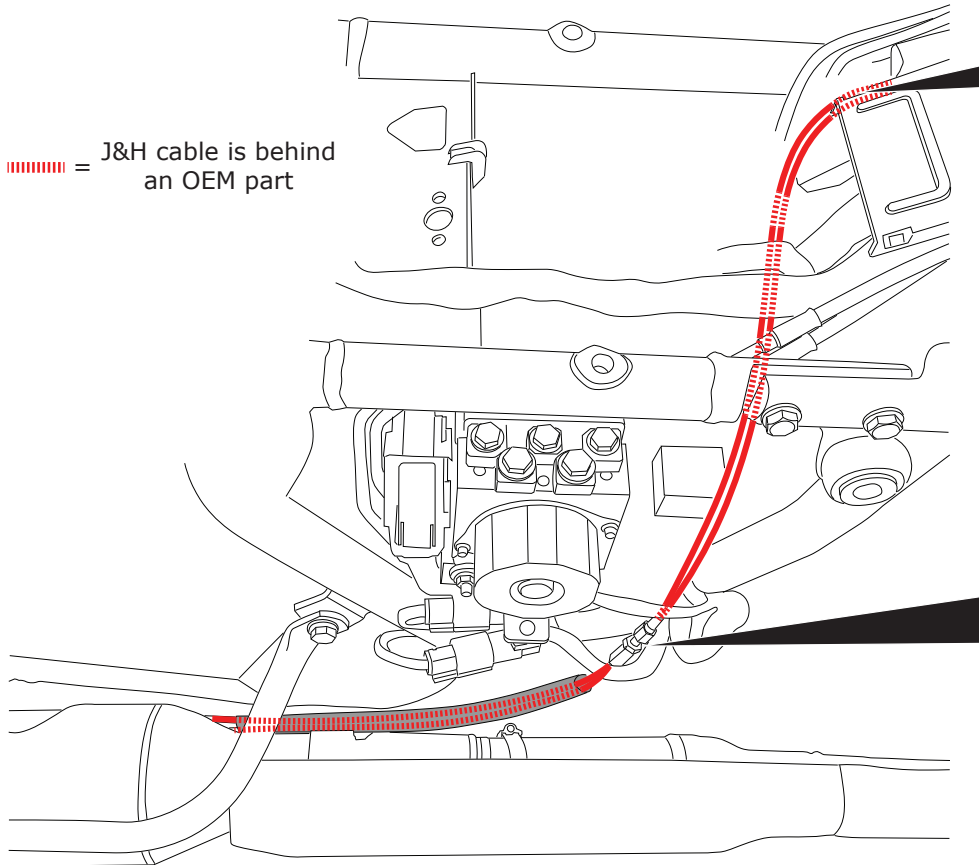

Check if the cable tension adjuster is twisted in fully

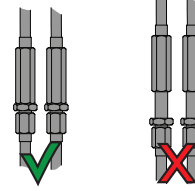

Adjust if necessary

5

### Cable routing left hand side

|||||| = J&H cable is behind an OEM part

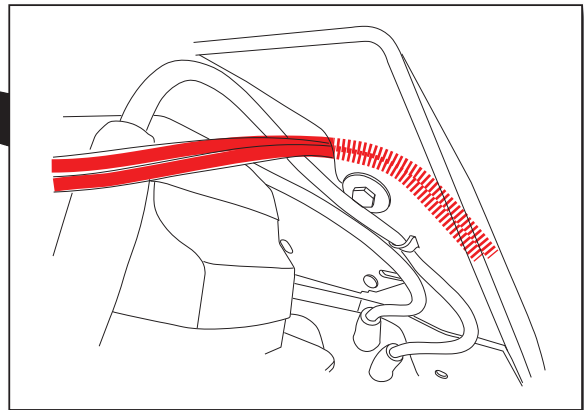
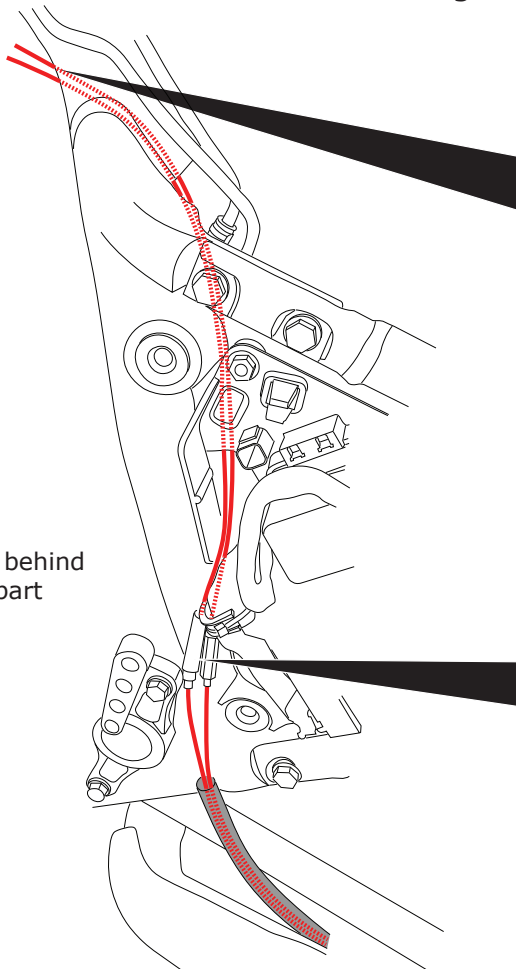

Check if the cable tension adjuster is twisted in fully

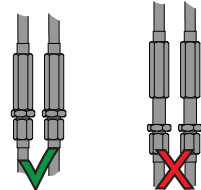

Adjust if necessary

# Rotary knob installation (1/2)



Scan the QR code to watch a video on how to install the rotary knob and cable tension adjustments

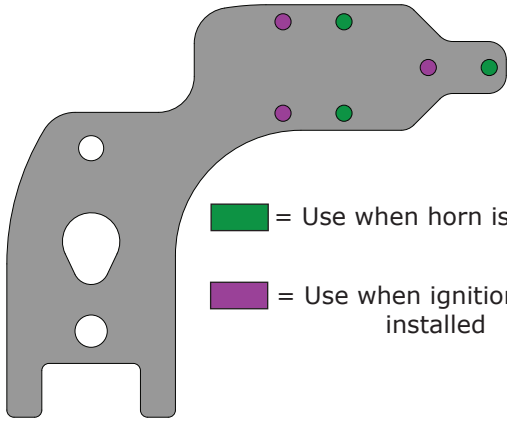

**Green** = Use when horn is installed

**Purple** = Use when ignition coil is installed

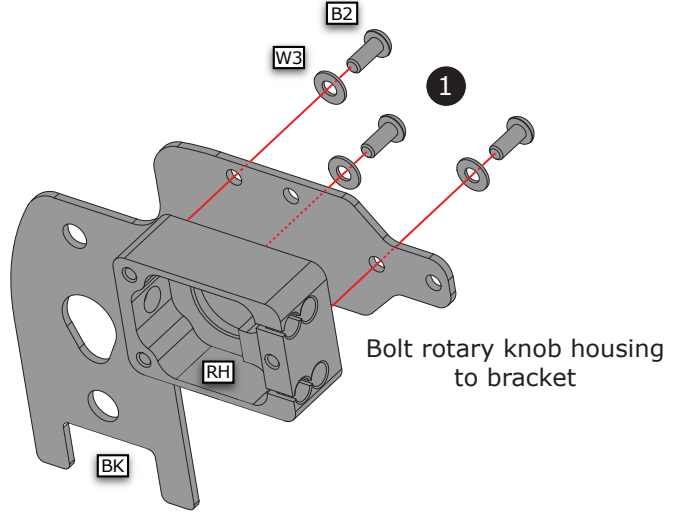

Bolt rotary knob housing to bracket

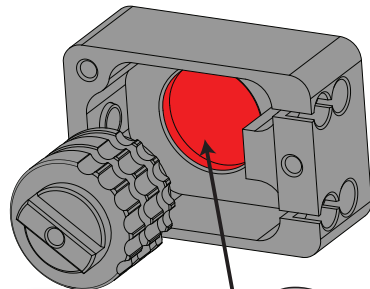

**2** Apply a small amount of grease to the area shown in red

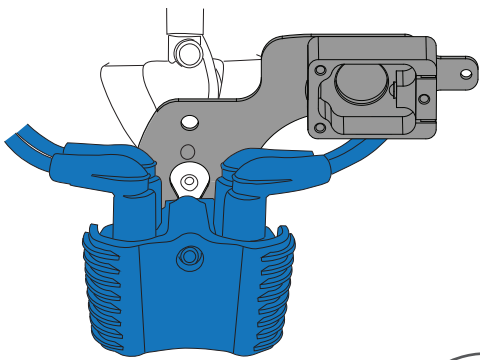
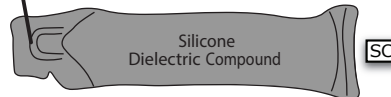

Option A

Attach bracket to motorcycle

**3**

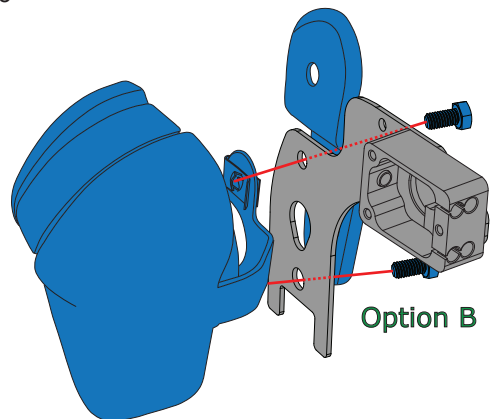
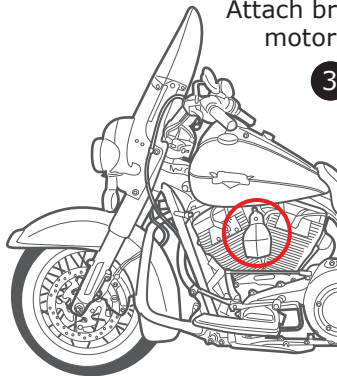

Option B

Rotary knob installation (2/2)

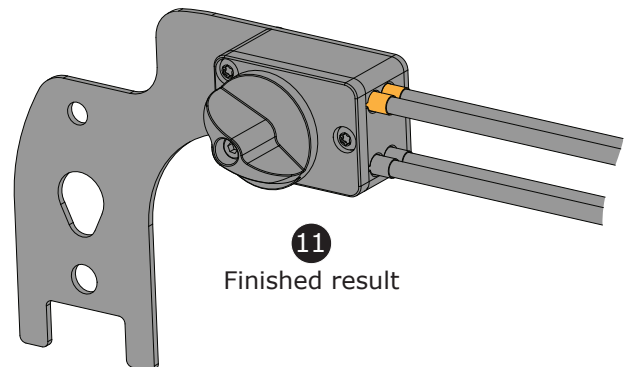
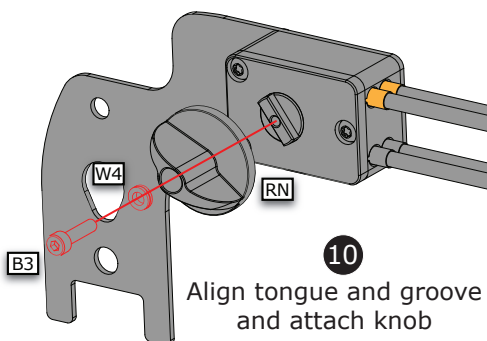
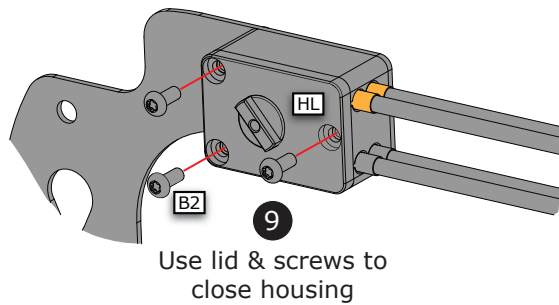
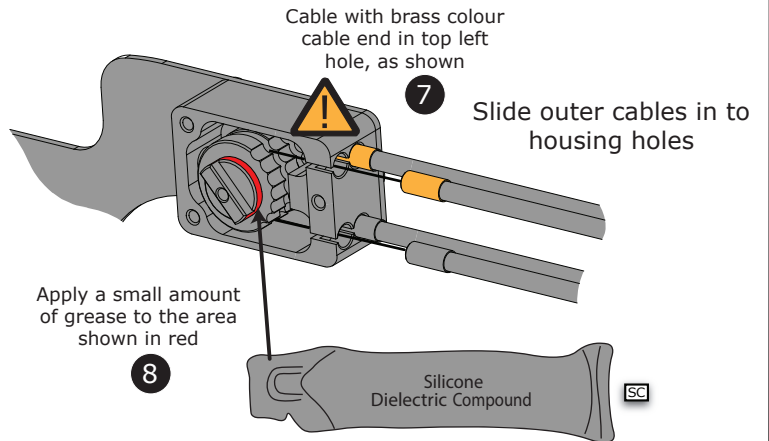
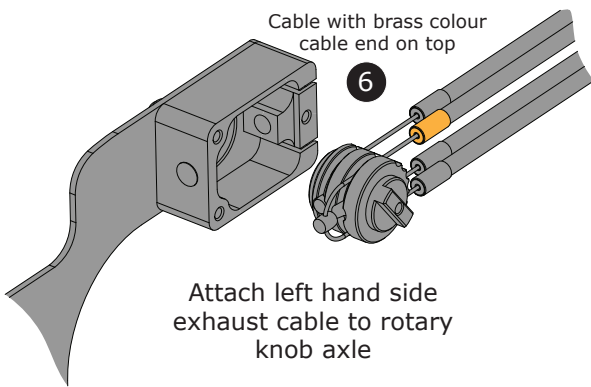
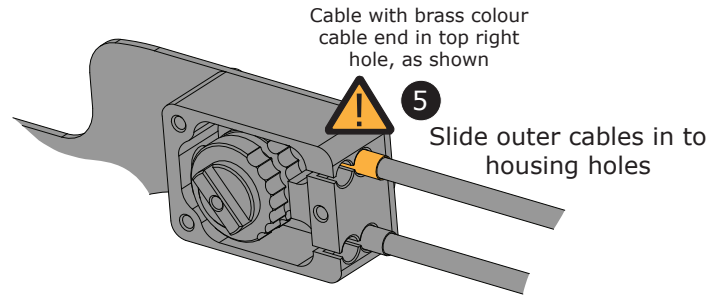
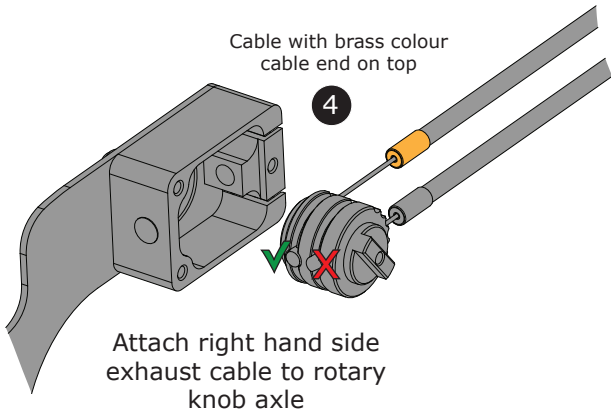

### Cable tension adjustment

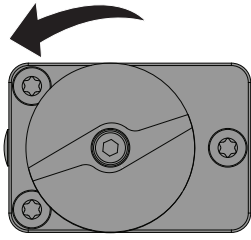

Turn knob to "open" position

1

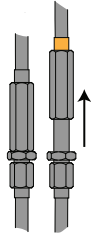

Adjust play in cable with brass cable end to approx 1mm (1/32")

2

Apply step 2 & 3 to right & left exhaust

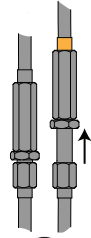

Hand tighten jam nut

3

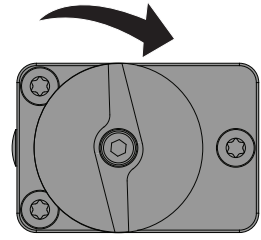

Turn knob to "closed" position

4

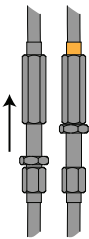

Adjust play in cable with chrome cable end to approx 1mm (1/32")

5

Apply step 5 & 6 to right & left exhaust

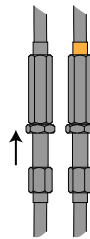

Hand tighten jam nut

6

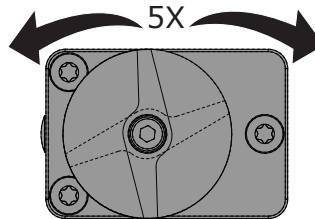

Open & close valves 5 times

7

8

Repeat steps



9  
Tighten all 4 jam nuts



Tension too high = valve doesn't rotate  
Tension too low = rattling valve  
Adjust if necessary



perform a **Complete System Check!**

