



## Zero Offset Clipon Installation Instructions

**WARNING** Installation and use of some Woodcraft Technologies, Inc. products will change the response of the motorcycle to rider control inputs. Failure of the rider to adapt to these changes may cause loss of control, and serious injury or death. Improper installation, and/or failure to comply with all warnings and instructions may cause loss of control and serious injury or death. **DO NOT INSTALL OR USE ANY WOODCRAFT TECHNOLOGIES, INC. PRODUCTS IF YOU ARE UNABLE TO DO SO IN COMPLIANCE WITH ALL INSTRUCTIONS AND WARNINGS. SEEK THE ASSISTANCE OF AN EXPERIENCED TECHNICIAN.**

- 1) Completely remove your stock grips, controls and clipon assembly.
- 2) Most OEM controls have anti rotation pins, which require you to drill holes in the Woodcraft handlebars. Measure the diameter of the holes in the stock handlebars and select the appropriate drill bit. Start with the grips/throttle and work from the outside in when lining up your controls.
- 3) Slide the controls loosely into place, noting that the grips should end roughly where the plastic end plug meets the aluminum. Mark the location for the anti rotation pins and drill. Test the control assemblies to be sure that they can be securely tightened and that everything moves freely. The grip should be set up so that the plastic bar end is completely visible.
- 4) Install the four 6x20mm socket cap clamping bolts on each clipon and secure the main clipon body on the fork tube, finger tight.
  - a. There is an optional reservoir mount included in your set that is designed to be pinched between the halves of the clipon on the far side of the RH clamp. If you are using this part (which is meant to be bent if needed) then fully torque the two bolts on that half of the clamp.

The right clipon has a “W” on the right side of the clamp and may use the optional reservoir mount

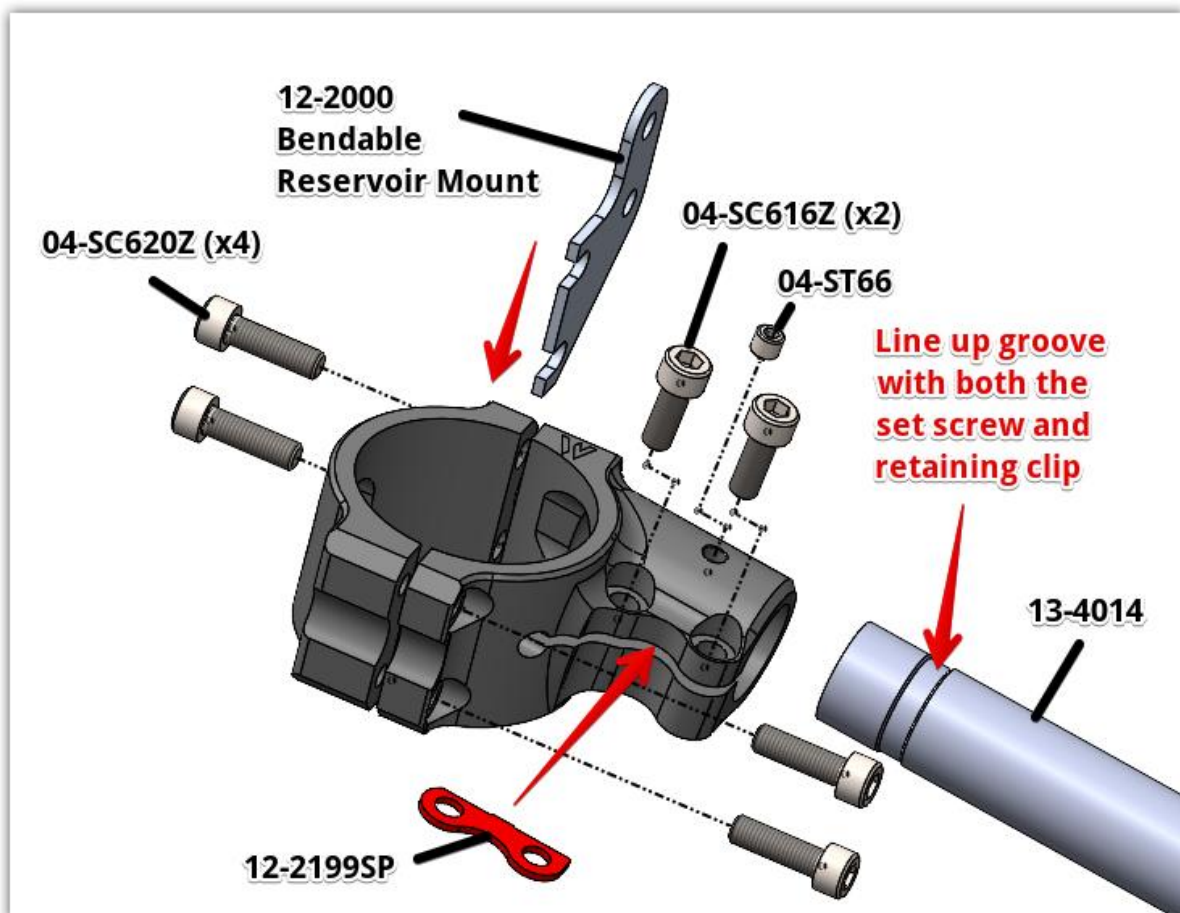

- 5) Install the 13-4104 handlebar into the clipon body. Insert the 12-2199 retention clip into the opening in the clamp as shown at the right. This bar has a special groove that must be centered on the small protrusion on the retention spacer. With this groove lined up, insert and fully torque the two 6x16mm socket cap bolts (appx 10 ft-lbs) to secure the bar in place.
- 6) Coat the 04-ST66 6mm set screw with Blue Loctite and tighten it into the groove of the handlebar. This acts as a secondary securing mechanism for the handlebar and must be used for all handlebar installations.

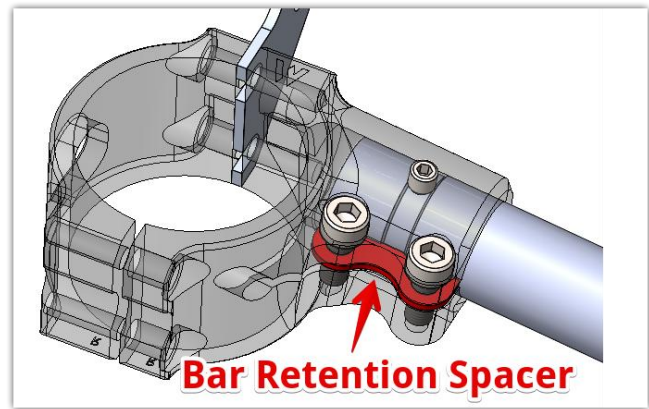

**CRITICAL IMPORTANCE:** The replacement handlebars (part number 13-4104) for this kit have a groove for the set screw and retention spacer to engage. DO NOT USE THIS CLIPON ASSEMBLY without all of these components. A handlebar without a groove for these two retention components will not work. Failure to heed this warning could result in serious injury or death.

- 7) Set the pullback of the bars to a comfortable position and then snug them in place. Rotate the handlebars from lock to lock in both directions and ensure there is adequate clearance for all parts including bars, levers, cables and your hands.

**NOTE:** These are not model specific clipons, they are universal parts and every installation is unique. You must check very carefully for adequate clearance and that the throttle snaps shut for all parts throughout the entire range of steering. Also, you must fully extend the forks and be sure that the brake lines never get pulled tight.

**WARNING - VERY IMPORTANT** : Ensure that the cables, hoses and all control parts do not contact any part of the motorcycle and that you have full ability to manipulate the controls throughout the entire range of steering. Also, be sure that the throttle returns freely after being fully opened throughout the entire range of steering. **FAILURE TO HEED THESE WARNINGS MAY CAUSE LOSS OF CONTROL OF MOTORCYCLE AND SERIOUS INJURY OR DEATH. DO NOT OPERATE THE MOTORCYCLE IF THERE ARE ANY INTERFERENCE ISSUES WITH EITHER THE MOTORCYCLE PARTS OR YOUR BODY, OR WITH A THROTTLE THAT DOES NOT RETURN FREELY.**

- 7) Once you have set the position of the handlebars, fully tighten the pinch bolt for the bars with a hand 90-degree allen wrench.
- 8) Before fully tightening the four mounting bolts, you should finger tighten the bolts so that the gap between the two halves of the clipon base is even on both sides. (This step is not needed on the right side clipon when using the 12-2000 mount). Next, snug all four bolts by hand with a 90 degree allen wrench. Next, fully tighten\* the two forward bolts. Then, fully tighten the two rear bolts. Perform a final check on all four bolts, ensuring that they are all equally and fully tight.

**IMPORTANT** : After tightening all fasteners according to instructions and to industry-standard\* torque specs, attempt to force each unit to slip on fork tube. **ANY ABILITY OF A CLIP-ON TO SLIP CAN CAUSE LOSS OF CONTROL AND SERIOUS INJURY OR DEATH. NEVER OPERATE MOTORCYCLE WITH A SLIPPING CLIP-ON.**