



YOSHIMURA

RESEARCH&DEVELOPMENT OF AMERICA,

5420 DANIELS STREET STE A, CHINO CA., 91710 · (800) 634-9166 · (909) 628-4722 · FAX (909) 591-2198

www.yoshimura-rd.com

MICRO TURN SIGNAL ADAPTER PLATES

Suzuki GSX-S750 074BG118010

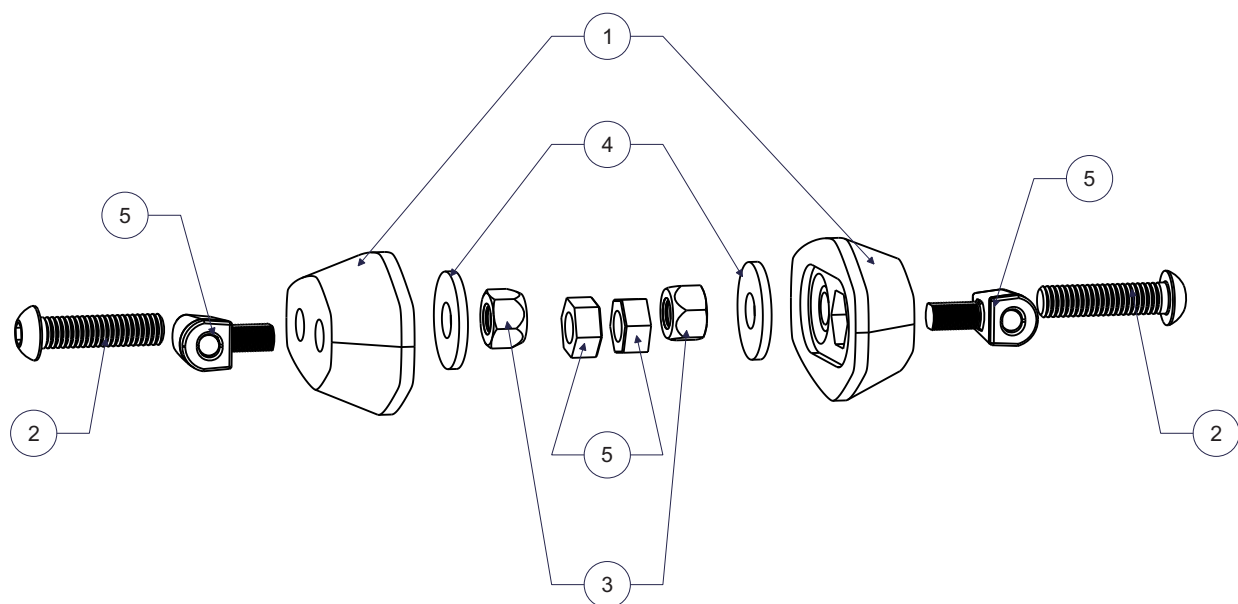

No.	Item	Description	Qty.
1	074BG118010-B	Front Turn Signal Plate	2
2	M6X25BHS	6mm x 25mm Button Head Cap Screw	2
3	6MMLN	M6 X 1.0 Nylon Lock Nut	2
4	6MMWASHERL	6mm Flat Washer - Large	2
5	072BGMICRTSR	Micro LED Turn Signal Kit	1

Removal

1. Follow steps in factory service / owners manual to remove meter cover and headlight assembly.



2. Locate and disconnect left and right front turn signal connectors and remove turn signals.
3. Cut the stock turn signal wires 4" from the male connector, not the harness.

Installation

1. Place the micro turn signal in the front hole and plastic hex nut inside the pocket of 074BG118010-B, turn signal plate.

Note: Proper positioning of the micro turn signal in the adapter plate is dependent on the orientation of the plastic nut. If the turn signal is not facing forwards, rotate the plastic nut in the adapter plate pocket and try again until turn signal is facing forward.

2. Install turn signal plate onto the rear headlamp cover where the stock turn signal was removed. Secure using *M6X25BHS* screw, *6MMWASHERL* washer, and *6MMLN* locking nut.

Note: Make sure that *6MMWASHERL* goes on the BACKSIDE of the turn signal holder.



Rear of Bike

Front of Bike

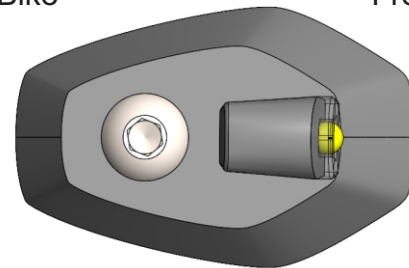

Right Side Example

3. Using the solder shrink connectors supplied in the micro turn signal kit, connect turn signal wires to micro light wires as follows:

Right:

Black and White - Black
Green - Blue

Left:

Black and White - Black
Black - Blue

- a) Strip the stock turn signal wire ends 1/4" - 1/2" and insert into *BN-SSS-22-18*, solder shrink connectors provided in the kit.
- b) Center the spliced wire ends in the middle and using a heat gun or lighter, apply heat evenly on the outer edges of the solder shrink connector to shrink and hold wires in place.
- c) Making sure that the stripped ends are centered, heat the center of the solder shrink connector evenly until the solder begins to liquify.
- d) Allow to cool completely and tug both ends of the wires to verify that connection is secured.

Scan the QR code below for link to solder shrink connector instruction video.



Scan QR code on the micro turn signal packaging for wiring diagram.

Note¹: The white running light wire and red brake light wire on the micro signals will not be used. Bundle back up and tuck away.

Note²: A red front light is prohibited in most states. Check with local laws and regulations prior to installation.

4. Repeat steps for opposite side.
5. Re-connect turn signal connectors, re-install the headlight, and re-install the meter cover using opposite steps of removal.

6. Check for proper function of turn signals and the headlight and that all components are secure prior to riding.