

WOODCRAFT CFMOTORSPORTS

105 Baldwinville Rd Winchendon, MA01475

(978)297-2977

www.woodcraft-cfm.com

05-0419B/-GP Yamaha MT-09 Rearset Instruction Sheet – Racing Use Only

Thank you for selecting CFMOTORSPORTS rearsets. Please note that these components are intended and approved for **racing use only**. As such, the footpegs are solid-mount and provisions for brake light switches are not provided with the kit.

- 1) Remove stock rearsets, footpegs and associated hardware. All components that are re-used in this kit should be cleaned and inspected for damage before re-installation.

IMPORTANT

Tighten all fasteners to factory specification or industry standard. FAILURE TO PROPERLY TIGHTEN ALL FASTENERS MAY CAUSE DAMAGE TO THE MOTORCYCLE, LOSS OF CONTROL AND SERIOUS INJURY OR DEATH

Shift Side Assembly Installation

- 1) Bolt the CFM footpeg to the bracket using the included 10mm hardware. **IMPORTANT** - Secure bolt with BLUE LOCTITE.
- 2) Assemble the main shaft to the CFM 08-0419P shift pivot. **IMPORTANT** - Secure all bolts with BLUE LOCTITE. Attach the pedal to the OEM shifter location using the OEM shifter mounting hardware. Be sure to apply quality waterproof grease to the surface of the pin.
- 3) For STANDARD SHIFT (Kit 05-0419B,BX), you will use the complete OEM shift rod assembly and bolt it with the supplied hardware to the 08-0419P as seen below.
- 4) For GP SHIFT (Kit 05-0419B-GP,BX-GP), you will replace the OEM shift rod with the supplied 07-2245 shift rod and bolt it with the supplied hardware to the 08-0419P as seen below.
- 5) Adjust the pedal to the desired height using a combination of the shift rod and the eccentric 7099E plate. Be sure to lock the shift rod in place with the shift rod free-flow nuts.
- 6) Bolt the shift bracket assembly to the frame using the OEM hardware.

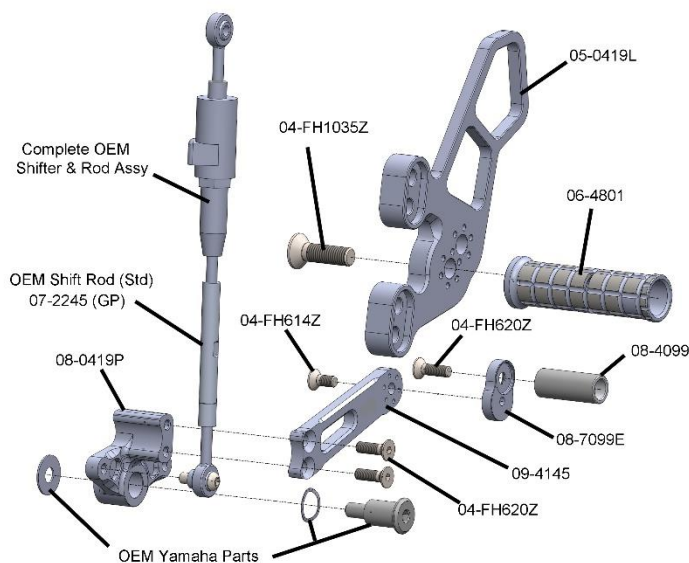

You will mount the shift rod to the 08-0419P pivot as shown below for either STD or GP shift.

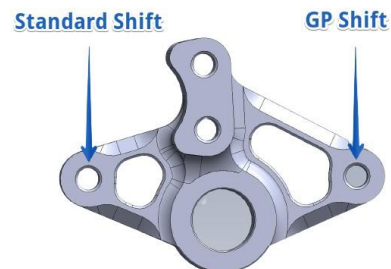

Brake Side Assembly Installation

- 1) Bolt the CFM footpeg to the bracket using the included 10mm hardware. **IMPORTANT** - Secure with BLUE LOCTITE after you have selected your final choice for position.
- 2) Assemble the main shaft to the CFM brake pedal. **IMPORTANT** - Secure all bolts with BLUE LOCTITE. Be sure to apply quality waterproof grease to the surface of the OEM brake pin inside the 09-0419P brake pivot.
- 3) Attach the OEM brake pin and hardware to the back of the bracket. **IMPORTANT** - Secure the bolt with BLUE LOCTITE.
- 4) Attach the master cylinder to the brake pedal using the stock hardware and adjust the brake pedal to your desired height using the eccentric offset plate and the OEM adjuster at the base of the master cylinder. **IMPORTANT** - Secure with BLUE LOCTITE after you have selected your final choice for position.
- 5) Optional: If you need the brake light to operate you can attach the OEM switch and bracket using the stock bolts to the back side of the bracket and attach the spring to the arm on the brake pedal. Be sure to check light operation and adjust the switch position as needed using the OEM nut.
- 6) Bolt the brake bracket assembly to the frame using the OEM hardware.

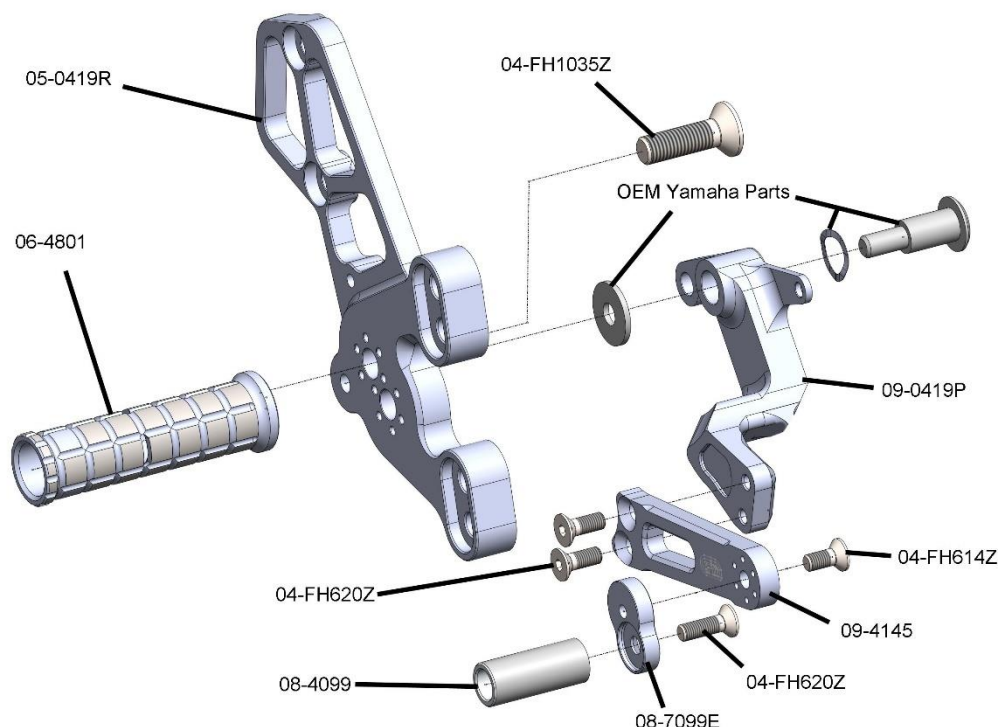

NOTE: If you want a brake pedal return spring (not required for racing applications) Woodcraft has one available. The model 09-7125 brake return spring assembly is recommended.

BE SURE THAT ALL COMPONENTS OPERATE AND RETURN FREELY BEFORE USE

If you have any questions regarding installation, please feel free to contact us.

IMPORTANT

Installation and use of this product will change the response of the motorcycle to rider control inputs. Failure of the rider to adapt to these changes may result in a loss of control, and serious injury or death. Improper installation and/or failure to comply with all warnings and instructions may cause a loss of control and serious injury or death. **DO NOT INSTALL OR USE THIS PRODUCT IF YOU ARE UNABLE TO DO SO IN COMPLIANCE WITH ALL INSTRUCTIONS AND WARNINGS. SEEK THE ASSISTANCE OF A TRAINED PROFESSIONAL TECHNICIAN.** Installation of this product releases the Woodcraft Technologies, Inc. from all liabilities as to the use of this product. The user recognizes that any alteration or modification to any motorcycle may increase the risk of injury or accident and may also render the motorcycle illegal for public road use.