

POWER COMMANDER 6

Install Guide for: PC6-16069

Model coverage: 2017-2020 Honda CRF250L

PARTS LIST



- | | | | |
|---|------------------------|---|---------------|
| 1 | POWER COMMANDER 6 | 2 | VELCRO STRIPS |
| 1 | INSTALLATION GUIDE | 1 | ALCOHOL SWAB |
| 1 | USB CABLE | 1 | POSI TAP |
| 2 | DYNOJET DECALS | 1 | EO LABEL |
| 2 | POWER COMMANDER DECALS | | |

**PLEASE READ ALL DIRECTIONS BEFORE STARTING INSTALLATION.
THE IGNITION MUST BE TURNED OFF BEFORE INSTALLATION.**



IPC6-16069.01



INPUT ACCESSORY GUIDE

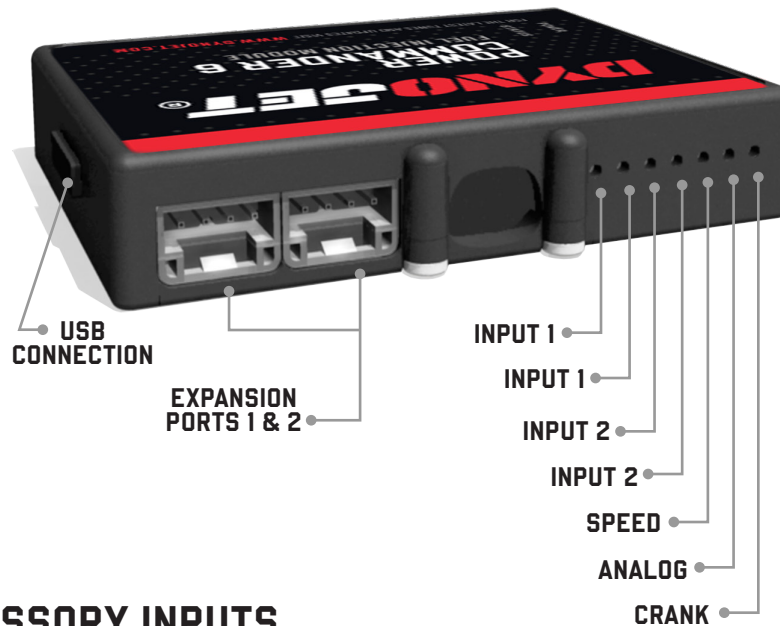

OPTIONAL ACCESSORY INPUTS

- Map** (Input 1 or 2) The PC6 has the ability to hold 2 different base maps. You can switch on the fly between these two base maps when you hook up a switch to the MAP inputs. You can use any open/close type switch. The polarity of the wires is not important.
- Shifter** (Input 1 or 2) Used for clutch-less full throttle upshifts. Insert the wires from the Dynojet quick shifter into either Input 1 or Input 2. The polarity of the wires is not important. Set to Input 2 by default.
- Speed** If your application has a speed sensor then you can tap into the signal side of the sensor and run a wire into this input. This will allow you to calculate gear position in the Control Center Software. Once gear position is setup you can alter your map based on gear position and setup gear dependent kill times when using a quickshifter. .
- Analog** This input is for a 0-5v signal such as engine temp, boost, etc. Once this input is established you can alter your fuel curve based on this input in the Power Core software.
- Launch** You can connect a wire to either Input 1 or Input 2 and then the other end to a switch. This switch when engaged (continuity) will only allow the RPM to be raised to a certain limit (set in the software). When released, you will have full RPM.

WIRE CONNECTIONS

To input wires into the PC6 first remove the rubber plug on the backside of the unit and loosen the screw for the corresponding input. Using a 22-24 gauge wire, strip about 10mm from its end. Push the wire into the hole of the PC6 until it stops and then tighten the screw. Make sure to reinstall the rubber plug.

NOTE: If you tin the wires with solder it will make inserting them easier.

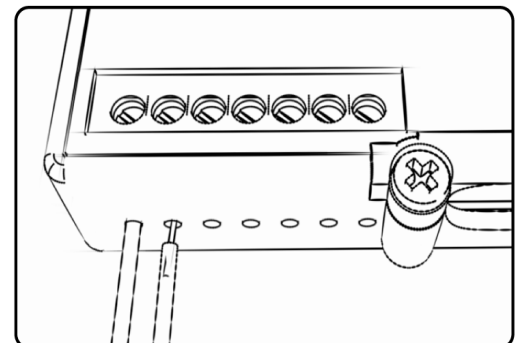

INSTALLING THE POWER COMMANDER 6



- 1 Remove the seat and remove the side covers on both sides of the bike.
- 2 Remove the fuel tank.

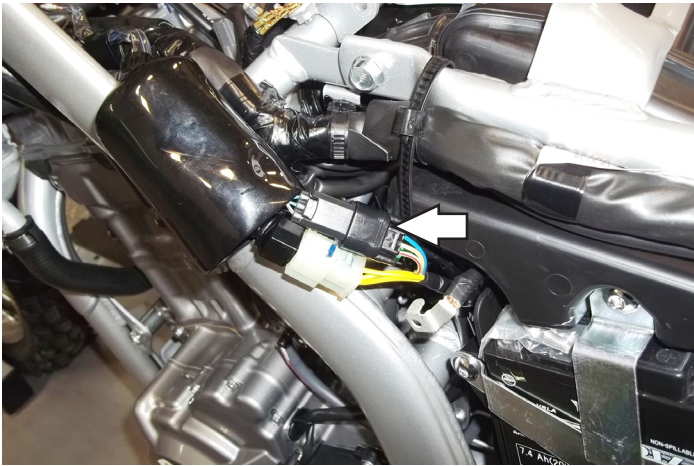

- 3 Unplug the stock Crank Position Sensor connectors.

This is a BLACK 3-pin connector pair. It is located inside of a black rubber boot on the left side of the bike near the battery.

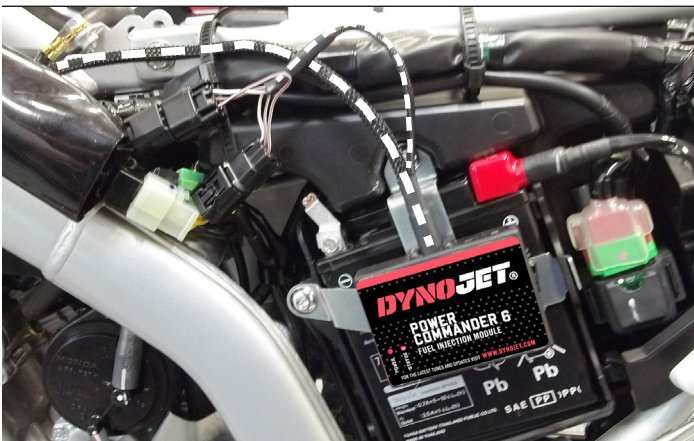

- 4 Use the supplied Velcro to secure the PC6 module to the battery bracket.

Clean surfaces with the supplied alcohol swab before attaching the Velcro.
- 5 Plug the PC6 wiring harness in-line of the stock Crank Position Sensor connectors.

Store the connectors back inside of the black rubber boot.

- 6 Unplug the Fuel Injector.

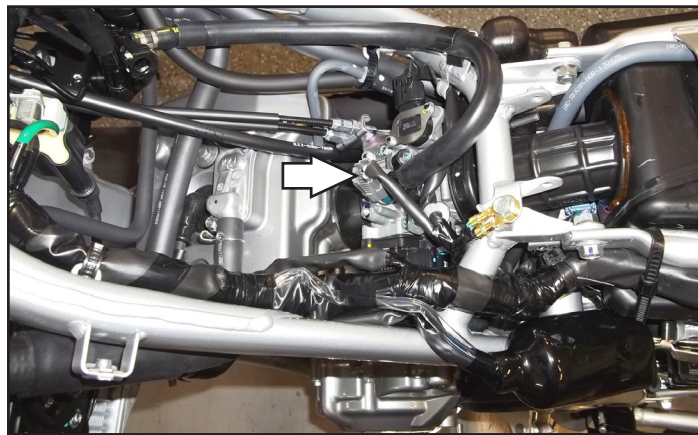

- 7 Plug the PC6 wiring harness in-line of the Fuel Injector and the stock wiring harness.
- 8 Secure the PC6 ground wire with the small ring terminal to the stock common ground bolt on the frame.

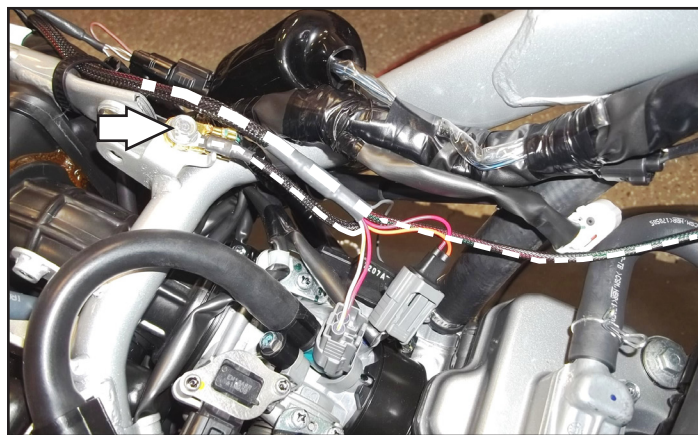

- 9 Unplug the stock connector from the TPS located on the left side of the throttle body.
- This connector is stored inside of a black rubber boot.



- 10 Use the supplied Posi-tap to attach the PC6 GREY wire to the stock YELLOW wire of the bike's TPS connector.
- 11 Plug the stock connector back on to the TPS. Put the black rubber boot back over the connector.

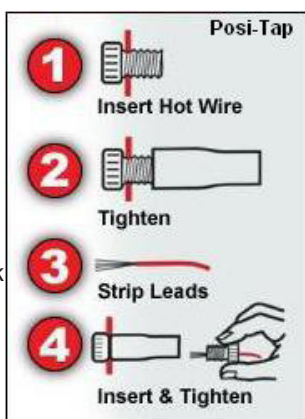

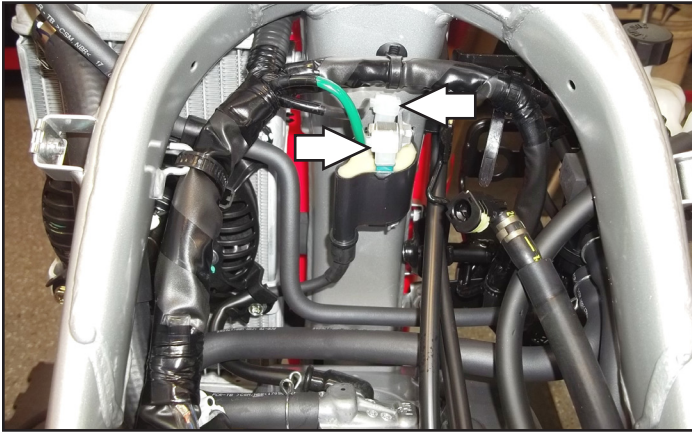

- 12 Unplug both of the stock wires from the Ignition Coil.
Unplug the stock GREEN wire from the GREEN tab.
Unplug the stock BLACK wire from the BLACK tab.

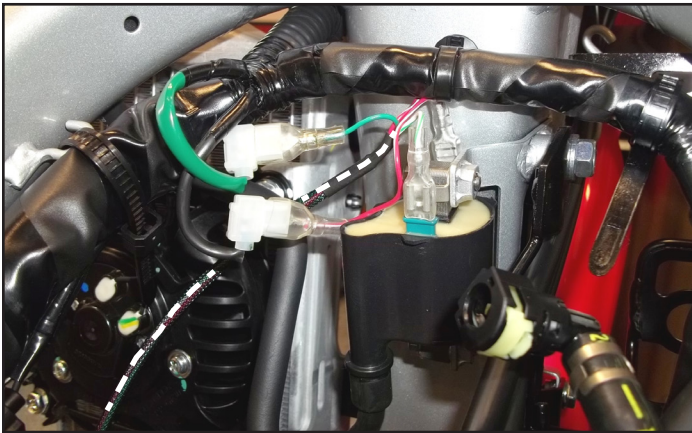

- 13 Plug the pair of spade connectors in the PC6 wiring harness with GREEN colored wires in-line of the stock GREEN wire and GREEN tab on the Ignition Coil.
- 14 Plug the pair of spade connectors in the PC6 wiring harness with RED colored wires in-line of the stock BLACK wire and the BLACK tab on the Ignition Coil.
- 15 Reinstall the fuel tank, bodywork, and the seat.
- 16 Affix the supplied CARB E.O. label to a conspicuous area. Next to the original emissions label is the preferred location. Make sure to clean the surface before attaching.

Download the latest map files from our web site at dynojet.com/tunes.



PUSH THE LIMIT

2191 MENDENHALL DRIVE, NORTH LAS VEGAS, NV 89081 - 800-992-4993 - [DYNOJET.COM](https://www.dynojet.com)
© 2017-2022 DYNOJET RESEARCH ALL RIGHTS RESERVED