

POWER COMMANDER 6

Installation Guide for: PC6-20061

Model Coverage: 2019-2022 Suzuki RMZ250

PARTS LIST

- | | | | |
|---|--------------------|---|------------------------|
| 1 | POWER COMMANDER 6 | 2 | POWER COMMANDER DECALS |
| 1 | INSTALLATION GUIDE | 2 | VELCRO STRIPS |
| 1 | USB CABLE | 1 | ALCOHOL SWAB |
| 2 | DYNOJET DECALS | 1 | POSI-TAP |

**PLEASE READ ALL DIRECTIONS BEFORE STARTING INSTALLATION.
THE IGNITION MUST BE TURNED OFF BEFORE INSTALLATION.**



INPUT ACCESSORY GUIDE

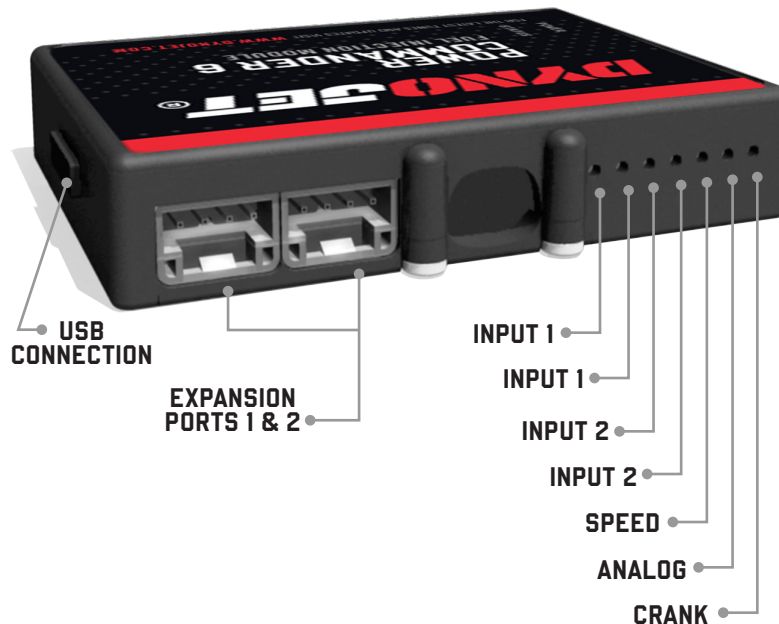

OPTIONAL ACCESSORY INPUTS

- Map** (Input 1 or 2) The PC6 has the ability to hold 2 different base maps. You can switch on the fly between these two base maps when you hook up a switch to the MAP inputs. You can use any open/close type switch. The polarity of the wires is not important.
- Shifter** (Input 1 or 2) Used for clutch-less full throttle upshifts. Insert the wires from the Dynojet quick shifter into either Input 1 or Input 2. The polarity of the wires is not important. Set to Input 2 by default.
- Speed** If your application has a speed sensor then you can tap into the signal side of the sensor and run a wire into this input. This will allow you to calculate gear position in the Control Center Software. Once gear position is setup you can alter your map based on gear position and setup gear dependent kill times when using a quick shifter.
- Analog** This input is for a 0-5v signal such as engine temp, boost, etc. Once this input is established you can alter your fuel curve based on this input in the Power Core software.
- Launch** You can connect a wire to either Input 1 or Input 2 and then the other end to a switch. This switch when engaged (continuity) will only allow the RPM to be raised to a certain limit (set in the software). When released, you will have full RPM.

WIRE CONNECTIONS

To input wires into the PC6 first remove the rubber plug on the backside of the unit and loosen the screw for the corresponding input. Using a 22-24 gauge wire, strip about 10mm from its end. Push the wire into the hole of the PC6 until it stops and then tighten the screw. Make sure to reinstall the rubber plug.

NOTE: If you tin the wires with solder it will make inserting them easier.

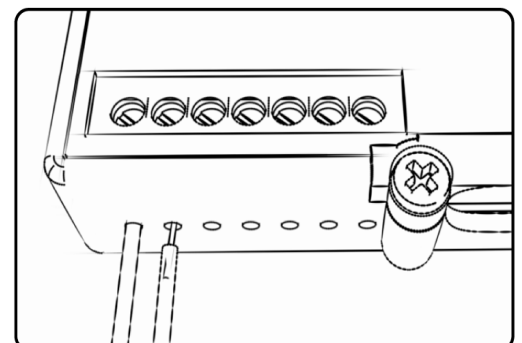

INSTALLING THE POWER COMMANDER 6



- 1 Remove the seat, the radiator shrouds, and the fuel tank.
- 2 Secure the PC6 module to the outside of the right side frame rail just rear of the radiator.

Use the supplied dual lock Velcro to secure the module. Clean surfaces with the alcohol swab before attaching the Velcro.

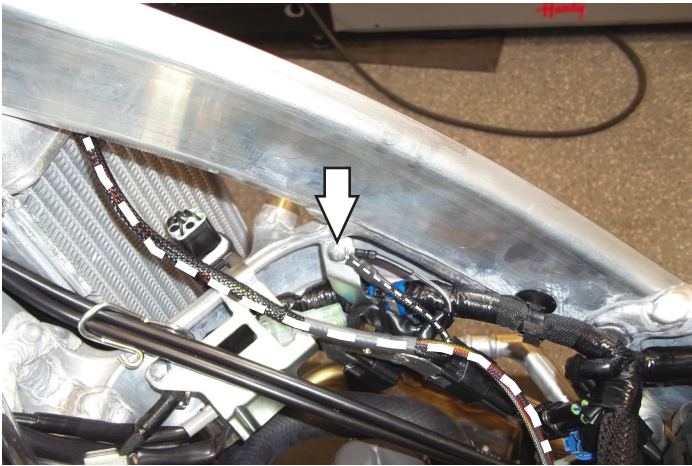

- 3 Secure the PC6 ground wire with the small ring terminal to the frame using the stock common ground bolt.



- 4 Locate and unplug the Primary Fuel Injector.
This injector is located on the bottom of the throttle body.

- 5 Plug the pair of PC6 wiring harness leads with ORANGE colored wires in-line of the primary injector and stock wiring harness.

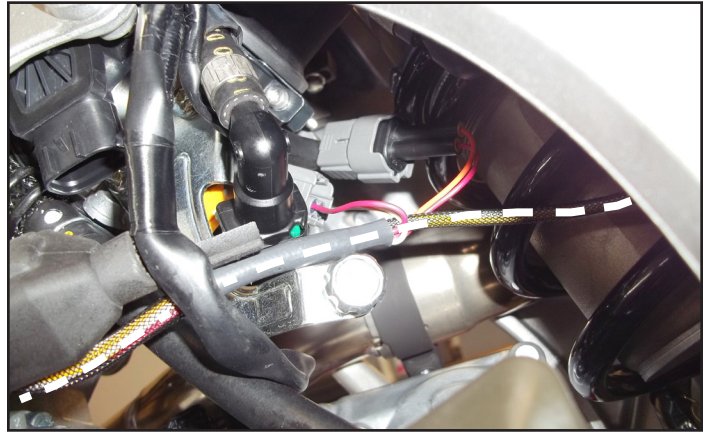

- 6 Locate and unplug the Secondary Fuel Injector.
This injector is located on the bottom of the intake plenum rear of the throttle body.



- 7 Plug the pair of PC6 wiring harness leads with YELLOW colored wires in-line of the secondary injector and stock wiring harness.

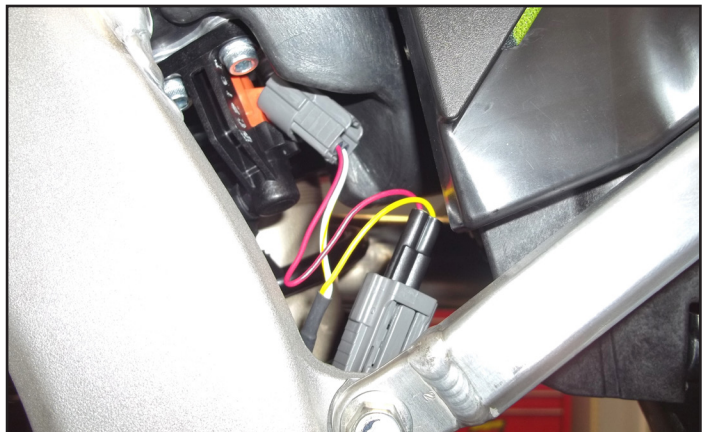

- 8 Pull back on the rubber boot covering the Throttle Position Sensor connector to expose the stock TPS wires.

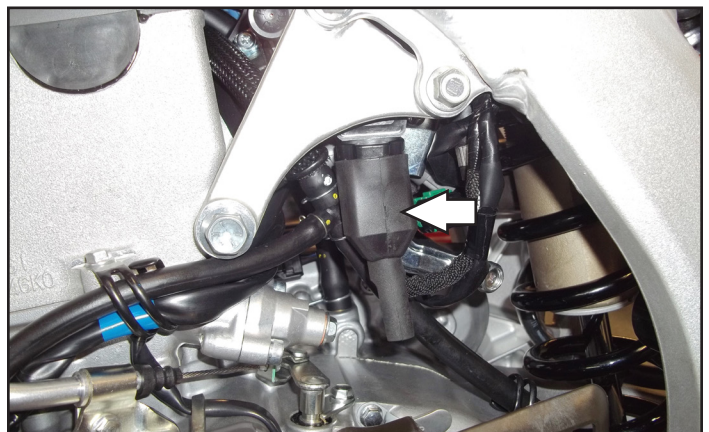

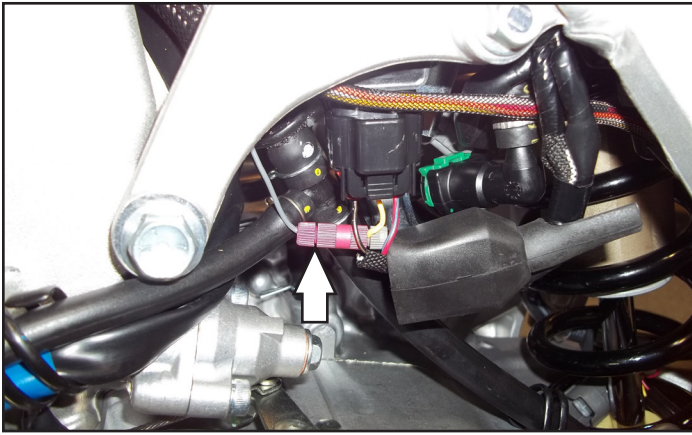

- 9 Use the supplied Positap to attach the PC6 GREY wire to the stock YELLOW wire of the bike's TPS.

Using a small dab of dielectric grease on this connection can help prevent corrosion.

- 10 Pull the stock rubber boot back over the connector to protect the wires.
- 11 Reinstall the fuel tank, bodywork, and the seat.

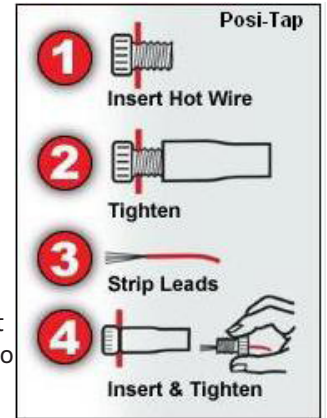

Download the latest map files from our web site at dynojet.com/tunes.



PUSH THE LIMIT

2191 MENDENHALL DRIVE, NORTH LAS VEGAS, NV 89081 - 800-992-4993 - [DYNOJET.COM](https://www.dynojet.com)
© 2019-2022 DYNOJET RESEARCH ALL RIGHTS RESERVED