

POWER COMMANDER 6

Installation Guide for: PC6-17084

Model Coverage: 2020-2022 Kawasaki KLX230/R

PARTS LIST



- | | | | |
|---|--------------------|---|------------------------|
| 1 | POWER COMMANDER 6 | 2 | POWER COMMANDER DECALS |
| 1 | INSTALLATION GUIDE | 2 | VELCRO STRIPS |
| 1 | USB CABLE | 1 | ALCOHOL SWAB |
| 2 | DYNOJET DECALS | 1 | POSI-TAP |

**PLEASE READ ALL DIRECTIONS BEFORE STARTING INSTALLATION.
THE IGNITION MUST BE TURNED OFF BEFORE INSTALLATION.**



IPC6-17084.01



INPUT ACCESSORY GUIDE

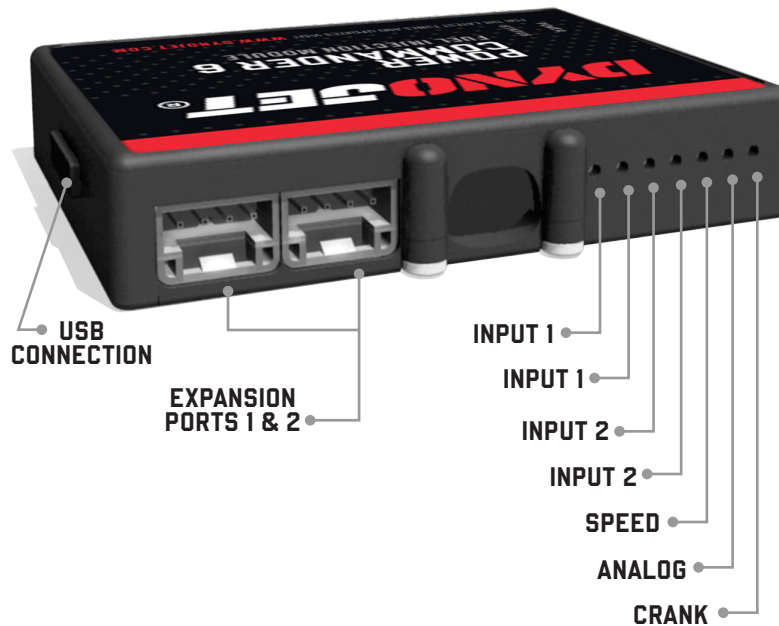

OPTIONAL ACCESSORY INPUTS

- Map** (Input 1 or 2) The PC6 has the ability to hold 2 different base maps. You can switch on the fly between these two base maps when you hook up a switch to the MAP inputs. You can use any open/close type switch. The polarity of the wires is not important.
- Shifter** (Input 1 or 2) Used for clutch-less full throttle upshifts. Insert the wires from the Dynojet quick shifter into either Input 1 or Input 2. The polarity of the wires is not important. Set to Input 2 by default.
- Speed** If your application has a speed sensor then you can tap into the signal side of the sensor and run a wire into this input. This will allow you to calculate gear position in the Control Center Software. Once gear position is setup you can alter your map based on gear position and setup gear dependent kill times when using a quick shifter.
- Analog** This input is for a 0-5v signal such as engine temp, boost, etc. Once this input is established you can alter your fuel curve based on this input in the Power Core software.
- Launch** You can connect a wire to either Input 1 or Input 2 and then the other end to a switch. This switch when engaged (continuity) will only allow the RPM to be raised to a certain limit (set in the software). When released, you will have full RPM.

WIRE CONNECTIONS

To input wires into the PC6 first remove the rubber plug on the backside of the unit and loosen the screw for the corresponding input. Using a 22-24 gauge wire, strip about 10mm from its end. Push the wire into the hole of the PC6 until it stops and then tighten the screw. Make sure to reinstall the rubber plug.

NOTE: If you tin the wires with solder it will make inserting them easier.

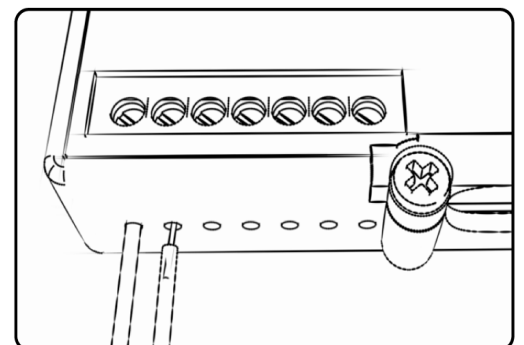

INSTALLING THE POWER COMMANDER 6

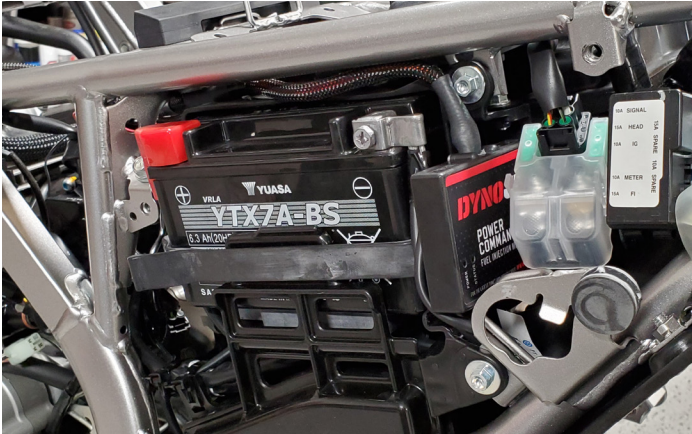

- 1 Remove the seat, side panels and fuel tank.
- 2 Secure the PC6 to the rear of the battery under the left hand side cover.
- 3 Route the PC6 harness along the frame tube going towards the engine.

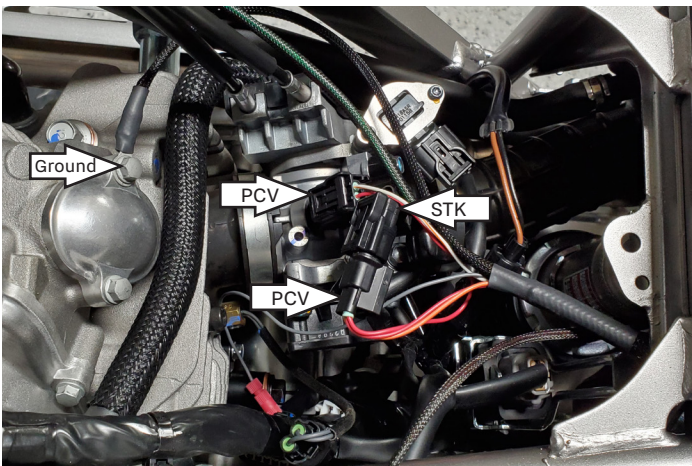

- 4 Unplug the stock wiring harness from the fuel injector and plug the PC6 in-line of the injector and wiring harness.

This connection is on the top side of the throttle body.

- 5 Attach the ground wire of the PC6 to the engine bolt on the backside of the valve cover.

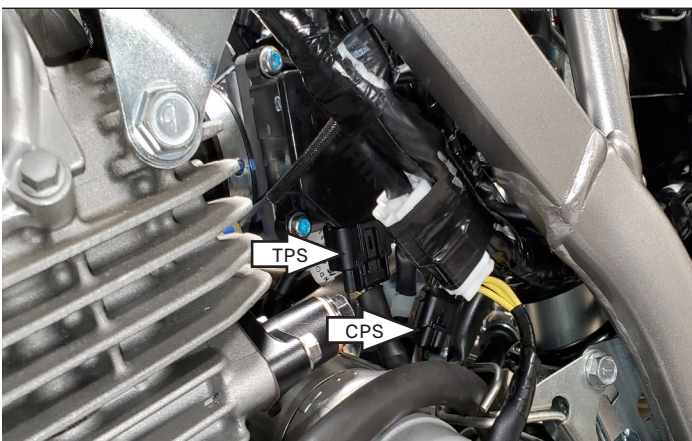

- 6 Disconnect the wiring harness from the Throttle Position Sensor to gain access to the connector.

This is a 5 pin connector on the bottom side of the throttle body.
- 7 Unplug the Crank Position Sensor connector.

This is a 4 pin, BLACK connector.

- 8 Use the supplied Posi-tap to attach the GREY wire from the PC6 to the stock wiring harness.

For KLX230 DUALSPORT:
YELLOW/WHT - #2

For KLX230R DIRTBIKE:
YELLOW/GRN - #1

- 9 Connect the wiring harness back onto the throttle body.

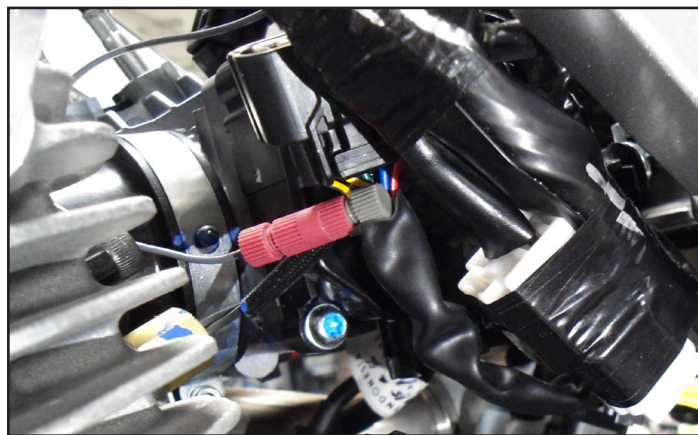
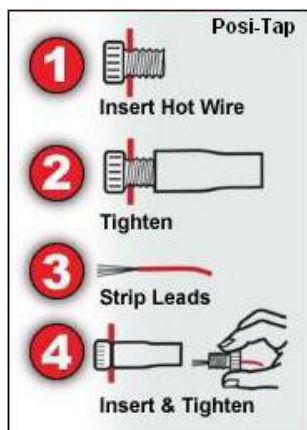

- 10 Plug the PC6 in-line of the stock wiring harness and Crank Position Sensor.

- 11 Route the PC6 harness over to the right side of the motorcycle.



- 12 Plug the PC6 in-line of the stock wiring harness and ignition coil.

PC6 GREEN wires go in-line of the signal of the coil.
The wires and coil have a GREEN marking.

PC6 RED wires go in-line of the 12v side of the coil.

- 13 Reinstall the fuel tank and bodywork.

Download the latest map files from our web site at
dynojet.com/tunes.





PUSH THE LIMIT

2191 MENDENHALL DRIVE, NORTH LAS VEGAS, NV 89081 - 800-992-4993 - [DYNOJET.COM](https://www.dynojet.com)
© 2020-2022 DYNOJET RESEARCH ALL RIGHTS RESERVED