

POWER COMMANDER 6

Installation Guide for: PC6-25004

Model Coverage: 2009-2012 Can-Am Spyder RS

PARTS LIST

- | | |
|--------------------------|-----------------|
| 1 POWER COMMANDER 6 | 2 VELCRO STRIPS |
| 1 INSTALLATION GUIDE | 1 ALCOHOL SWAB |
| 1 USB CABLE | 1 POSI-TAP |
| 2 DYNOJET DECALS | 2 ZIP TIES |
| 2 POWER COMMANDER DECALS | |

**PLEASE READ ALL DIRECTIONS BEFORE STARTING INSTALLATION.
THE IGNITION MUST BE TURNED OFF BEFORE INSTALLATION.**



INPUT ACCESSORY GUIDE



OPTIONAL ACCESSORY INPUTS

- Map** (Input 1 or 2) The PC6 has the ability to hold 2 different base maps. You can switch on the fly between these two base maps when you hook up a switch to the MAP inputs. You can use any open/close type switch. The polarity of the wires is not important.
- Shifter** (Input 1 or 2) Used for clutch-less full throttle upshifts. Insert the wires from the Dynojet quick shifter into either Input 1 or Input 2. The polarity of the wires is not important. Set to Input 2 by default.
- Speed** If your application has a speed sensor then you can tap into the signal side of the sensor and run a wire into this input. This will allow you to calculate gear position in the Control Center Software. Once gear position is setup you can alter your map based on gear position and setup gear dependent kill times when using a quick shifter.
- Analog** This input is for a 0-5v signal such as engine temp, boost, etc. Once this input is established you can alter your fuel curve based on this input in the Power Core software.
- Launch** You can connect a wire to either Input 1 or Input 2 and then the other end to a switch. This switch when engaged (continuity) will only allow the RPM to be raised to a certain limit (set in the software). When released, you will have full RPM.

WIRE CONNECTIONS

To input wires into the PC6 first remove the rubber plug on the backside of the unit and loosen the screw for the corresponding input. Using a 22-24 gauge wire, strip about 10mm from its end. Push the wire into the hole of the PC6 until it stops and then tighten the screw. Make sure to reinstall the rubber plug.

NOTE: If you tin the wires with solder it will make inserting them easier.



INSTALLING THE POWER COMMANDER 6



- 1 Remove the cosmetic covers on both the right and left sides.



- 2 Remove the air box cover by releasing the clips around the edge of the air box.



- 3 To remove the air box base, remove the six bolts around the velocity stacks.
Only four bolts are visible.
- 4 Cut the three zip-ties on the left side of the air box that secure the wiring harness.
- 5 Pull the air box base out the right side.
This allows access to the fuel injectors.

- 6 Using the supplied Velcro, secure the PC6 unit in place next to the fuse box.

This is located under the front storage hatch. Make sure to clean both surfaces with the alcohol swab before attaching.

- 7 Route the PC6 harness down the left side of the vehicle and go towards the throttle bodies.

The harness will be secured in place in a later step.



- 8 Unplug the stock wiring harness from the rear fuel injector on the left side of the throttle bodies.

To release the connector squeeze the spring clip into the connector.

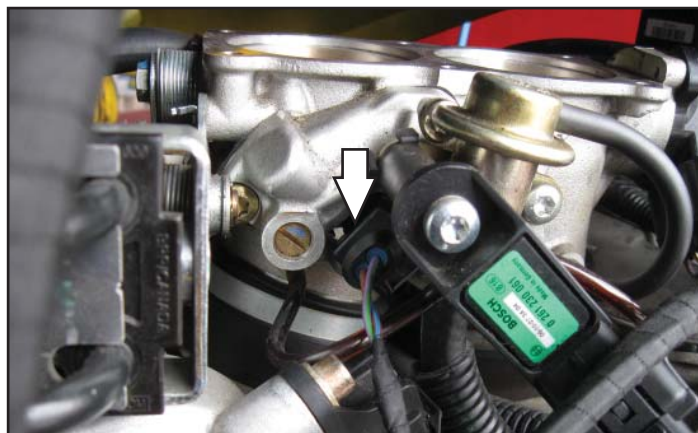

- 9 Plug the pair of PC6 leads with YELLOW colored wires in-line of the stock wiring harness and the rear fuel injector.

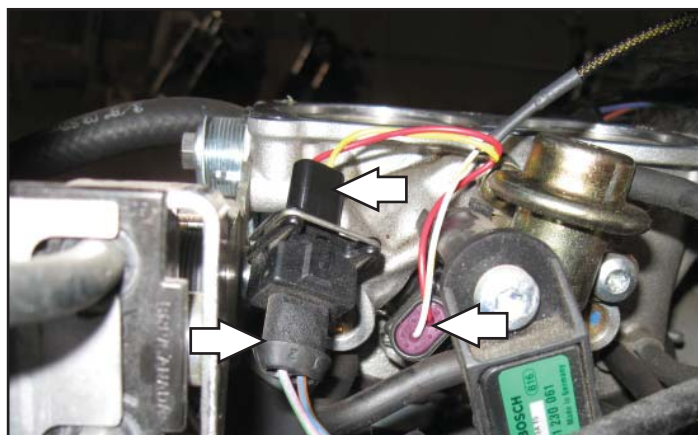

- 10 Unplug the stock wiring harness from the front fuel injector on the right side of the throttle bodies.

To release the connector squeeze the spring clip into the connector.

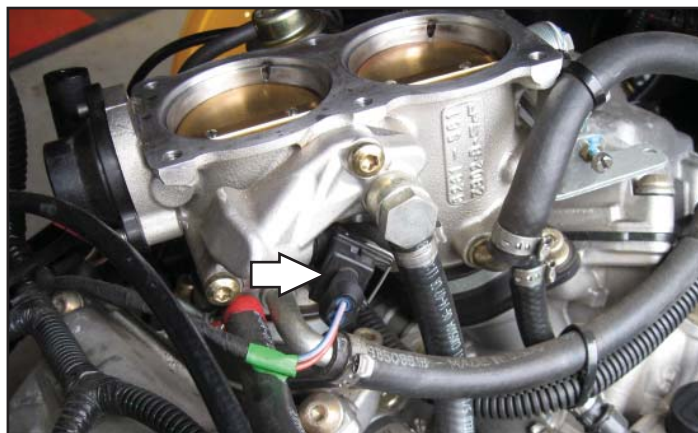

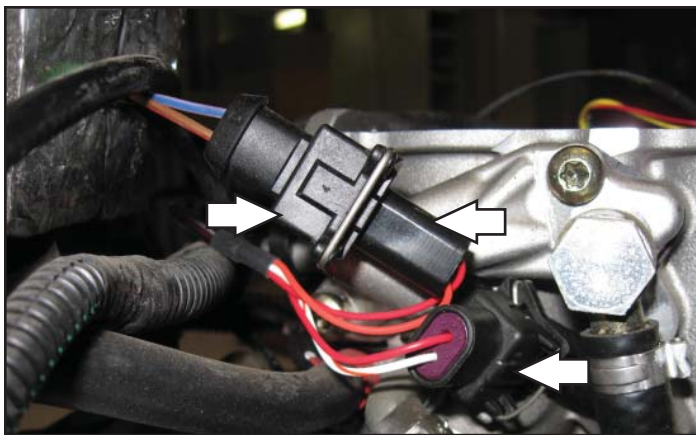

- 11 Plug the pair of PC6 leads with ORANGE colored wires in-line of the stock wiring harness and the rear fuel injector.

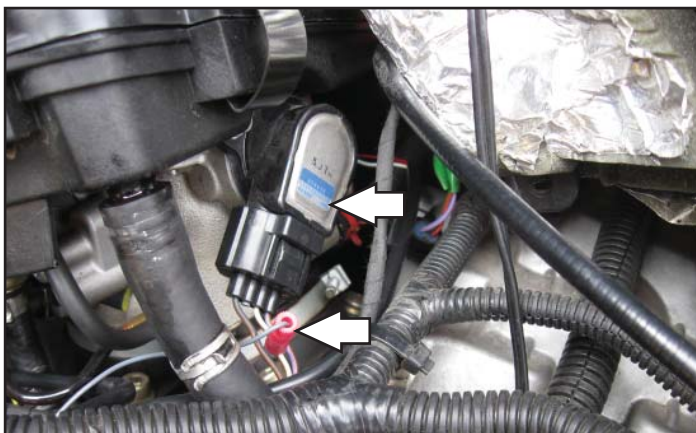

- 12 Attach the GREY wire of the PC6 to the stock WHITE/BROWN wire of the Throttle Position Sensor using the supplied Posi-Tap.

The TPS is located on the left side of the throttle bodies.

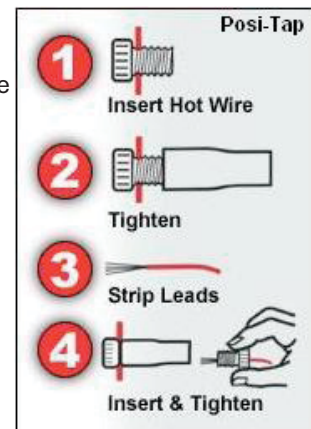

- 13 Attach the ground wire of the PC6 to the rear cylinder head on the left side.

Remove the stock bolt and insert bolt thru the eyelet of the PC6 ground wire and reinstall bolt into the head.



- 14 Reinstall the air box. Use the supplied zip ties to secure the PC6 harness along with the stock harness in the original location.
- 15 Reinstall all of the bodywork.

Download the latest map files from our web site at dynojet.com/tunes.



**PUSH
THE
LIMIT**

2191 MENDENHALL DRIVE, NORTH LAS VEGAS, NV 89081 - 800-992-4993 - DYNOJET.COM
© 2009-2021 DYNOJET RESEARCH ALL RIGHTS RESERVED