

POWER COMMANDER 6

Install Guide for: PC6-17068

Model coverage: 2017-2020 Kawasaki Z125

PARTS LIST



- | | | | |
|---|------------------------|---|---------------|
| 1 | POWER COMMANDER 6 | 2 | VELCRO STRIPS |
| 1 | INSTALLATION GUIDE | 1 | ALCOHOL SWAB |
| 1 | USB CABLE | 1 | POSI-TAP |
| 2 | DYNOJET DECALS | 1 | EO LABEL |
| 2 | POWER COMMANDER DECALS | | |

**PLEASE READ ALL DIRECTIONS BEFORE STARTING INSTALLATION.
THE IGNITION MUST BE TURNED OFF BEFORE INSTALLATION.**



INPUT ACCESSORY GUIDE

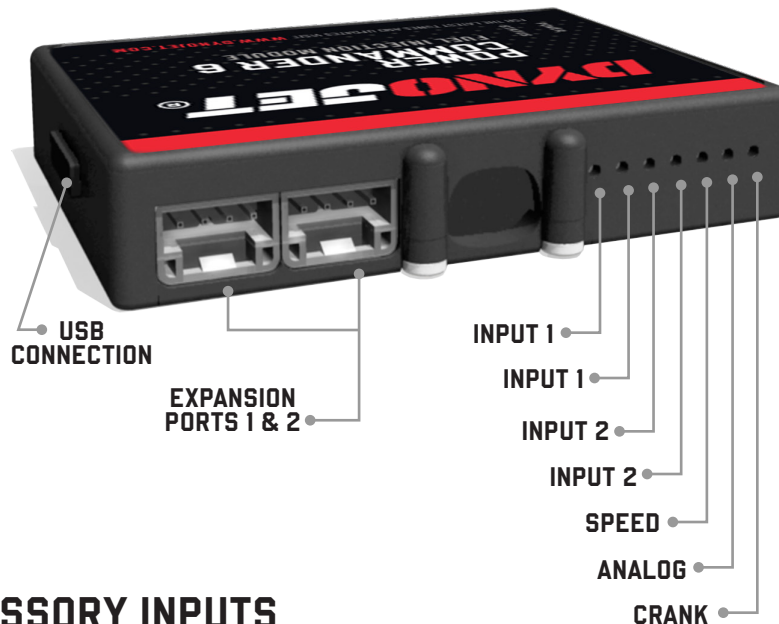

OPTIONAL ACCESSORY INPUTS

- Map** (Input 1 or 2) The PC6 has the ability to hold 2 different base maps. You can switch on the fly between these two base maps when you hook up a switch to the MAP inputs. You can use any open/close type switch. The polarity of the wires is not important.
- Shifter** (Input 1 or 2) Used for clutch-less full throttle upshifts. Insert the wires from the Dynojet quick shifter into either Input 1 or Input 2. The polarity of the wires is not important. Set to Input 2 by default.
- Speed** If your application has a speed sensor then you can tap into the signal side of the sensor and run a wire into this input. This will allow you to calculate gear position in the Control Center Software. Once gear position is setup you can alter your map based on gear position and setup gear dependent kill times when using a quickshifter. .
- Analog** This input is for a 0-5v signal such as engine temp, boost, etc. Once this input is established you can alter your fuel curve based on this input in the Power Core software.
- Launch** You can connect a wire to either Input 1 or Input 2 and then the other end to a switch. This switch when engaged (continuity) will only allow the RPM to be raised to a certain limit (set in the software). When released, you will have full RPM.

WIRE CONNECTIONS

To input wires into the PC6 first remove the rubber plug on the backside of the unit and loosen the screw for the corresponding input. Using a 22-24 gauge wire, strip about 10mm from its end. Push the wire into the hole of the PC6 until it stops and then tighten the screw. Make sure to reinstall the rubber plug.

NOTE: If you tin the wires with solder it will make inserting them easier.

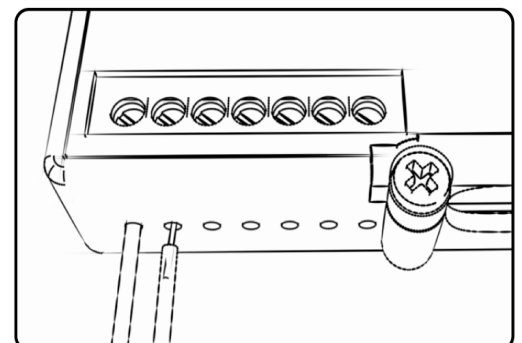

INSTALLING THE POWER COMMANDER 6

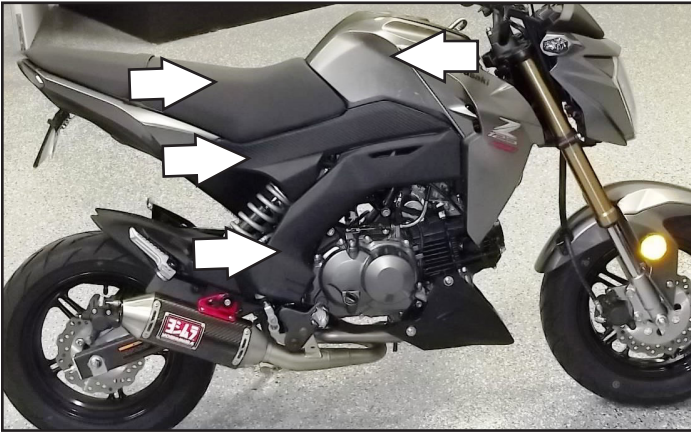

REMOVE BODYWORK

- 1 Remove the seat.
- 2 Remove the side panels on both sides of the bike that are below the seat and on the sides of the fuel tank.
- 3 Remove the horn and the airbox.

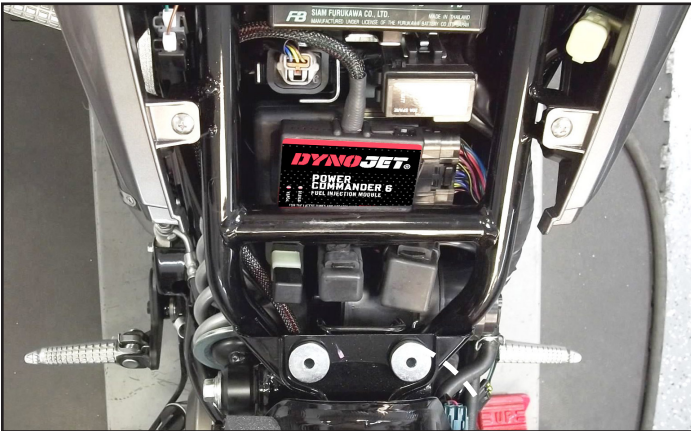

INSTALL PC6

- 4 Use the supplied Velcro to secure the PC6 module under the seat and on top of the bike's ECM.
Clean surfaces with the supplied alcohol swab before attaching the Velcro.
- 5 Route the PC6 wiring harness forward, towards the engine, along the right side of the bike. Keep the wiring harness inside of the frame rails.

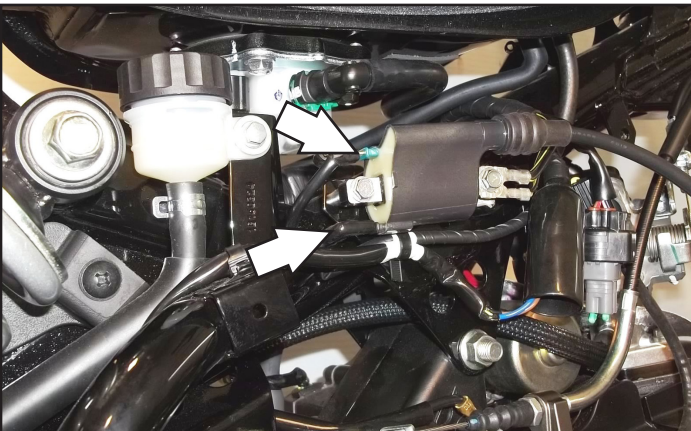

CONNECT INJECTOR & TPS

- 6 Unplug the spade terminal with the stock BLACK wire from the green Ignition Coil tab.
- 7 Unplug the spade terminal with the stock RED wire from the black Ignition Coil tab.

INSTALLING THE POWER COMMANDER 6

- 8 Plug the pair of RED/WHITE wires with spade connectors on the PC6 wiring harness in-line of the stock RED wire and the black Ignition Coil tab.
- 9 Plug the GREEN and WHITE/GREEN wires with spade connectors on the PC6 wiring harness in-line of the stock BLACK wire and the green Ignition Coil tab.
- 10 Secure the PC6 ground wire with the ring terminal to the stock Ignition Coil mounting bolt that holds the stock ground wires.

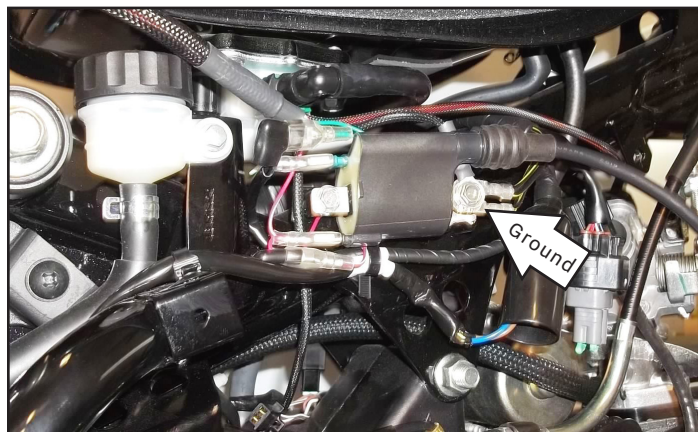

CONNECT TO COIL & GROUND

- 11 Route the PC6 wiring harness branch with the pair of 2-pin connectors that have BROWN colored wires through the bike to the left hand side.
- 12 Locate and unplug the stock Crank Position Sensor connectors.

This stock 2-pin connector pair is located inside a black rubber boot on the left hand side of the bike.



UNPLUG CPS

- 13 Plug the pair of 2-pin PC6 connectors with BROWN colored wires in-line of the stock Crank Position Sensor connectors.



CONNECT TO CPS

INSTALLING THE POWER COMMANDER 6

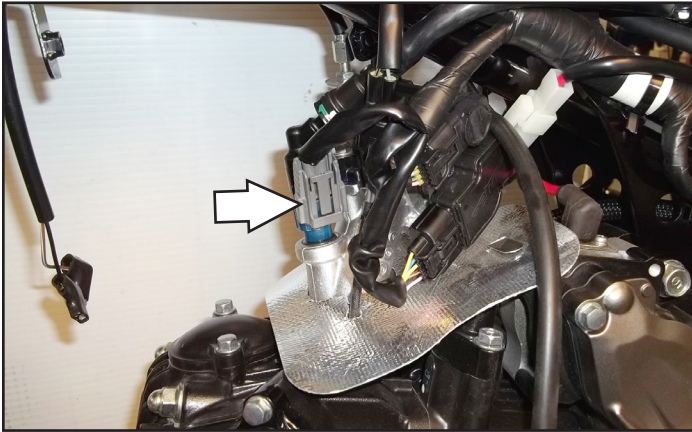

UNPLUG INJECTOR

- 14 Route the PC6 wiring harness branch with the ORANGE colored wires forward and to the throttle body.
- 15 Unplug the stock wiring harness from the Fuel Injector.

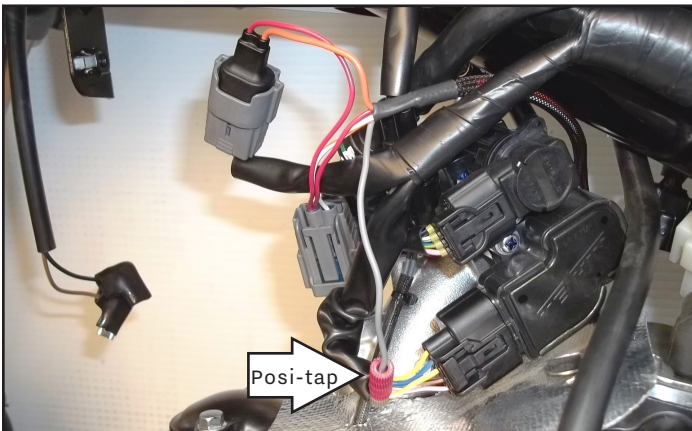

REMOVE BODYWORK

- 16 Plug the pair of PC6 wiring harness connectors with ORANGE colored wires in-line of the Fuel Injector and the stock wiring harness.
- 17 Use the supplied Posi-tap to attach the PC6 GREY wire to the stock YELLOW/WHITE wire of the bike's Throttle Position Sensor connector.
- 18 Reinstall the airbox, the horn, the bodywork, and the seat.
- 19 Affix the supplied CARB E.O. label to a conspicuous area. Next to the original emissions label is the preferred location. Make sure to clean the surface before attaching.

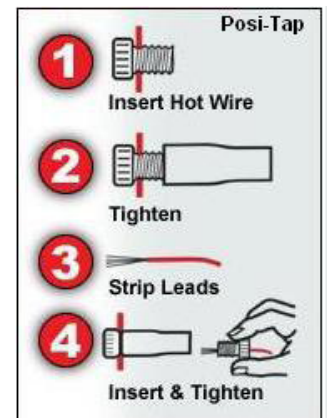

Download the latest map files from our web site at dynojet.com/tunes.



PUSH THE LIMIT

2191 MENDENHALL DRIVE, NORTH LAS VEGAS, NV 89081 - 800-992-4993 - DYNOJET.COM
© 2007-2022 DYNOJET RESEARCH ALL RIGHTS RESERVED