

POWER COMMANDER 6

Installation Guide for: PC6-17073

Model Coverage: Kawasaki Vulcan Models

1999-2005 VN1500 Drifter

2000-2004 VN1500 Nomad

2000-2008 VN1500 Classic

2002-2008 Mean Streak (1500 & 1600)

PARTS LIST

×

- | | |
|--------------------------|-----------------|
| 1 POWER COMMANDER 6 | 2 VELCRO STRIPS |
| 1 INSTALLATION GUIDE | 1 ALCOHOL SWAB |
| 1 USB CABLE | 1 POSI-TAP |
| 2 DYNOJET DECALS | 1 GROUND WIRE |
| 2 POWER COMMANDER DECALS | |

**PLEASE READ ALL DIRECTIONS BEFORE STARTING INSTALLATION.
THE IGNITION MUST BE TURNED OFF BEFORE INSTALLATION.**

×

IPC6-17073.01



INPUT ACCESSORY GUIDE



OPTIONAL ACCESSORY INPUTS

- Map** (Input 1 or 2) The PC6 has the ability to hold 2 different base maps. You can switch on the fly between these two base maps when you hook up a switch to the MAP inputs. You can use any open/close type switch. The polarity of the wires is not important.
- Shifter** (Input 1 or 2) Used for clutch-less full throttle upshifts. Insert the wires from the Dynojet quick shifter into either Input 1 or Input 2. The polarity of the wires is not important. Set to Input 2 by default.
- Speed** If your application has a speed sensor then you can tap into the signal side of the sensor and run a wire into this input. This will allow you to calculate gear position in the Control Center Software. Once gear position is setup you can alter your map based on gear position and setup gear dependent kill times when using a quick shifter.
- Analog** This input is for a 0-5v signal such as engine temp, boost, etc. Once this input is established you can alter your fuel curve based on this input in the Power Core software.
- Launch** You can connect a wire to either Input 1 or Input 2 and then the other end to a switch. This switch when engaged (continuity) will only allow the RPM to be raised to a certain limit (set in the software). When released, you will have full RPM.

WIRE CONNECTIONS

To input wires into the PC6 first remove the rubber plug on the backside of the unit and loosen the screw for the corresponding input. Using a 22-24 gauge wire, strip about 10mm from its end. Push the wire into the hole of the PC6 until it stops and then tighten the screw. Make sure to reinstall the rubber plug.

NOTE: If you tin the wires with solder it will make inserting them easier.



INSTALLING THE POWER COMMANDER 6

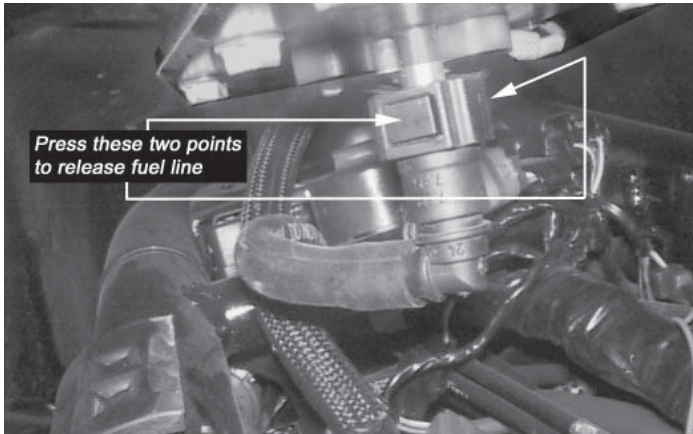

- 1 Remove the left side cover and the main seat.
- 2 Remove the speedometer assembly.
- 3 Remove the fuel tank.

To remove the fuel line squeeze the sides of the connector.

Disconnect the two electrical connectors.

Disconnect vent lines.

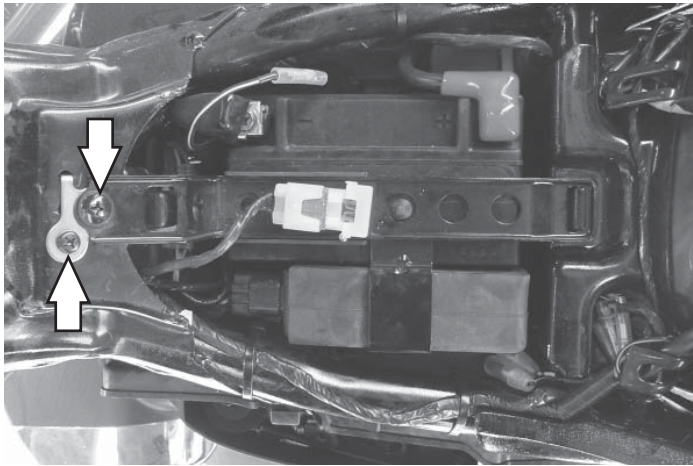

- 4 Remove the battery/ECU bracket.

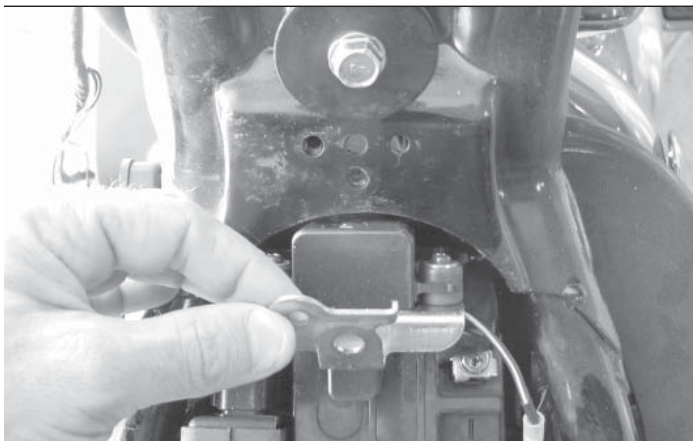

- 5 Unbolt and move the tip over switch out of the way.
- Steps 4 and 5 only need to be done on the VN1500 Drifter, Nomad, and Classic models. These steps can be excluded on Mean Streak models.

- 6 Loosen the four bolts holding the plastic tray on the left side of the bike (under the left side cover).

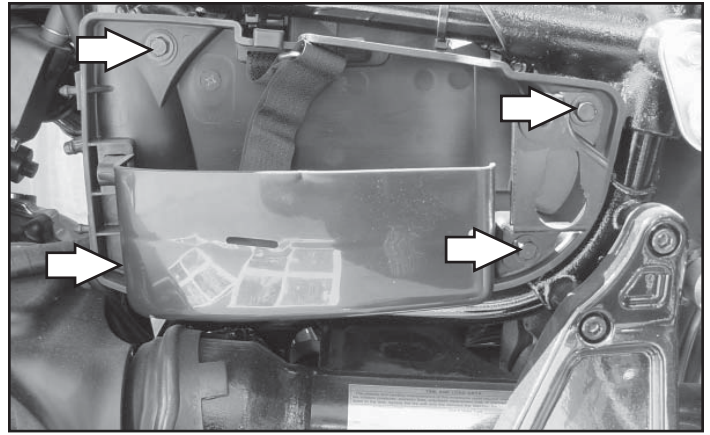

- 7 Route the PC6 wiring harness between the plastic tray and the left frame rail. Continue routing beneath the frame/lower fuel tank mount and towards the throttle body.



- 8 At the throttle body, unplug the front and rear cylinder Fuel Injectors and the Throttle Position Sensor.

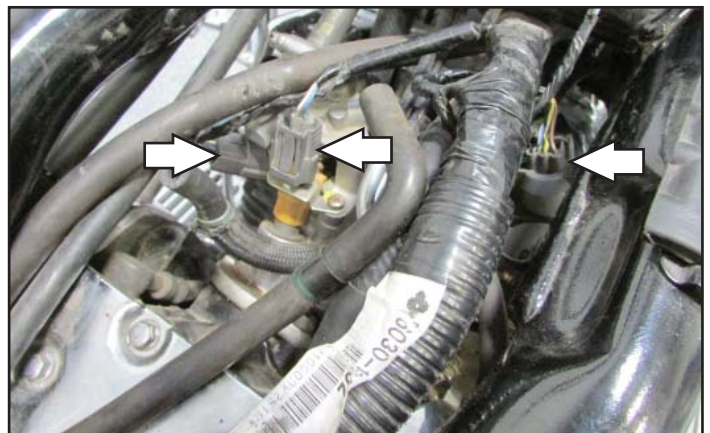

- 9 Use the supplied Posi-tap to attach the GREY wire of the PC6 wiring harness to the stock YELLOW/WHITE wire of the TPS connector. Plug the TPS connector back on to the TPS.

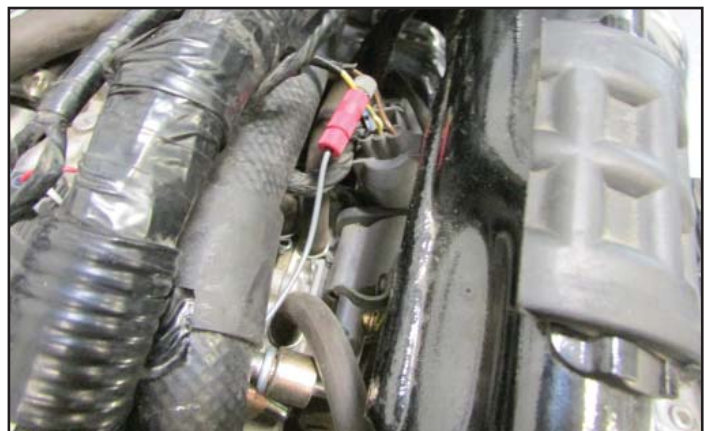
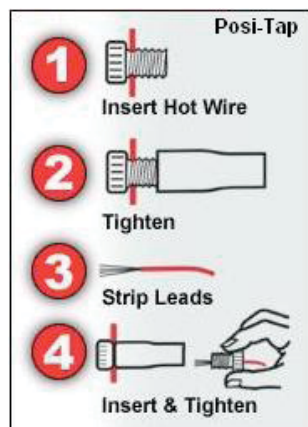



- 10 Plug the pair of PC6 leads with ORANGE colored wires in-line of the Front Cylinder Fuel Injector and the stock wiring harness.
- 11 Plug the pair of PC6 leads with YELLOW colored wires in-line of the Rear Cylinder Fuel Injector and the stock wiring harness.
- 12 Reinstall the fuel tank, speedometer assembly, and the tip over switch.

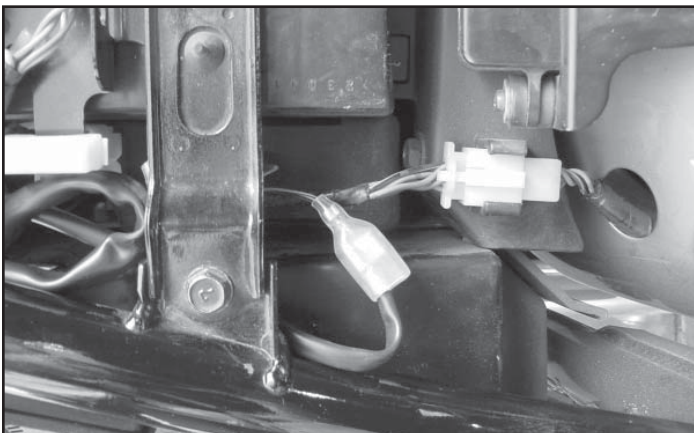

- 13 On Mean Streak models only, plug the PC6 ground wire with the male bullet connector into the stock auxiliary ground connector. The stock auxiliary ground connector is found next to the battery. It has a double female bullet connector and a BLACK/YELLOW wire.

You can omit the supplied Ground Wire on Mean Streak models. It is only used on VN1500 Drifter, Nomad, and Classic models.



- 14 On VN1500 Drifter, Nomad, and Classic models, secure the supplied Ground Wire to the negative (-) terminal of the bike's battery. Plug the PC6 wiring harness into the Ground Wire.

- 15 Use the supplied Velcro to secure the PC6 module in the tray behind the left side cover. Clean surfaces with the supplied alcohol swab before attaching the Velcro.

California models may have a charcoal canister stored in this area. If so, the PC6 module can be secured at the front of the charcoal canister.

- 16 Reinstall the battery bracket, seat, and side cover.

Download the latest map files from our web site at dynojet.com/tunes.





PUSH THE LIMIT

**2191 MENDENHALL DRIVE, NORTH LAS VEGAS, NV 89081 - 800-992-4993 - DYNOJET.COM
© 1999-2022 DYNOJET RESEARCH ALL RIGHTS RESERVED**