

# POWER COMMANDER 6

Install guide for PC6-22098

Model coverage:

2021-2022 Yamaha MT-09

## PARTS LIST



- |   |                    |   |                        |
|---|--------------------|---|------------------------|
| 1 | POWER COMMANDER 6  | 2 | POWER COMMANDER DECALS |
| 1 | INSTALLATION GUIDE | 3 | VELCRO STRIPS          |
| 1 | USB CABLE          | 1 | ALCOHOL SWAB           |
| 2 | DYNOJET DECALS     | 1 | POSI-TAP               |

**PLEASE READ ALL DIRECTIONS BEFORE STARTING INSTALLATION.  
THE IGNITION MUST BE TURNED OFF BEFORE INSTALLATION.**



IPC6-22098.01



# INPUT ACCESSORY GUIDE

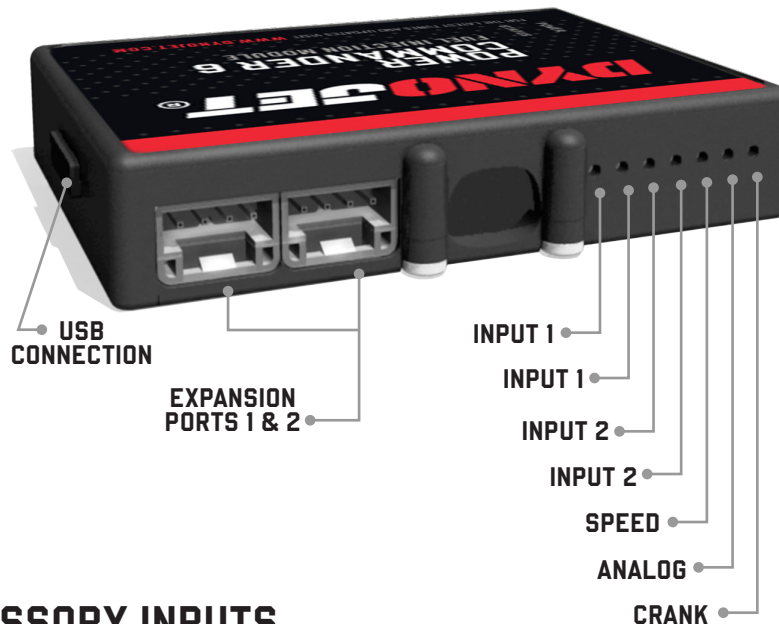

## OPTIONAL ACCESSORY INPUTS

- Map** (Input 1 or 2) The PC6 has the ability to hold 2 different base maps. You can switch on the fly between these two base maps when you hook up a switch to the MAP inputs. You can use any open/close type switch. The polarity of the wires is not important.
- Shifter** (Input 1 or 2) Used for clutch-less full throttle upshifts. Insert the wires from the Dynojet quick shifter into either Input 1 or Input 2. The polarity of the wires is not important. Set to Input 2 by default.
- Speed** If your application has a speed sensor then you can tap into the signal side of the sensor and run a wire into this input. This will allow you to calculate gear position in the Control Center Software. Once gear position is setup you can alter your map based on gear position and setup gear dependent kill times when using a quick shifter.
- Analog** This input is for a 0-5v signal such as engine temp, boost, etc. Once this input is established you can alter your fuel curve based on this input in the Power Core software.
- Launch** You can connect a wire to either Input 1 or Input 2 and then the other end to a switch. This switch when engaged (continuity) will only allow the RPM to be raised to a certain limit (set in the software). When released, you will have full RPM.

## WIRE CONNECTIONS

To input wires into the PC6 first remove the rubber plug on the backside of the unit and loosen the screw for the corresponding input. Using a 22-24 gauge wire, strip about 10mm from its end. Push the wire into the hole of the PC6 until it stops and then tighten the screw. Make sure to reinstall the rubber plug.

NOTE: If you tin the wires with solder it will make inserting them easier.

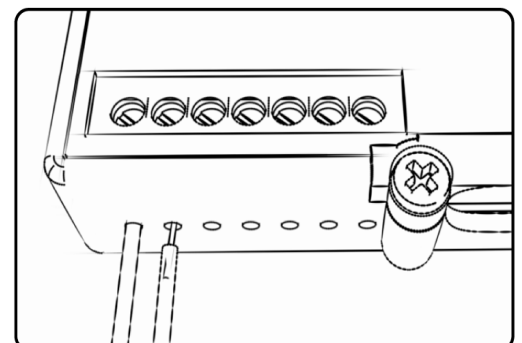

# INSTALLING THE POWER COMMANDER 6



- 1 Remove the seat.
- 2 Remove the fuel tank.
- 3 Unplug the ECM.
- 4 Remove the air box.

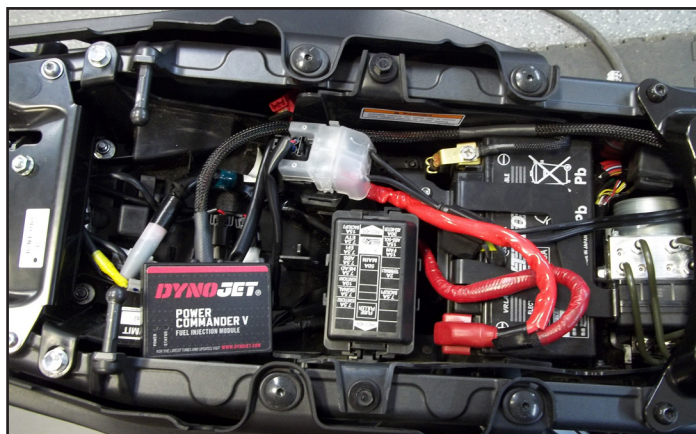

- 5 Lay the PC6 in tail section. Route the PC6 harness down the left side of the frame going towards the throttle bodies.
- 6 Attach the ground wire of the PC6 to the negative (-) side of the battery.



- 7 Locate and unplug the stock Crank Position Sensor connectors.

*This connection is behind the throttle bodies on the right side of the frame.*



- 8 Plug the pair of PC6 connectors with BROWN colored wires in-line of the stock Crank Position Sensor connectors.

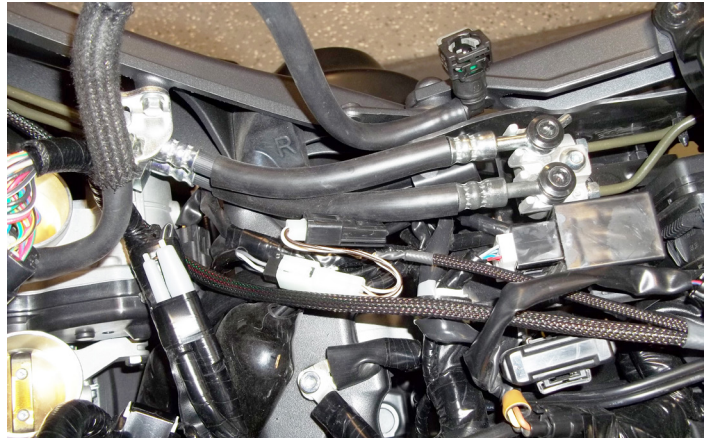

- 9 Unplug the stock Throttle Position Sensor (TPS) connector.

*This is a BLACK 4-pin connector on the right side of the throttle bodies.*

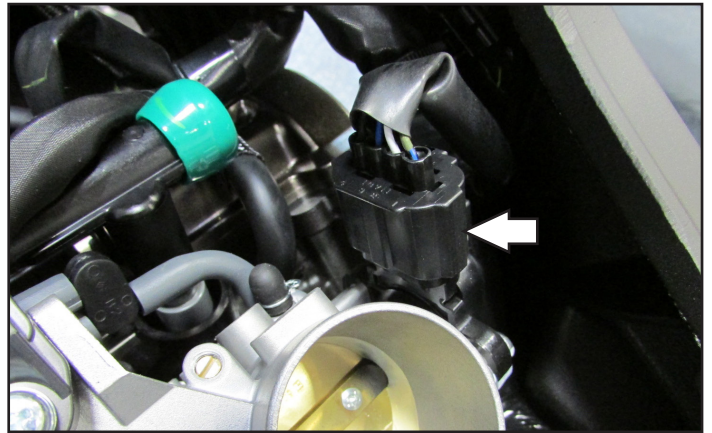

- 10 Use the supplied Posi-Tap to attach the PC6's GREY wire to the stock WHITE wire of the bike's TPS. Reconnect the stock wiring harness to the TPS after attaching the GREY wire.

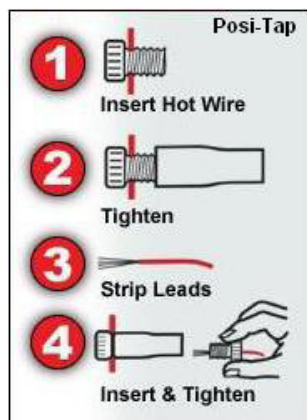

- 11 Continue routing the PC6 wiring harness across the top of the fuel rail.

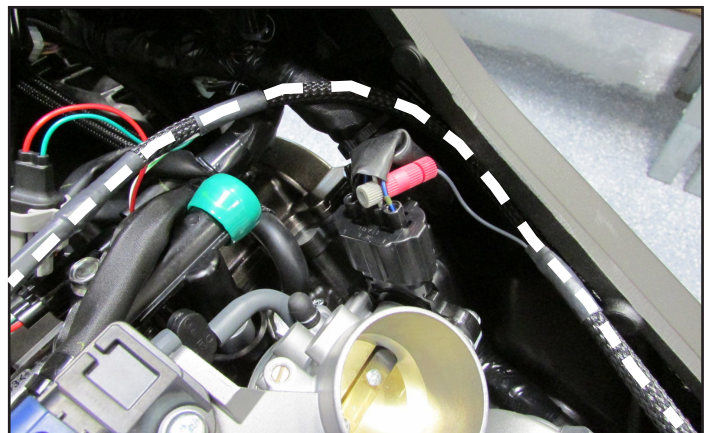

- 12 Unplug the stock wiring harness from all three of the bike's Fuel Injectors.

*The cylinder #3 (right-most) injector cannot be seen from this picture. It is in the vicinity of the dashed circle.*

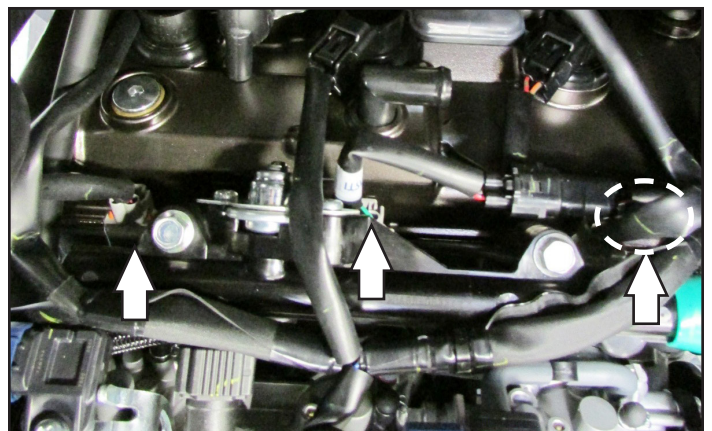

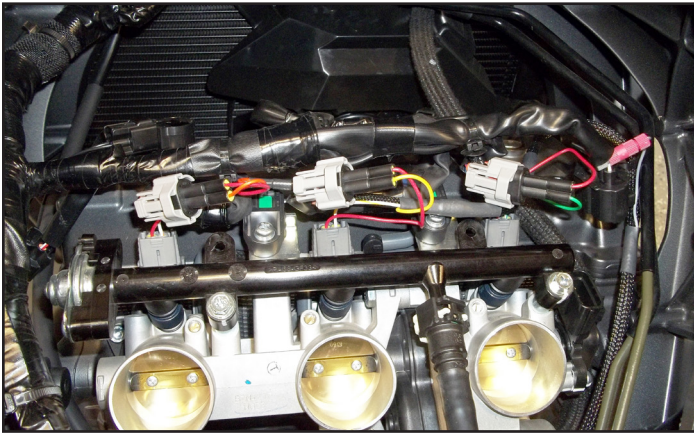

- 13 Plug the PC6 wiring harness in-line of each Fuel Injector and the stock wiring harness.

*The pair of PC6 leads with GREEN colored wires go in-line of the cylinder #3 (right-most) Fuel Injector and the stock wiring harness.*

*The pair of PC6 leads with YELLOW colored wires go in-line of the cylinder #2 (middle) Fuel Injector and the stock wiring harness.*

*The pair of PC6 leads with ORANGE colored wires go in-line of the cylinder #1 (left-most) Fuel Injector and the stock wiring harness.*

- 14 Using one of the supplied Velcro strips, secure the PC6 module in the tail section.

*Use the supplied alcohol swab to clean the surface area prior to applying the Velcro.*

- 15 Reinstall the air box. Plug in the ECM. Reinstall the fuel tank and the seat.

Download the latest map files from our web site at [dynojet.com/tunes](http://dynojet.com/tunes).

#### **Optional Inputs:**

12v source for Autotune - BLUE wire of WHITE 3-pin tail light connector.



# **PUSH THE LIMIT**

**2191 MENDENHALL DRIVE, NORTH LAS VEGAS, NV 89081 - 800-992-4993 - [DYNOJET.COM](http://DYNOJET.COM)**  
**© 2017-2020 DYNOJET RESEARCH ALL RIGHTS RESERVED**