

POWER COMMANDER 6

Installation Guide for: PC6-22056

Model Coverage: 2013-2015 Yamaha FJR1300

PARTS LIST



- | | |
|----------------------|--------------------------|
| 1 POWER COMMANDER 6 | 2 POWER COMMANDER DECALS |
| 1 INSTALLATION GUIDE | 2 VELCRO STRIPS |
| 1 USB CABLE | 1 ALCOHOL SWAB |
| 2 DYNOJET DECALS | 1 POSI-TAP |

**PLEASE READ ALL DIRECTIONS BEFORE STARTING INSTALLATION.
THE IGNITION MUST BE TURNED OFF BEFORE INSTALLATION.**



IPC6-22056.01



INPUT ACCESSORY GUIDE



OPTIONAL ACCESSORY INPUTS

- Map** (Input 1 or 2) The PC6 has the ability to hold 2 different base maps. You can switch on the fly between these two base maps when you hook up a switch to the MAP inputs. You can use any open/close type switch. The polarity of the wires is not important.
- Shifter** (Input 1 or 2) Used for clutch-less full throttle upshifts. Insert the wires from the Dynojet quick shifter into either Input 1 or Input 2. The polarity of the wires is not important. Set to Input 2 by default.
- Speed** If your application has a speed sensor then you can tap into the signal side of the sensor and run a wire into this input. This will allow you to calculate gear position in the Control Center Software. Once gear position is setup you can alter your map based on gear position and setup gear dependent kill times when using a quick shifter.
- Analog** This input is for a 0-5v signal such as engine temp, boost, etc. Once this input is established you can alter your fuel curve based on this input in the Power Core software.
- Launch** You can connect a wire to either Input 1 or Input 2 and then the other end to a switch. This switch when engaged (continuity) will only allow the RPM to be raised to a certain limit (set in the software). When released, you will have full RPM.

WIRE CONNECTIONS

To input wires into the PC6 first remove the rubber plug on the backside of the unit and loosen the screw for the corresponding input. Using a 22-24 gauge wire, strip about 10mm from its end. Push the wire into the hole of the PC6 until it stops and then tighten the screw. Make sure to reinstall the rubber plug.

NOTE: If you tin the wires with solder it will make inserting them easier.



INSTALLING THE POWER COMMANDER 6



To see a video demonstration of this installation visit our channel (DynojetResearch) on YouTube.

- 1 Remove both of the headlight adjuster knobs.
- 2 Turn the bike's key switch on and open the glove compartment on the left side of the bike.
- 3 Remove the panel surrounding the gauge cluster.



- 4 Remove the battery cover from the right side of the bike to access the bike's battery.



- 5 Remove the rider and passenger seats.
- 6 Remove the plastic panel at the back of the fuel tank and directly in front of the rider seat.
- 7 Remove the fuel tank.

- 8 Remove the cross-member bracket under the fuel tank and the heat shield.



- 9 Use the supplied Velcro strips to secure the PC6 module in the compartment beneath the rider seat.

Clean the surface with the supplied alcohol swab prior to applying the Velcro.

- 10 Route the PC6 harness forward toward the engine following inside the left side frame rail. Route the harness under the bracket for the fuel tank.



- 11 Unplug the stock wiring harness from each fuel injector.

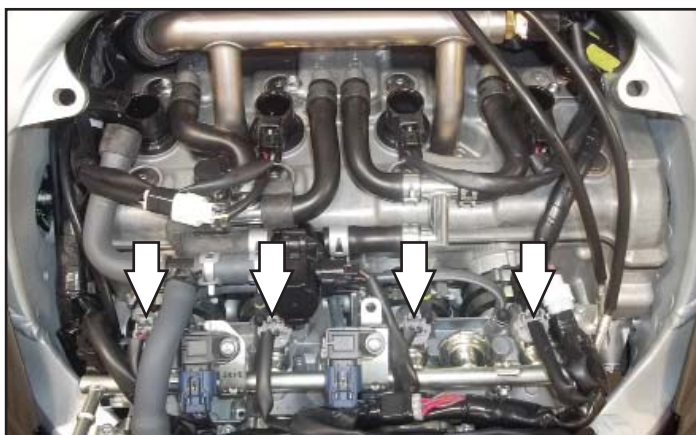

- 12 Plug the PC6 harness in-line of each fuel injector and the stock wiring harness for each injector.

The pair of PC6 harness leads with ORANGE colored wires will connect in-line with the cylinder #1 (left most) fuel injector.

The pair of PC6 harness leads with YELLOW colored wires will connect in-line with the cylinder #2 fuel injector.

The pair of PC6 harness leads with GREEN colored wires will connect in-line with the cylinder #3 fuel injector.

The pair of PC6 harness leads with BLUE colored wires will connect in-line with the cylinder #4 (right most) fuel injector.





- 13 Locate and unplug the stock connector for the bike's Throttle Position Sensor.

The TPS is located on the left side of the left most throttle body.

- 14 Use the supplied Posi-tap to attach the unterminated GREY wire of the PC6 harness to the stock WHITE wire of the bike's TPS.

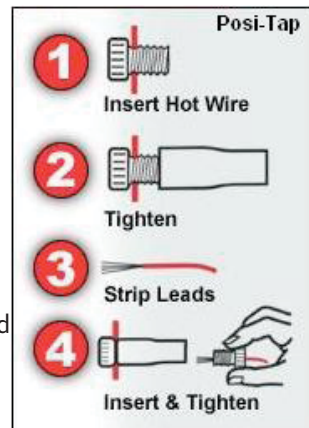

- 15 Plug the stock TPS connector back onto the TPS.

- 16 Route the remainder of the PC6 harness with the 6mm ring lug towards the forward right corner of engine, under the frame rail, and up to the top of the bike's battery.

This ring lug will need to be routed under the frame and into the battery compartment, where it will be secured to the negative terminal of the bike's battery. You can follow alongside the stock battery wires. A long stemmed hooked scribe will be helpful to hook onto the ring lug at the bottom of the battery compartment. Then you can pull the ring lug up to the top of the battery.

- 17 Secure the ring lug to the negative (-) terminal of the bike's battery.

Download the latest map files from our web site at dynojet.com/tunes.

Optional inputs:

Temperature input - GREEN/WHITE wire on coolant pipe above the valve cover or at ECU.

12v source for Autotune - BLUE wire of tail light connector.



**PUSH
THE
LIMIT**

**2191 MENDENHALL DRIVE, NORTH LAS VEGAS, NV 89081 - 800-992-4993 - DYNOJET.COM
© 2013-2022 DYNOJET RESEARCH ALL RIGHTS RESERVED**