

# POWER COMMANDER 6

Install guide for: PC6-17062

Model coverage:

2015-2020 Kawasaki Ninja H2

## PARTS LIST



- |   |                    |   |                        |
|---|--------------------|---|------------------------|
| 1 | POWER COMMANDER 6  | 2 | POWER COMMANDER DECALS |
| 1 | INSTALLATION GUIDE | 2 | VELCRO STRIPS          |
| 1 | USB CABLE          | 1 | ALCOHOL SWAB           |
| 2 | DYNOJET DECALS     | 2 | POSI-TAP               |

**PLEASE READ ALL DIRECTIONS BEFORE STARTING INSTALLATION.  
THE IGNITION MUST BE TURNED OFF BEFORE INSTALLATION.**



# INPUT ACCESSORY GUIDE



## OPTIONAL ACCESSORY INPUTS

- Map** (Input 1 or 2) The PC6 has the ability to hold 2 different base maps. You can switch on the fly between these two base maps when you hook up a switch to the MAP inputs. You can use any open/close type switch. The polarity of the wires is not important.
- Shifter** (Input 1 or 2) Used for clutch-less full throttle upshifts. Insert the wires from the Dynojet quick shifter into either Input 1 or Input 2. The polarity of the wires is not important. Set to Input 2 by default.
- Speed** If your application has a speed sensor then you can tap into the signal side of the sensor and run a wire into this input. This will allow you to calculate gear position in the Control Center Software. Once gear position is setup you can alter your map based on gear position and setup gear dependent kill times when using a quickshifter. .
- Analog** This input is for a 0-5v signal such as engine temp, boost, etc. Once this input is established you can alter your fuel curve based on this input in the Power Core software.
- Launch** You can connect a wire to either Input 1 or Input 2 and then the other end to a switch. This switch when engaged (continuity) will only allow the RPM to be raised to a certain limit (set in the software). When released, you will have full RPM.

## WIRE CONNECTIONS

To input wires into the PC6 first remove the rubber plug on the backside of the unit and loosen the screw for the corresponding input. Using a 22-24 gauge wire, strip about 10mm from its end. Push the wire into the hole of the PC6 until it stops and then tighten the screw. Make sure to reinstall the rubber plug.

NOTE: If you tin the wires with solder it will make inserting them easier.



# INSTALLING THE POWER COMMANDER 6

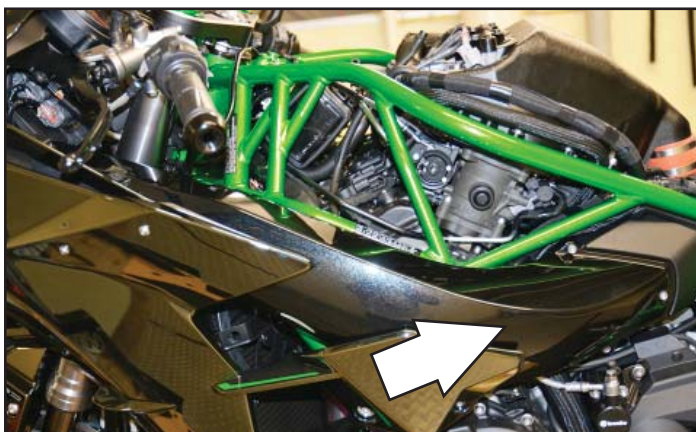

REMOVE INTAKE TUBE

- 1 Remove the seat and fuel tank.
- 2 Remove the intake tube.
- 3 Place the PC6 in the tail section and route the harness down the left side of the frame going towards the left side of the airbox.

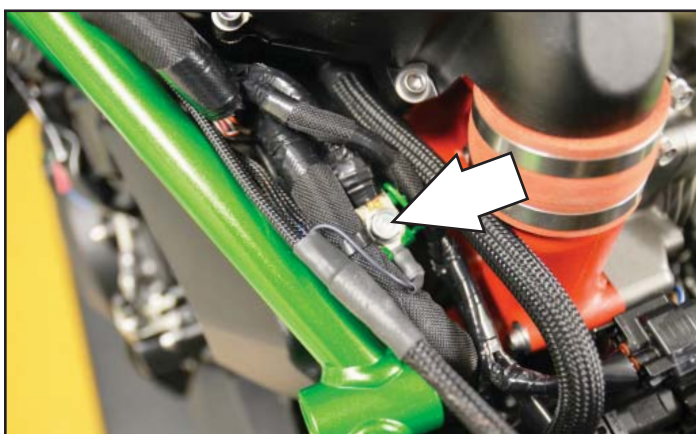

ATTACH GROUND

- 4 Attach the ground wire of the PC6 to the common chassis ground on the left side of the frame.

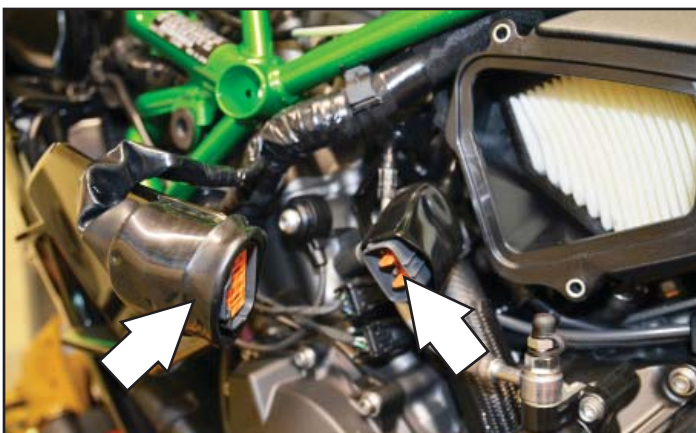

UNPLUG SUB CONNECTOR

- 5 Locate the GREY, 8 pin connector for the throttle bodies and unplug it.

*This connector is located inside a rubber boot on the left side of the engine in front of the airbox.*

# INSTALLING THE POWER COMMANDER 6

- 6 Route the PC6 harness in-side of the frame.



ROUTE PC6 HARNESS

- 7 Plug the PC6 in-line of the stock wiring harness.



CONNECT TO INJECTORS

- 8 Using the supplied Posi-tap attach the BLUE/WHITE wire of the PC6 to the stock GREEN/RED wire of the bike's Gear Position Sensor.

*The GPS is located above the left side engine cover. This is a BLACK 3 pin connector.*

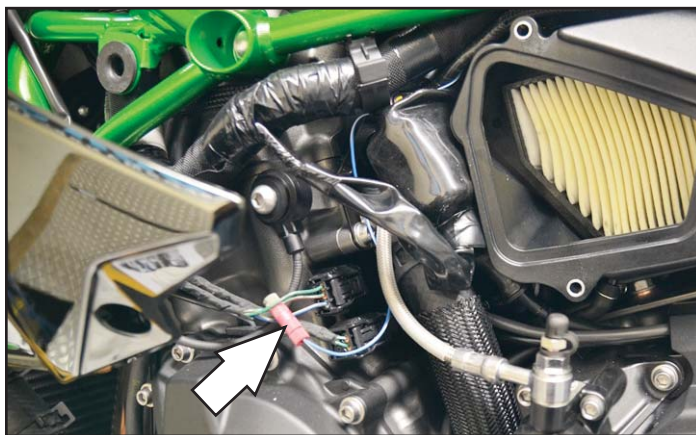
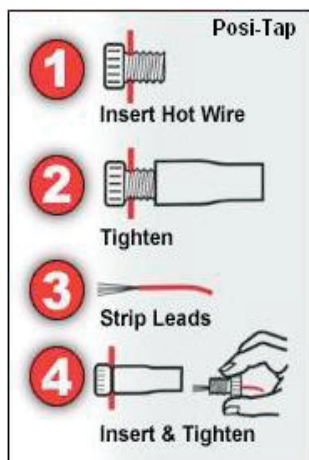

CONNECT TO GPS



# INSTALLING THE POWER COMMANDER 6



ROUTE HARNESS

- 9 Route the rest of the PC6 harness behind the charge pipe and go up the right side of the frame.

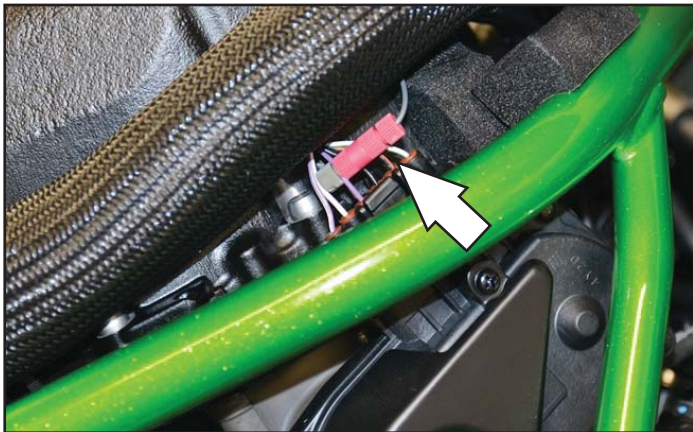

CONNECT TO TPS

- 10 Using the supplied Posi-Tap attach the GREY wire of the PC6 to the stock PURPLE wire of the bike's Throttle Position Sensor.

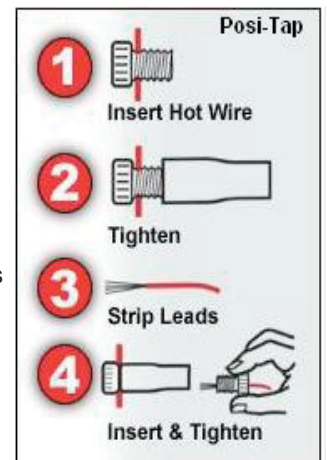

UNPLUG CPS

- 11 Unplug the Crank Position Sensor connector.  
*This is a BLACK, 2 pin connector near the #4 coil stick.*

# INSTALLING THE POWER COMMANDER 6

- 12 Plug the PC6 in-line of the stock CPS and wiring harness.



CONNECT TO CPS

- 13 Secure the PC6 in the tail section.
- 14 Reinstall all bodywork.



INSTALL PC6



**PUSH  
THE  
LIMIT**

**2191 MENDENHALL DRIVE, NORTH LAS VEGAS, NV 89081 - 800-992-4993 - [DYNOJET.COM](http://DYNOJET.COM)  
© 2015-2022 DYNOJET RESEARCH ALL RIGHTS RESERVED**