

# POWER COMMANDER 6

Installation Guide for: PC6-14019

Model Coverage: 2009-2011 Ducati 1198

## PARTS LIST

- |                          |                 |
|--------------------------|-----------------|
| 1 POWER COMMANDER 6      | 2 VELCRO STRIPS |
| 1 INSTALLATION GUIDE     | 1 ALCOHOL SWAB  |
| 1 USB CABLE              | 3 ZIP TIES      |
| 2 DYNOJET DECALS         | 1 POSI-TAP      |
| 2 POWER COMMANDER DECALS |                 |

**PLEASE READ ALL DIRECTIONS BEFORE STARTING INSTALLATION.  
THE IGNITION MUST BE TURNED OFF BEFORE INSTALLATION.**



# INPUT ACCESSORY GUIDE

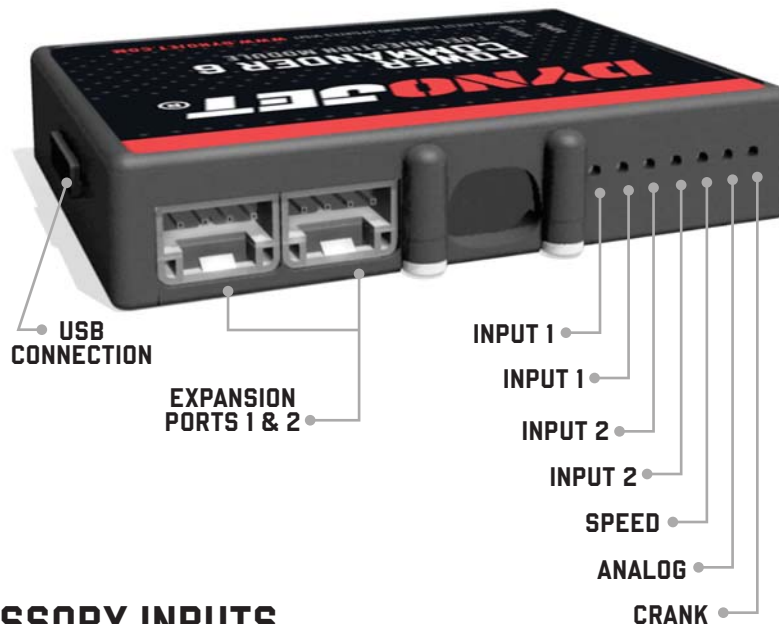

## OPTIONAL ACCESSORY INPUTS

- Map** (Input 1 or 2) The PC6 has the ability to hold 2 different base maps. You can switch on the fly between these two base maps when you hook up a switch to the MAP inputs. You can use any open/close type switch. The polarity of the wires is not important.
- Shifter** (Input 1 or 2) Used for clutch-less full throttle upshifts. Insert the wires from the Dynojet quick shifter into either Input 1 or Input 2. The polarity of the wires is not important. Set to Input 2 by default.
- Speed** If your application has a speed sensor then you can tap into the signal side of the sensor and run a wire into this input. This will allow you to calculate gear position in the Control Center Software. Once gear position is setup you can alter your map based on gear position and setup gear dependent kill times when using a quick shifter.
- Analog** This input is for a 0-5v signal such as engine temp, boost, etc. Once this input is established you can alter your fuel curve based on this input in the Power Core software.
- Launch** You can connect a wire to either Input 1 or Input 2 and then the other end to a switch. This switch when engaged (continuity) will only allow the RPM to be raised to a certain limit (set in the software). When released, you will have full RPM.

## WIRE CONNECTIONS

To input wires into the PC6 first remove the rubber plug on the backside of the unit and loosen the screw for the corresponding input. Using a 22-24 gauge wire, strip about 10mm from its end. Push the wire into the hole of the PC6 until it stops and then tighten the screw. Make sure to reinstall the rubber plug.

NOTE: If you tin the wires with solder it will make inserting them easier.

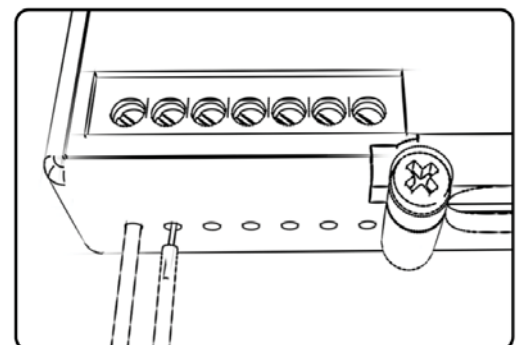

# INSTALLING THE POWER COMMANDER 6



- 1 Remove the seat and solo cover.
- 2 Remove the cover around the fuel tank.
- 3 Remove the fuel tank.

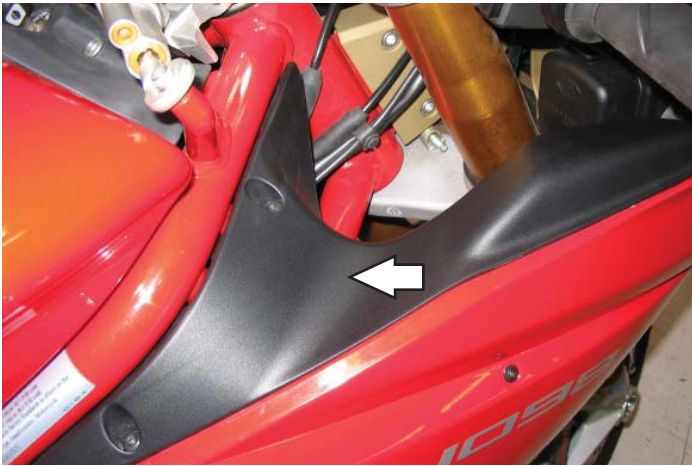

- 4 Remove the inner fairing cover on the right hand side.



- 5 Lay the PC6 in the tail section temporarily.
- 6 Route the PC6 harness through the hole in the tail section.

- 7 Route the PC6 along the right hand side of the subframe. Secure the PC6 harness to the subframe using two of the large supplied zip ties.

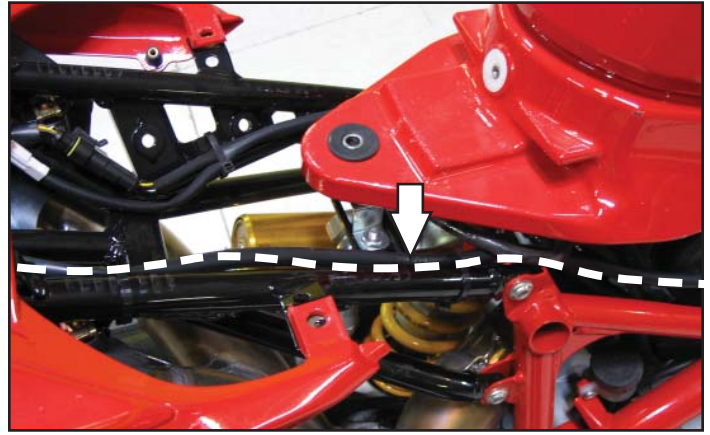

- 8 Unplug the stock wiring harness from the rear fuel injector.

This injector is located on top of the air box.

To remove the connector you must first remove the spring clip. This is best done with a pick or small screwdriver.



- 9 Plug the PC6 leads with YELLOW colored wires from the PC6 in-line of the stock wiring harness and rear fuel injector.

Make sure to reinstall the spring clip on the stock connector.

- 10 Use the smaller supplied zip tie to secure this connection to the fuel line.

Make this connection as compact as possible.

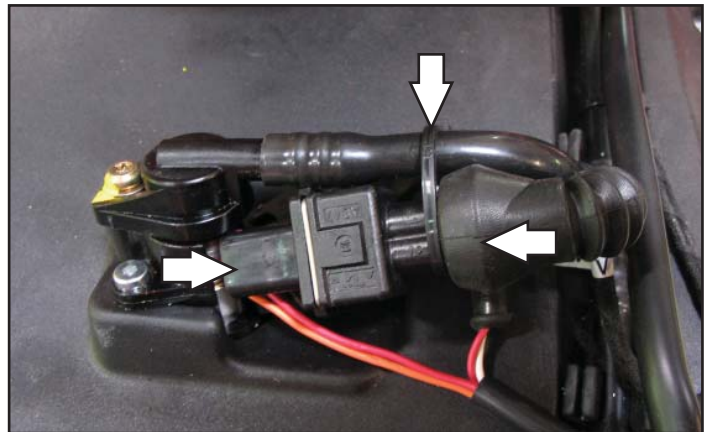

- 11 Unplug the stock wiring harness from the front fuel injector.

This connection is very difficult to access. It is best to get to through the front of the bike directly above the radiator. This image was taken from the front of the bike inside the right hand fairing and above the radiator.





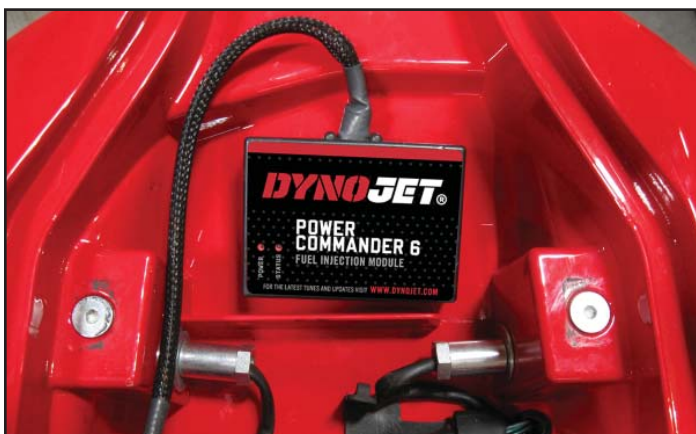
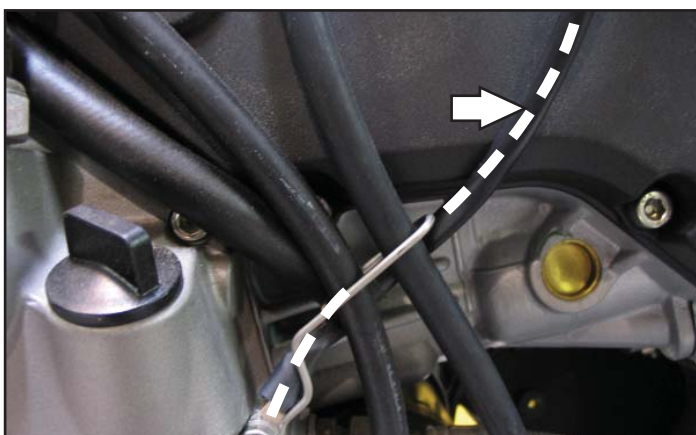
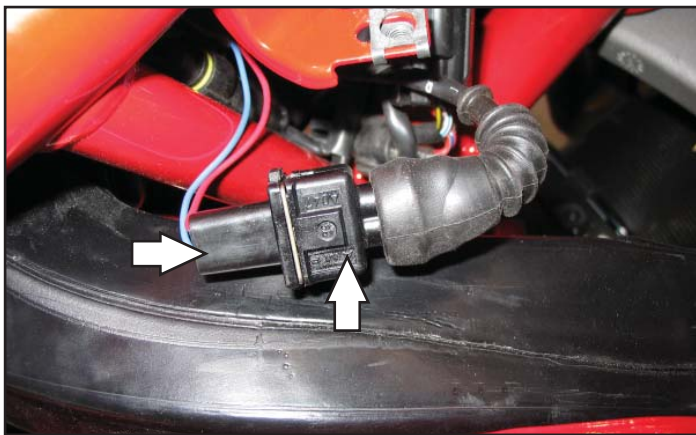

- 12 Plug the pair of PC6 leads with ORANGE colored wires in-line of the front fuel injector and stock wiring harness.
  - 13 Remove the right hand fairing.
  - 14 Route the PC6 harness along the right hand side frame down tube. Use the existing wraps to hold the PC6 harness in place.
  - 15 Locate the Throttle Position Sensor (TPS) on the right hand side of the throttle bodies.
  - 16 Using the supplied posi-tap, attach the PC6 grey wire to the stock orange wire of the bikes TPS (pin position C).
- The wire tap shown is not a posi-tap; it is an older crimp-on style wire tap.
- 17 Attach the ground wire from the PC6 to the right hand engine cover bolt.
  - 18 Reinstall the right hand fairing.

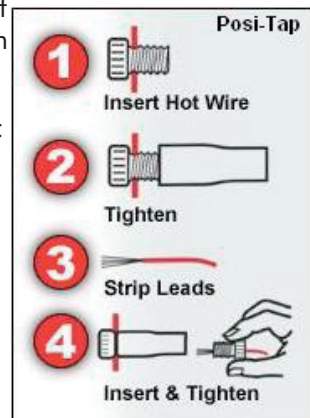

- 19 Using the supplied Velcro, install the PC6 in the tail section.
- Make sure to use the supplied alcohol swab to clean both surfaces before attaching the Velcro.
- 20 Reinstall all of the bodywork, the seat, the solo cover, and the fuel tank. When lowering the fuel tank, make sure it does not interfere with the connection of the rear injector.
- Note:** The PC6 will not be able to make fuel changes below 20% throttle and below 5500 RPM when the bike is in closed loop.

#### Optional Inputs:

**Speed** - grey/white wire of 3-pin connector (grey/white - blue/orange - green)

**Engine Temperature** - white/blue wire - behind battery on front cylinder

**12v Source for Autotune** - Yellow wire of tail light connector - 5-pin connector under the seat

Download the latest map files from our web site at [dynojet.com/tunes](http://dynojet.com/tunes).



# **PUSH THE LIMIT**

**2191 MENDENHALL DRIVE, NORTH LAS VEGAS, NV 89081 - 800-992-4993 - [DYNOJET.COM](http://DYNOJET.COM)  
© 2009-2022 DYNOJET RESEARCH ALL RIGHTS RESERVED**