

# POWER COMMANDER 6

Installation Guide for: PC6-16035

Model Coverage: 2002-2008 Honda VTX1800 Models

## PARTS LIST



- |                      |                          |
|----------------------|--------------------------|
| 1 POWER COMMANDER 6  | 2 POWER COMMANDER DECALS |
| 1 INSTALLATION GUIDE | 2 VELCRO STRIPS          |
| 1 USB CABLE          | 1 ALCOHOL SWAB           |
| 2 DYNOJET DECALS     | 1 POSI-TAP               |

**PLEASE READ ALL DIRECTIONS BEFORE STARTING INSTALLATION.  
THE IGNITION MUST BE TURNED OFF BEFORE INSTALLATION.**



IPC6-16035.01



# INPUT ACCESSORY GUIDE

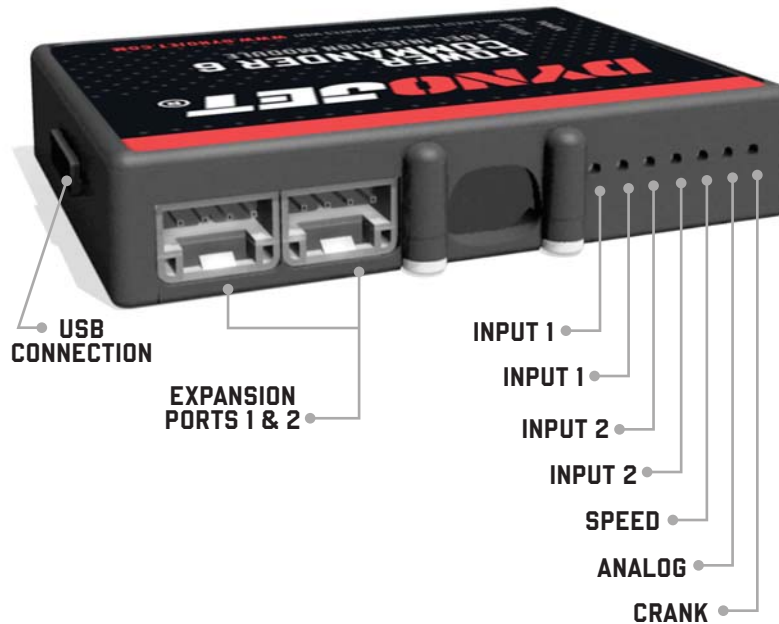

## OPTIONAL ACCESSORY INPUTS

- Map** (Input 1 or 2) The PC6 has the ability to hold 2 different base maps. You can switch on the fly between these two base maps when you hook up a switch to the MAP inputs. You can use any open/close type switch. The polarity of the wires is not important.
- Shifter** (Input 1 or 2) Used for clutch-less full throttle upshifts. Insert the wires from the Dynojet quick shifter into either Input 1 or Input 2. The polarity of the wires is not important. Set to Input 2 by default.
- Speed** If your application has a speed sensor then you can tap into the signal side of the sensor and run a wire into this input. This will allow you to calculate gear position in the Control Center Software. Once gear position is setup you can alter your map based on gear position and setup gear dependent kill times when using a quick shifter.
- Analog** This input is for a 0-5v signal such as engine temp, boost, etc. Once this input is established you can alter your fuel curve based on this input in the Power Core software.
- Launch** You can connect a wire to either Input 1 or Input 2 and then the other end to a switch. This switch when engaged (continuity) will only allow the RPM to be raised to a certain limit (set in the software). When released, you will have full RPM.

## WIRE CONNECTIONS

To input wires into the PC6 first remove the rubber plug on the backside of the unit and loosen the screw for the corresponding input. Using a 22-24 gauge wire, strip about 10mm from its end. Push the wire into the hole of the PC6 until it stops and then tighten the screw. Make sure to reinstall the rubber plug.

NOTE: If you tin the wires with solder it will make inserting them easier.

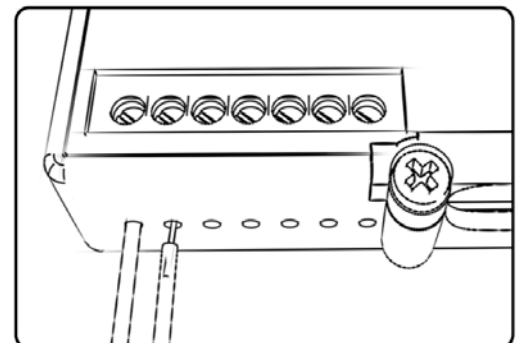

# INSTALLING THE POWER COMMANDER 6



- 1 Remove the seat.
- 2 Remove the air box assembly.
- 3 Remove the fuel tank.
- 4 Remove the left side cover.
- 5 Remove the chrome cosmetic engine cover on the left side of the engine directly below the key switch.



- 6 Using the supplied Velcro, secure the PC6 module behind the left side cover at the location shown.  
  
Clean both surfaces with the supplied alcohol swab prior to applying the Velcro.
- 7 Locate and unplug the stock wiring harness from the bike's Crank Position Sensor.

This is a WHITE 2-pin connector located inside the rubber boot behind the cosmetic chrome left side engine cover.



- 8 Plug the PC6 wiring harness in-line of the stock Crank Position Sensor connectors.
- 9 Reinstall the left side engine cover, making sure the wires do not get pinched.

- 10 Route the remainder of the PC6 wiring harness towards the right hand side of the bike, through the frame, under the fuel tank, and towards the throttle bodies while following the stock wiring harness on the right hand side of the frame as closely as possible.

Make sure the wiring harness is free and clear of any hot or moving parts and that none of the wires will get cut or pinched when the fuel tank is reinstalled. We recommend routing the wiring harness behind the rear coil.



- 11 Locate and unplug the stock wiring harness from the bike's fuel injectors.

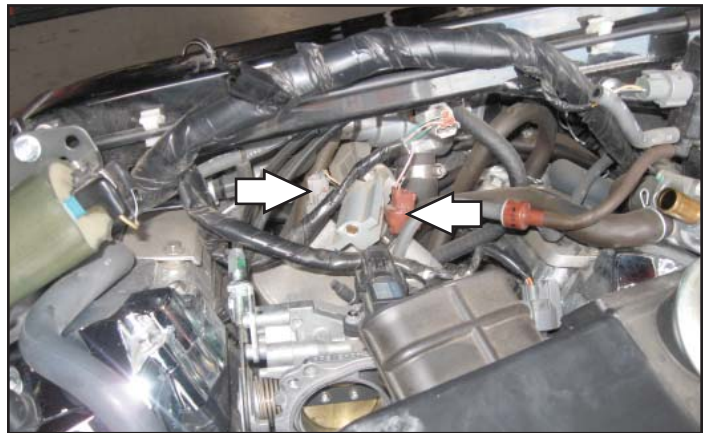

- 12 Plug the PC6 wiring harness in-line of the fuel injectors and the stock wiring harness.

The pair of PC6 connectors with **ORANGE** colored wires go in-line of the **FRONT** cylinder's fuel injector.

The pair of PC6 connectors with **YELLOW** colored wires go in-line of the **REAR** cylinder's fuel injector.



- 13 Locate and unplug the stock wiring harness from the bike's Throttle Position Sensor.

The TPS is located on the front side of the throttle bodies behind the air box.

- 14 Use the supplied Posi-tap to attach the **GREY** wire of the PC6 wiring harness to the stock **RED/YELLOW** wire of the bike's TPS.

- 15 Plug the stock wiring harness back onto the TPS.

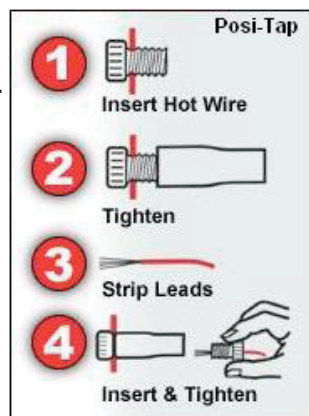



- 16 Locate the Rear Ignition Coil on the right side of the frame.
- 17 Unplug the stock YELLOW/BLUE wire from the ignition coil's GREEN spade terminal.

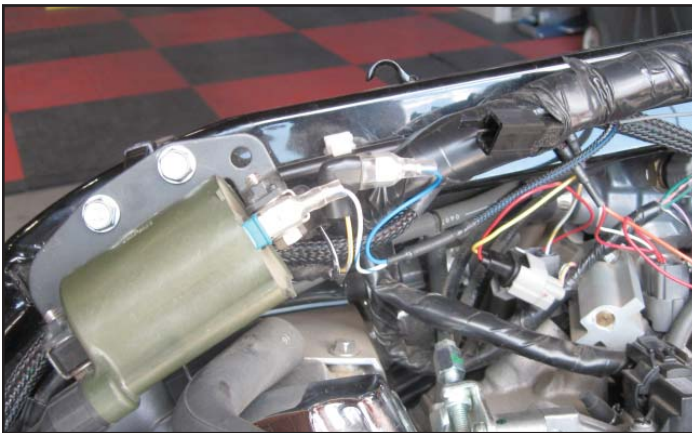

- 18 Plug the pair of BLUE colored wires of the PC6 in-line of the Rear Ignition Coil's GREEN spade and the stock YELLOW/BLUE wire.

- 19 Locate the Front Ignition Coil of the forward left side of the frame.

- 20 Unplug the BLUE/YELLOW wire from the ignition coil's GREEN spade terminal.

- 21 Unplug the BLACK/WHITE wire from the ignition coil's BLACK spade terminal.

- 22 Plug the pair of RED colored wires of the PC6 in-line of the Front Ignition Coil's BLACK spade and the stock BLACK/WHITE wire.

- 23 Plug the pair of GREEN colored wires of the PC6 in-line of the Front Ignition Coil's GREEN spade and the stock BLUE/YELLOW wire.

- 24 Secure the ground wire of the PC6 wiring harness with the eyelet to the common ground location above the Front Ignition Coil.

- 25 Reinstall the fuel tank, body work, and the seat.

**Note:** This unit is shipped with a stock map for the 2002-2004 49 state C model. Make sure to download the correct map for your application and modifications.

Download the latest map files from our web site at [dynojet.com/tunes](http://dynojet.com/tunes).

#### Optional Inputs:

**Speed Input** - PINK/GREEN wire of the ECM.

**Temp Input** - PINK/WHITE wire of the ECM.

**12v Source for Autotune** - BLACK/BROWN wire of the tail light.





# **PUSH THE LIMIT**

**2191 MENDENHALL DRIVE, NORTH LAS VEGAS, NV 89081 - 800-992-4993 - [DYNOJET.COM](http://DYNOJET.COM)**  
**© 2002-2022 DYNOJET RESEARCH ALL RIGHTS RESERVED**