

Thank you for purchasing a National Cycle product. Read these instructions carefully and thoroughly before beginning work. Dealers, if installing this windshield for a customer, please give them this manual upon completion. It contains information needed to properly maintain and use this product.

N5150 PARTS LIST

ITEM	PART NO.	DESCRIPTION	QUANTITY
A	20-290809-000	Wing Deflector; 3.0mm Polycarbonate; Right	1
B	20-290808-000	Wing Deflector; 3.0mm Polycarbonate; Left	1

TOOLS REQUIRED

8mm Socket with 4-Inch Extension
5mm Allen Wrench
3mm Allen Wrench
Small Flat Blade Screwdriver

IMPORTANT

These Wing Deflectors are designed to work in conjunction with National Cycle's N20019 VStream+® Deluxe Mid Windscreen or N20020 VStream+® Deluxe Standard Windscreen. They will not work with the stock windscreen or with other aftermarket windscreens.

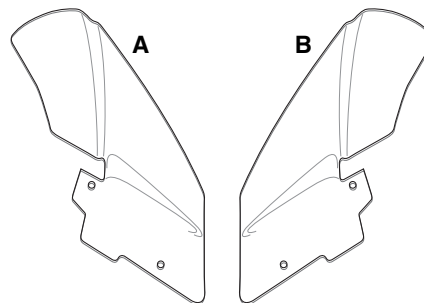

PREPARATION

Put your motorcycle on its centerstand to make it easier to work on both sides. Turn on the bike's ignition and raise the windshield to its highest position, then turn ignition off.



Figure 1

INSTALLATION

Figure 1

Each rearview mirror/turnsignal assembly has a 5mm Allen Screw on the bottom. Remove these and set them aside.

Figure 2

Move (pivot) each rearview mirror/turnsignal assembly forward.

Figure 3

Remove the plastic bracket (Mirror Arm Panel) under each rearview mirror/turnsignal assembly's mounting fixture by pulling it outwards and off.



Figure 2

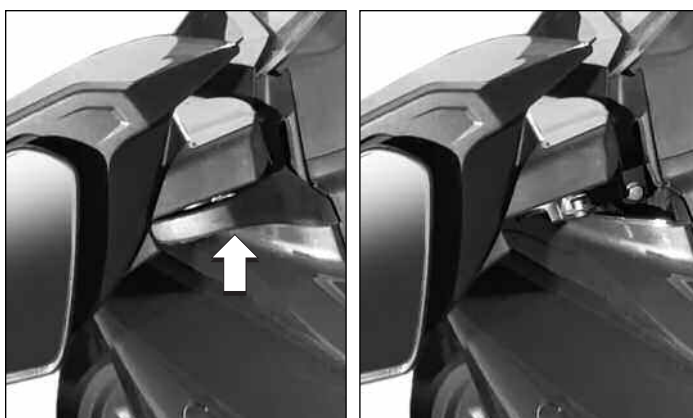

Figure 3

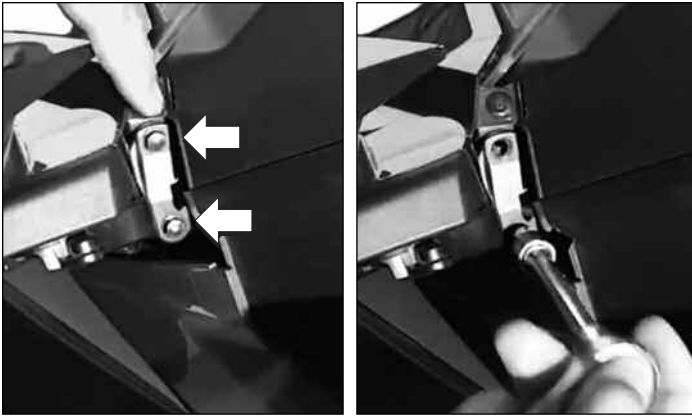

Figure 4

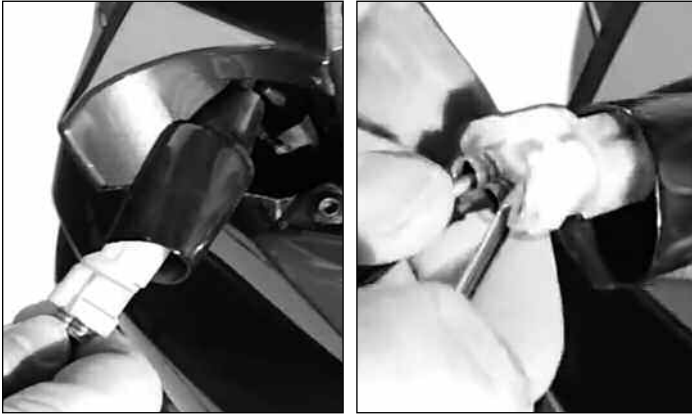

Figure 5

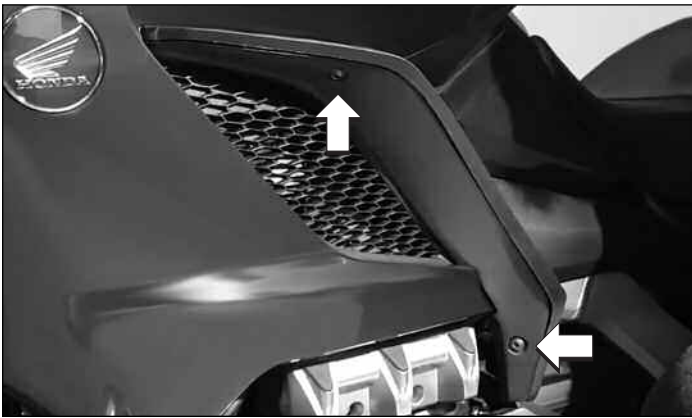

Figure 6a

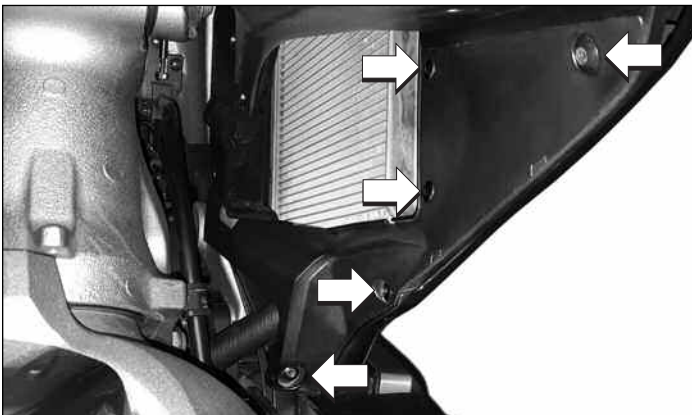

Figure 7a

INSTALLATION; CONT'D.

Figure 4

Using an 8mm socket and a 4-inch extension, remove the two 8mm Bolts on the rearview mirror/turnsignal assembly mounting fixture. Hold onto the mirror when removing these, then just let the mirror hang by its wiring.

Figure 5

Pull the wiring harness out from inside the fairing. Push back the rubber boot from the harness couplers. Using a small flat blade screwdriver, push the locking tab to separate the male/female couplers. Set the two rearview mirror/turnsignal assemblies aside.

Figures 6a, 6b

The outer vent panels on both sides of the bike have a trim piece held on by two 5mm Allen Screws. Remove these screws. Then grab the rear section of the trim piece and pull it outward. Progress toward the front end of the trim piece, gradually pulling it loose from the vent panel. Set these trim pieces aside.

Figures 7a, 7b

Inside of the side fairings, above the front fender, each side fairing panel is secured by two 5mm Allen Screws and three press-fit Body Pins (Honda calls them Bumper Seal Clips).

Remove the 5mm Allen Screws. Then, using a 3mm Allen Wrench, push on the center of the head of each Body Pin until you hear it pop. Then the Body Pin can be withdrawn.



Figure 6b



Figure 7b



Figure 8a



Figure 8b

INSTALLATION; CONT'D.

Figures 8a, 8b

Return to the rearview mirror/turnsignal mount area. You will see a 5mm Allen Screw securing the side fairing panel. Remove these on both sides of the bike.

Next, where you previously removed the outer vent panel trim, you will see a press-fit Body Pin securing the side fairing panel. Remove these on both sides, and set all hardware aside.



Figure 9

Figure 9

On the left side of the bike, starting at the upper rear of the side fairing panel, pull the side fairing panel outward and forward, releasing its retaining pins from the grommets on the frame.

Continue along the upper edge of the panel in counter-clockwise direction, progressively removing the panel from its retaining grommets until fully released. Set the side fairing panel aside and repeat the procedure on the right side of the motorcycle.

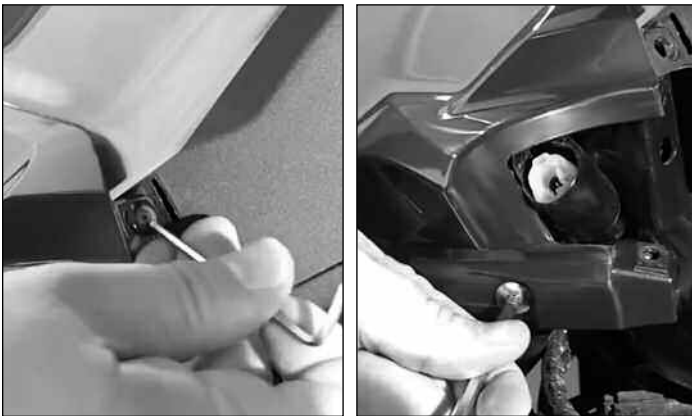

Figure 10

Figure 10

Now you will remove the front cowl. At the upper rear of the cowl on both sides, above the mirror mount area, is a press-fit Body Pin. Push the center of the head with a 3mm Allen Wrench until you hear it pop, then remove it.

Then, just below the mirror mount area, there is a 5mm Allen Screw retaining the cowl on both sides. Remove these screws and set them aside.

Figure 11

The front cowl is now held to the bike with three large retaining pins secured to three large retaining grommets; one on each lower side of the Honda nameplate, and one on the very bottom point.

Grasp the top of the cowl behind the nameplate and pull it loose from the two grommets. Swing it forward and pull it loose from the very bottom grommet. Set the cowl aside.



Figure 11



Figure 12

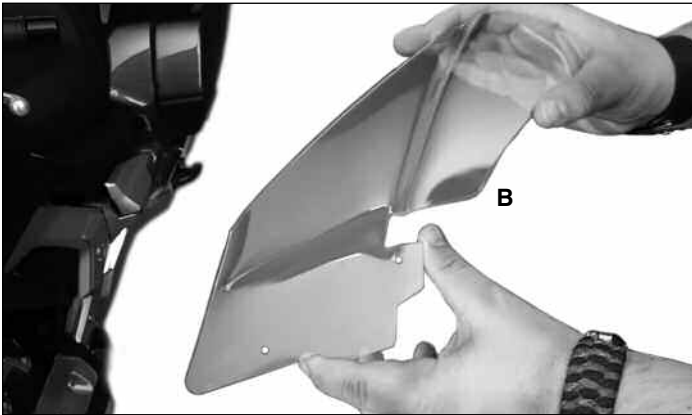

Figure 13



Figure 14a

INSTALLATION; CONT'D.

Figure 12

Now you will remove the stock deflectors (Windscreen Inner Flaps). Each is secured to the bike with two 3mm Allen Screws. Remove these screws and set them aside.

Figure 13

Differentiate the right side Wing Deflector (**A**) and the left side Wing Deflector (**B**).

Figures 14a, 14b

Install the new Wing Deflectors with the same 3mm Allen Screws removed in Figure 12.

NOTE: Do not push too hard on these screws until you're certain the threads in the Wellnuts have been captured. Otherwise you will push the Wellnuts into the fairing interior where they can't be retrieved.



Figure 14b

REASSEMBLY

With the new Wing Deflectors installed on both sides of the bike, reinstall the front cowl, the fairing side panels, and the outer vent panel trim using the same 5mm Allen Screws and press-fit Body Pins removed earlier.

For each rearview mirror/turnsignal assembly, reconnect the male/female wiring harness and the two 8mm Bolts. Push the wiring harness back inside the fairing. Reinstall the plastic brackets (Mirror Arm Panels) with their original 5mm Allen Screws.

Double-check that everything is tight and secure, and that you do not have any screws or body pins left over.

Now ride your bike in greater comfort.



Ask for Shield Wash™ and RainZip® at your local dealer or visit www.nationalcycle.com.

CLEANING AND MAINTENANCE

To clean your windshield, wash with a clean soft cloth and plenty of warm water and, if necessary, a non-abrasive soap such as dishwashing liquid. Flannel or soft cham-
ois make good cleaning cloths. **Paint, glue residue or grease removal:** Moisten cot-
ton wad with naphtha or turpentine followed by a wash as above.

National Cycle **Shield Wash™** (N1401-01) makes a good daily cleaner and comes with a handy travel-size bottle. Shield Wash is safe for all windshields and helmet visors.

Do not clean polycarbonate in hot sun or high temperatures. Do not clean the screen with household glass cleaners.

Do not allow brake fluid, alcohol, or strong solvents to contact the windshield.

RAIN REPELLENT

Do not use rain protective products made for glass. We recommend National Cycle's **RainZip®** (N1410-01) to keep your windshield clear in rainy weather.



National Cycle 3-Year Limited Warranty

Register Your Windshield Online at www.nationalcycle.com

National Cycle hereby warrants to the original registered owner of a National Cycle polycarbonate windshield or accessory for a period of three years from the date of purchase against breakage. This limited warranty is expressly limited to the replacement of the polycarbonate windshield. This limited warranty does not include scratches, coating failure, cosmetic wear and tear, replacement of hardware, or any consequential damages or expenses including labor cost of installation, removal and/or replacement, inconvenience, inbound freight expenses or damage to any other component of the vehicle or any other accessories. Certain chemicals, generally known as acidic hydrocarbons, are known to cause polycarbonate damage and will not be covered under this limited warranty. Please refer to the cleaning instructions supplied with all National Cycle windshields. Visit www.nationalcycle.com for further details or call or write National Cycle Inc.

! WARNING

Never ride your motorcycle with loose accessory mounting hardware. Check the hardware for tightness regularly.

Today's motorcycles are built with enough frame rigidity to withstand the moderate loads imposed on them by the foreseeable addition of an accessory(ies). If an accessory(ies) adversely affects your motorcycle's stability, immediately remove the accessory(ies). Do not ride a motorcycle that exhibits unsafe handling traits.

Have experienced service personnel correct any problem before riding with the accessory(ies) installed. For further questions concerning handling problems associated with an accessory(ies), contact your dealer, motorcycle manufacturer, or accessory manufacturer.

Sunlight reflected off the inside curvature of the windscreen can, at certain times of day, cause extreme heat buildup on the motorcycles instruments and possibly even melt them. Exercise care in parking to avoid this. Park your motorcycle facing the sun or place an opaque object over this area.