



Installation Instructions

27-5385BSuperbike Lifter Hooks – Ninja400, Z400

IMPORTANT - USE BLUE LOCTITE on all bolts

Swingarm chain adjustment plate orientation

- 1) Loosen axle nut enough that both the RHS and LHS adjustment plates can clear the swingarm and rotate.
- 2) Flip the adjustment plates 180 degrees so that the point faces the front of the bike. This will give the lifter room to rest against the bottom of the swingarm
- 3) Tighten the axle as you normally would. Ensure that the axle adjustment plates are in alignment and chain tension is to your liking.



Without Optional Slider Pucks

- 1) Place the stainless-steel insert, with the hole in the up position, into the 27-0300 back aluminum hook. Lightly bolt the hook to the 8mm spool receiver to the swingarm using the 8x20mm flat head countersunk bolt and secure with Blue Loctite.
- 2) Attach the eccentric spacer 27-6ESP to the back side of the hook using the supplied 6x25mm button head bolt (use Blue Loctite). As you tighten the bolt, rotate the eccentric spacer so that **both** the spacer and the machined stop on the back side of the hook are seated firmly against the swingarm.
- 3) Torque (appx 18ft-lbs) the 8x20mm flat head bolt.



With Optional Slider Puck Set (27-5899)

- 1) Lightly bolt the hook to the swingarm using the 8x25mm button head bolt. The bolt should first pass through the 27-8095H hex spacer and then through the 27-7080 Insert, with hole in the up position. Use Blue Loctite.
- 2) Attach the eccentric spacer to the back side of the hook as described in step 2 above.
- 3) Perform a final torque (appx 18 ft-lbs) on the 8x25mm bolt. Install the 45-1099 puck on the hex spacer using the 45-5099 quick release pin.

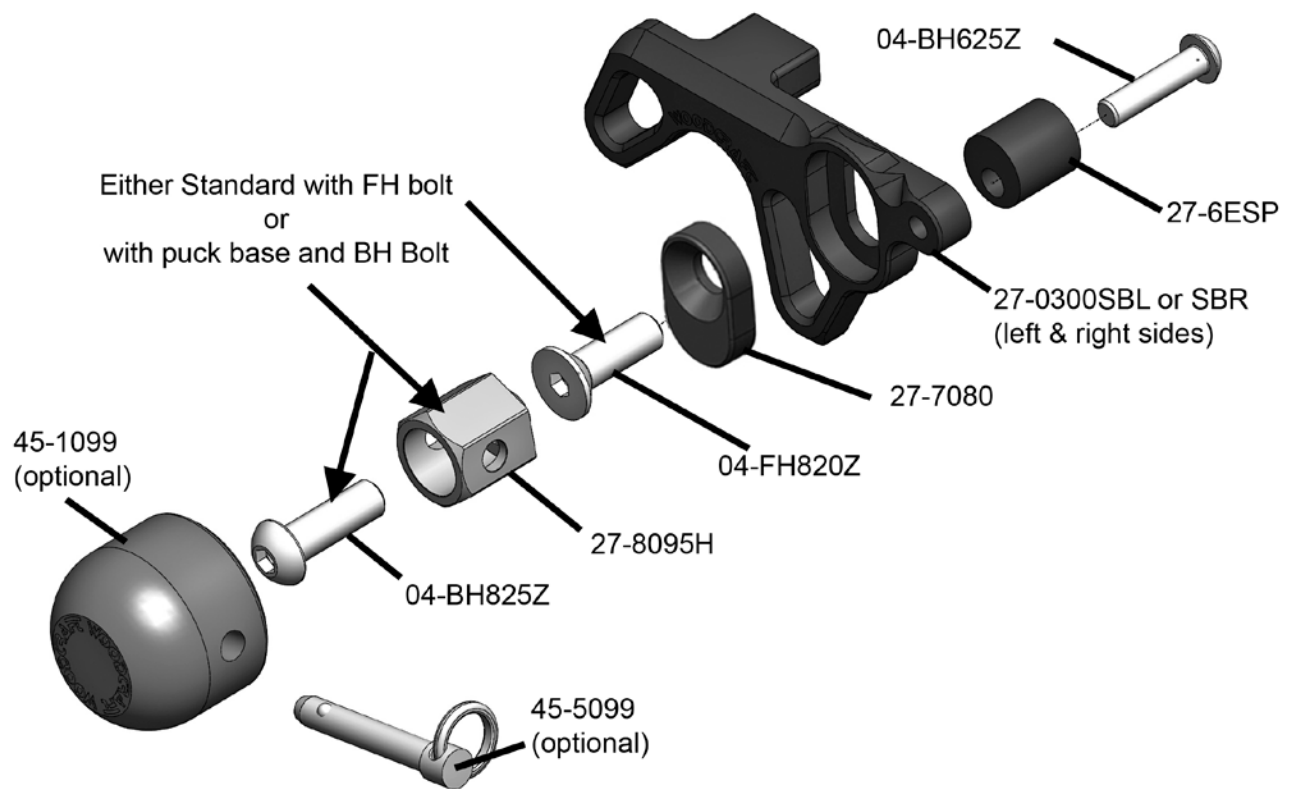

WARNING: Improper installation and/or failure to comply with all warnings and instructions may cause a loss of control and serious injury or death. The motorcycle should be run and thoroughly inspected before use. **DO NOT INSTALL OR USE THIS PRODUCT IF YOU ARE UNABLE TO DO SO IN COMPLIANCE WITH ALL INSTRUCTIONS AND WARNINGS. ALWAYS SEEK THE ASSISTANCE OF A TRAINED PROFESSIONAL TECHNICIAN.**