

POWER COMMANDER FC

2010-2013 BMW S1000RR

Installation Instructions



Parts List

- 1 Power Commander FC
- 1 USB Cable
- 1 Installation Guide
- 2 Dynojet Decals
- 2 Velcro
- 1 Alcohol swab
- 2 Posi-tap

**THE IGNITION MUST BE TURNED
OFF BEFORE INSTALLATION!**

YOU CAN ALSO DOWNLOAD THE PCFC
CONTROL CENTER SOFTWARE AND
LATEST MAPS FROM OUR WEB SITE AT:
www.powercommander.com

PLEASE READ ALL DIRECTIONS BEFORE STARTING INSTALLATION

Dynojet

2191 Mendenhall Drive North Las Vegas, NV 89081 (800) 992-4993 www.powercommander.com

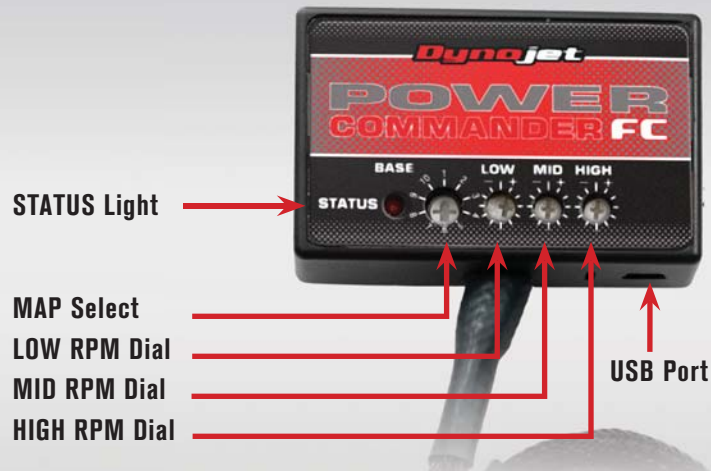

Position	Note
Position 1	2010 BMW S1000RR Stock exhaust Stock or aftermarket air filter
Position 2	2012-2013 BMW S1000RR Stock exhaust Stock or aftermarket air filter

SELECTING THE MAP POSITION

The Dynojet Power Commander Fuel Controller (PCFC) comes loaded with up to ten maps. Using a #1 Phillips screwdriver, turn the map select dial to toggle between the loaded maps. Refer to the map position table for the maps included in your PCFC.

USING THE RPM RANGE DIALS

The Low, Mid, and High RPM Dials refer to the RPM range, in thirds, of your vehicle. Each dial allows +/- 10% fuel adjustment on top of what fuel changes are done in the map. With the dial facing straight up, there is no additional fuel change.

For example, if your vehicle revs to 6000 RPM:

- The low RPM dial will adjust 0-2000 RPM
- The mid RPM dial will adjust 2001-4000 RPM
- The high RPM dial will adjust 4001-6000 RPM

USING PCFC CONTROL CENTER

Take your tuning to the next level with the PCFC Control Center software.

- 1 Using your web browser, navigate to www.powercommander.com.
- 2 Click Enter Race Ready.
- 3 Click Downloads.
- 4 Click Access Downloads for Power Commander FC.
- 5 Click the PCFC software Download button.
- 6 Open the zip folder.
- 7 Double-click the install file and follow the on-screen instructions to install the PCFC Control Center software. The PCFC Control Center software and maps will be stored in C:\Program Files\PCFC Control Center.
- 8 Return to the Downloads or Home page where you can enter the make, model, and year of your bike to check for and download additional maps.

LOADING ADDITIONAL MAPS

- 1 Connect the USB cable from the computer to the PCFC. Verify the cable is fully seated in the PCFC.
- 2 Run the Control Center software by double-clicking the program icon installed on your desktop or on your start menu.
- 3 Click Open Map File and select a map file.
- 4 Click Send Map. You can send the map to any of the ten map positions.

ALTERING MAPS USING SOFTWARE

The values in the map represent a percentage of fuel change over stock. A value of 10 in the map indicates at that throttle position and RPM range the vehicle will be 10% richer than stock. If the value is -10, then it would be 10% leaner than stock. You have the ability to fine tune your fuel curve by altering these values. The Control Center software allows a value of +250 to -100 in each cell.



- 1 Remove the seat.
- 2 Remove the fuel tank covers as shown in Figure A.
- 3 Remove the fuel tank or prop it up out of the way.
- 4 Remove the left and right side fairings.



- 5 Using the supplied velcro, secure the PCFC inside the tail section as shown in Figure B.
Make sure to clean both surfaces with the alcohol swab before attaching.

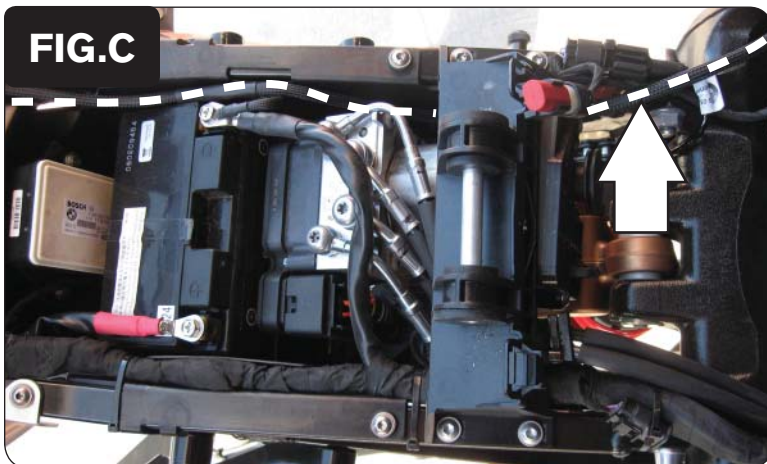

- 6 Route the PCFC harness down the left side of the bike.
- 7 Route the harness underneath the fuel tank bracket and go towards the throttle bodies as shown in Figure C.
- 8 Attach the ground wire from the PCFC harness to the negative side of the battery.

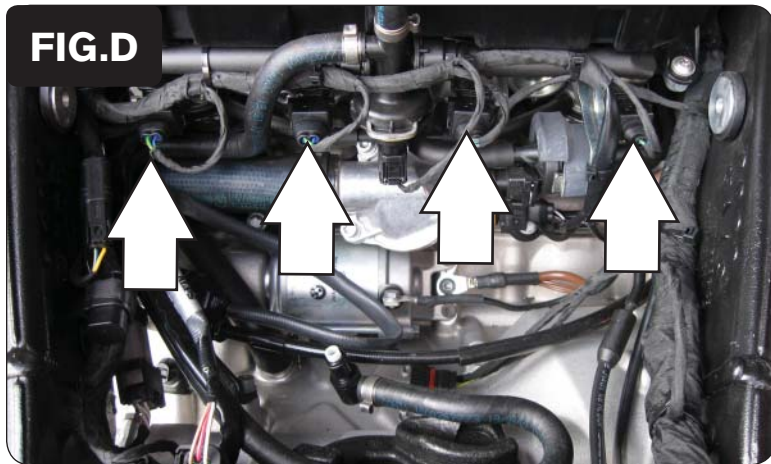

9 Unplug the stock wiring harness from each injector as shown in Figure D.

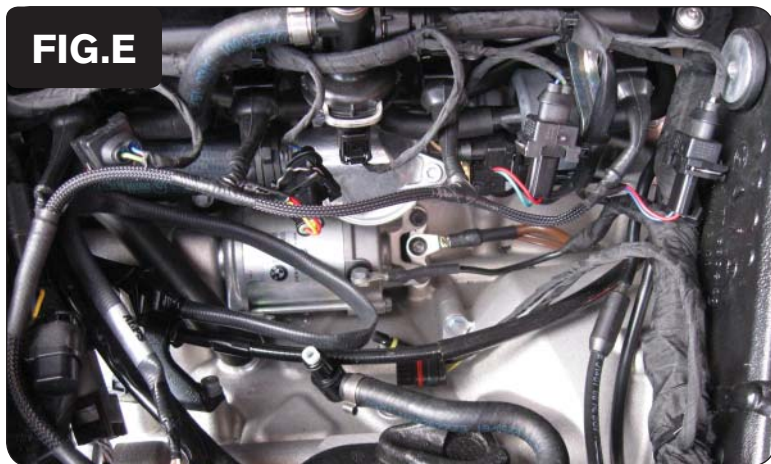

10 Attach the connectors from the PCFC to the stock wiring harness and injectors as shown in Figure E.

Connect the orange colored wires to cylinder #1.
 Connect the yellow colored wires to cylinder #2.
 Connect the green colored wires to cylinder #3.
 Connect the blue colored wires to cylinder #4.

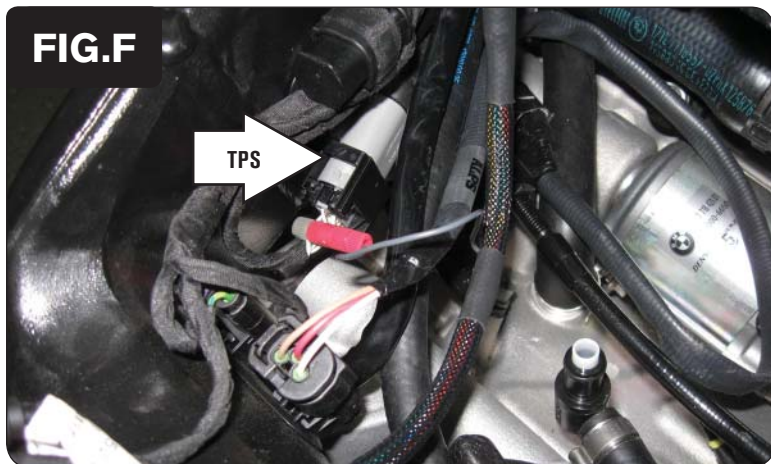

11 Locate the throttle position sensor connector from the throttle blade on the left, inside of the frame as shown in Figure F.

12 Using the supplied posi-tap, attach the grey wire from the PCFC to the white/grey wire on the TPS connector as shown in Figure F.

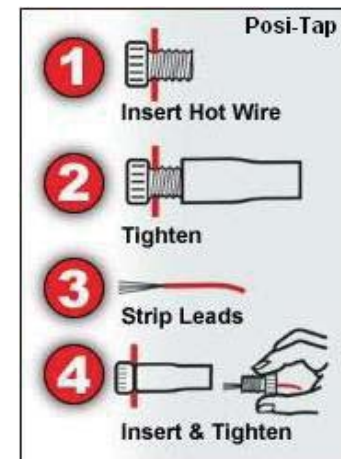



- 13 Unplug the stock O2 sensor on the left side of the engine as shown in Figure G.

The stock O2 sensor will no longer be connected to anything. It can be removed from the exhaust if desired assuming you have a way to plug the hole.

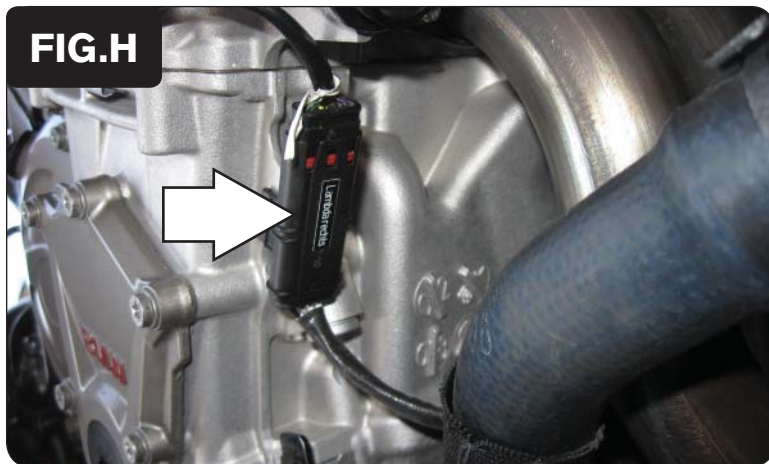

- 14 Unplug the stock O2 sensor on the right side of the engine as shown in Figure H.

The stock O2 sensor will no longer be connected to anything. It can be removed from the exhaust if desired assuming you have a way to plug the hole.

- 15 Reinstall the left and right side fairings, fuel tank, and seat.