



# YOSHIMURA

RESEARCH&DEVELOPMENT OF AMERICA, INC.

5420 DANIELS STREET STE A, CHINO CA., 91710 · (800)634-9166 · (909)628-4722 · FACSIMILE (909)591-2198

[www.yoshimura-rd.com](http://www.yoshimura-rd.com)

## TRC PERFORMANCE EXHAUST SYSTEM

**YAMAHA**  
**2006-2012**  
**FZ1**

**13210E0220**

R77 SLIP-ON W/ CARBON FIBER SLEEVE; CF ENDCAP

**13210E0520**

R77 SLIP-ON W/ STAINLESS STEEL SLEEVE; CF ENDCAP

**13210E0550**

R77 SLIP-ON W/ STAINLESS STEEL SLEEVE; SS ENDCAP



This product is 50-state legal and complies with Federal and State regulations. Any attempts to modify this product will render it non-compliant with Federal law and void warranty. If modified, the vehicle can no longer be used on public roads and can only be used for off-highway closed course competition. In the state of California, it is illegal to modify the emission control system, which includes the fuel injection system of any vehicle.



**Caution:** Exhaust system can be extremely hot. Let motorcycle cool down before beginning installation.

**Note:** Read through all instructions before beginning installation.

## Tools Needed:

11mm, 12mm, and 14mm sockets  
3/8" ratchet and extension  
Torque wrench  
8mm and 10mm wrench  
5mm Allen wrench

## Installation Steps:

1. Place motorcycle on it's centerstand.
2. Remove passenger and rider seats.
3. Carefully remove the rubber stopper from the centerstand and install it onto the Yoshimura tailpipe (see Fig 1 and Fig 2).

**\*\* NOTE:** When installing the rubber stopper the use any type of lubricant will make the installation of the stopper easier.

4. Locate and remove the cover shielding the exhaust valve by removing the two 5mm Allen head bolts (see Fig 3).
5. Loosen and remove both cables from the exhaust valve by loosening the lock nuts (see Fig 4).
6. Locate the exhaust valve controller at the rear of the fuel tank and remove the exhaust valve controller by removing the one nut holding it in place. Remove the shield and cables from the exhaust controller. Remove the exhaust valve cables from the motorcycle. Reinstall the shield and exhaust valve controller back into the stock location (see Fig 5).

**NOTE:** Do not disconnect any electrical wires from the exhaust valve controller. The exhaust valve controller must remain plugged in electrically. Remove the exhaust valve cables only.

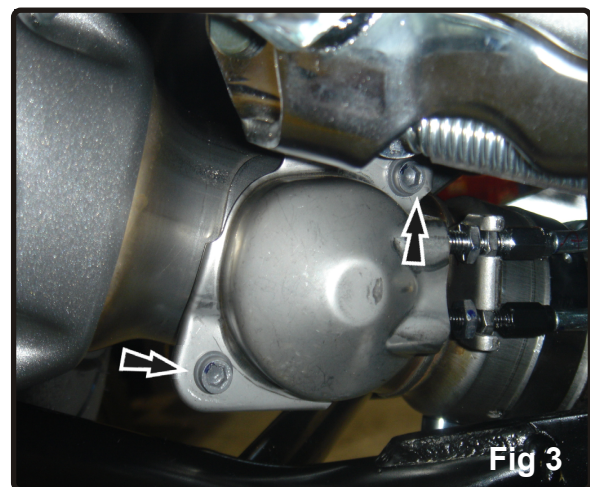
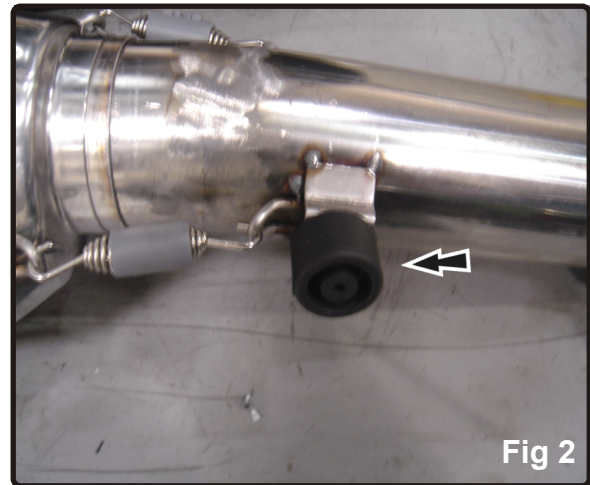
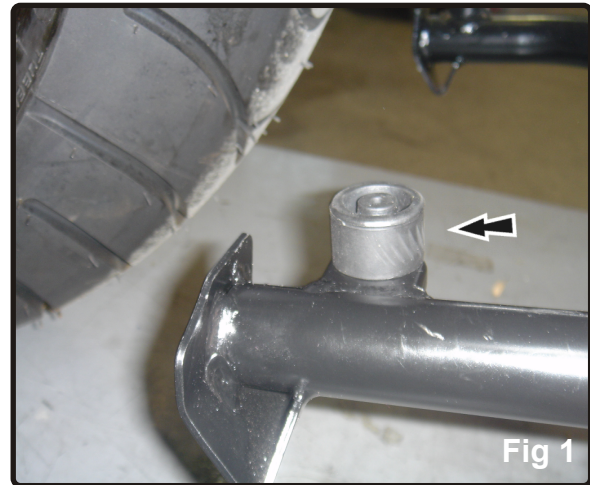

7. Loosen lower stock muffler clamp (see Fig 6).
8. Remove the stock upper muffler mounting bolt and remove stock muffler (see Fig 7).
9. Install exhaust clamp heatshield into exhaust clamp. Install exhaust clamp onto Yoshimura muffler.
10. Slide supplied exhaust clamp over the end of the tailpipe.
11. Install Yoshimura muffler and tailpipe onto the stock header and using the stock and supplied hardware, Torque the muffler mounting bolt to 2.5kg-m (18 lb-ft) (see Fig 8).
12. Torque Yoshimura's exhaust clamp to 1.25 kg-m (9 lb-ft) (see Fig 9).
13. Before starting motorcycle, check for proper clearance between new exhaust system and motorcycle (i.e. radiator, oil pan, swing-arm, etc.). If any problem is found, please carefully follow through the installation steps again. If problem still persists, please call Yoshimura technical department at (800)634-9166 / in CA (909)628-4722.

**Note:** After starting motorcycle, it is normal for new exhaust system to smoke until oil residue burns off.

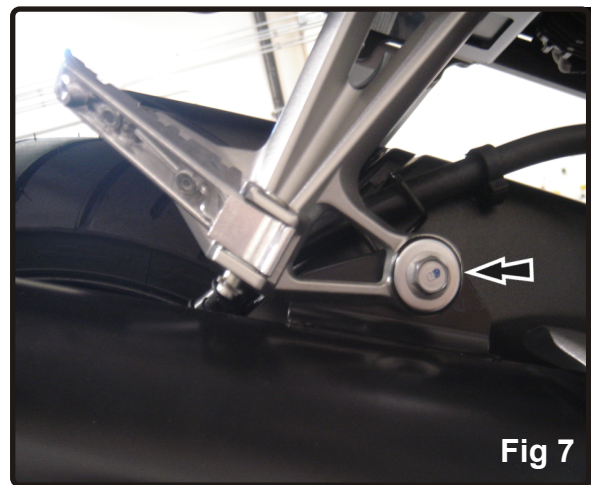
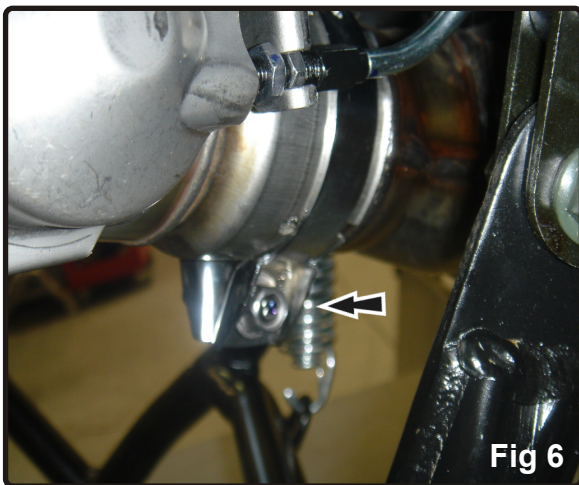
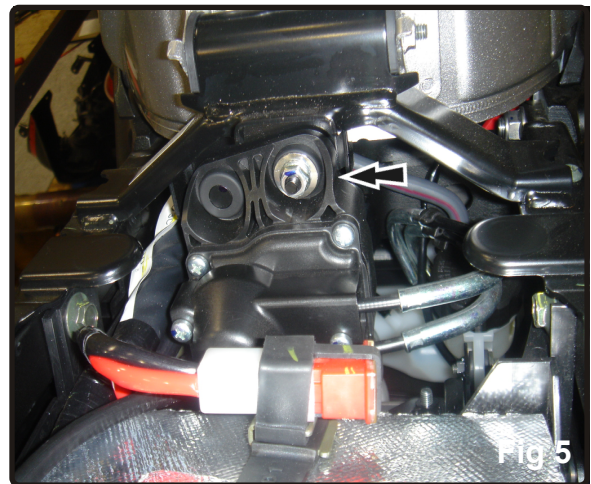
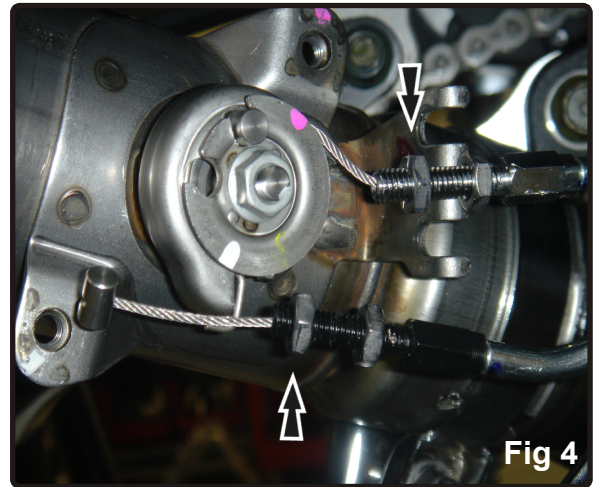

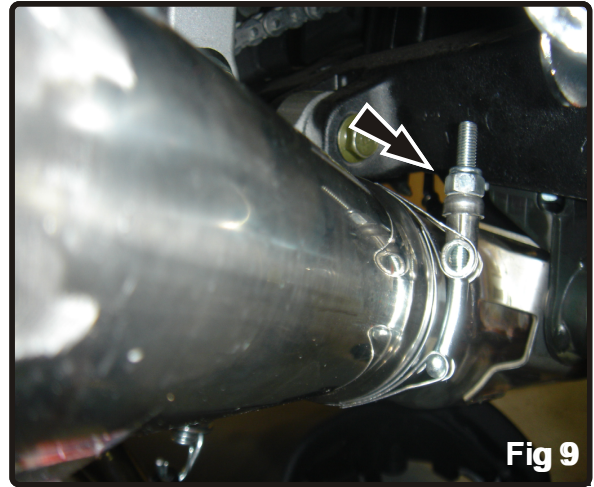

**#13210E0(220,520,550)**

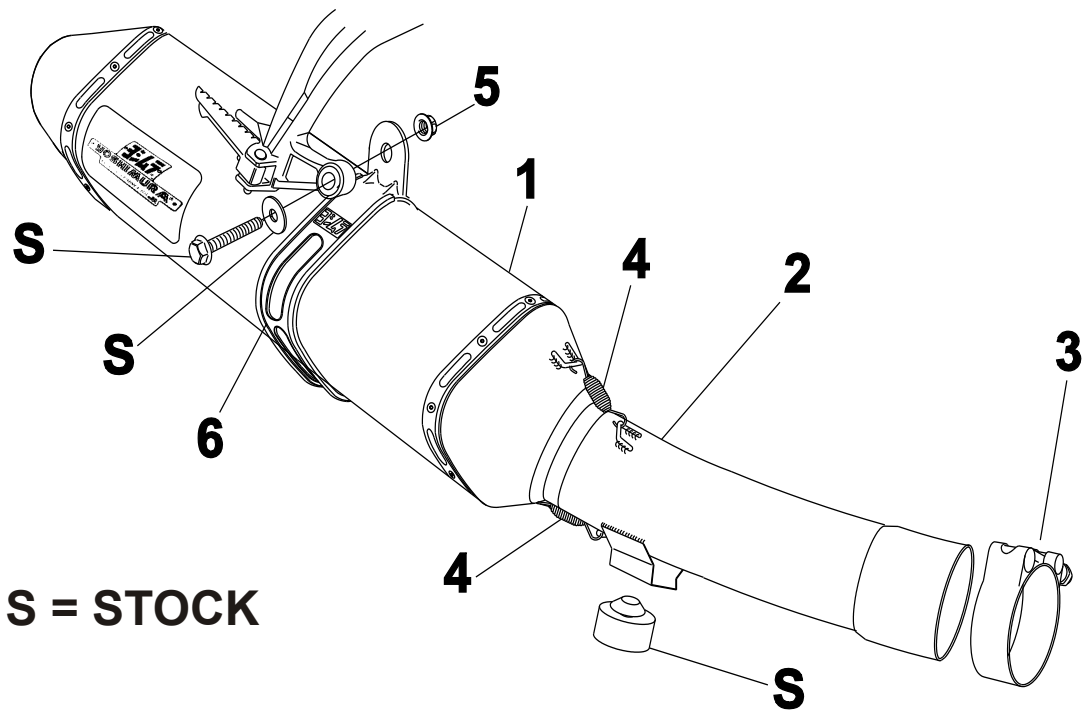

Parts Diagram

<b>NO.</b>	<b>DESCRIPTION</b>	<b>QTY</b>	<b>PART #</b>
1	Yoshimura R77 Muffler Carbon Fiber Sleeve; CF Endcap Stainless Steel Sleeve; CF Endcap Stainless Steel Sleeve; SS Endcap	1	N/A
2	Yoshimura Tailpipe	1	1321-435
3	Exhaust Clamp	1	20069
4	Medium Exhaust Springs	2	RACE-82MM
5	10mm Nut	1	10MMFNUT
6	Muffler Clamp Stainless Steel Sleeve Carbon Fiber Sleeve	1	1426-MPCR 1426-MPCR
**	Slotted Heatsheid R77	1	HT SHLDR77
**	Yoshimura Spring Puller Tool	1	ST-200
**	Yoshimura Sticker Sheet	1	17029