

PLACA FRONTAL PARA - FRONT PLATE FOR - FRONTPLATTE FÜR DUCATI SCRAMBLER DESERT SLED

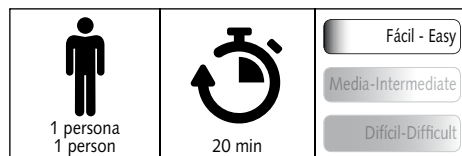

Ref.: 9522 J
(color negro / black colour)

Ref.: 9522 C
(color carbono / carbon look)

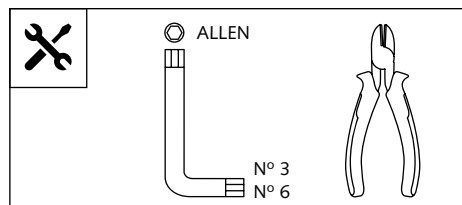

| ID | PIEZA / PART | DESCRIPCIÓN | DESCRIPTION | QTY | REF. |
|----|--------------|---|--|-----|-----------------|
| 1 | | Placa frontal ABS | ABS front plate | 1 | 10549C/JM3 |
| 2 | | Soporte metálico derecho (R) | Right metal support (R) | 1 | SOPOR-2P-8-9522 |
| 3 | | Soporte metálico izquierdo (L) | Left metal support (L) | 1 | SOPOR-2P-8-9522 |
| 4 | | Separador de silicona Ø8x2mm (se suministra montada con las pieza 1) | Ø8x2mm silicone tear (supplied already mounted on item 1) | 3 | ADHESI-GT-D8--- |
| 5 | | Separador de silicona Ø12,5 x 4mm | Ø12,5 x 4mm silicone tear | 1 | TOPE-PA12,7X3,5 |
| 6 | | Casquillo Øint. 8,5 X Øext. 13 X 15 mm | Øint. 8,5 X Øext. 13 X 15 mm arrowhead | 2 | CASQUI-M----614 |
| 7 | | Tornillo Allen M8x40 DIN912 | M8x40 DIN912 Allen screw | 2 | TORNI-D912-475 |
| 8 | | Silentblock M5 | M5 silentblock | 2 | SILENBTM5-046/1 |
| 9 | | Tornillo Allen M5x15 Ø11 ISO7380 | M5x15 Ø11 ISO7380 Allen screw | 2 | TORNI-I7380-493 |
| 10 | | Arandela de Nylon M5X1 | M5X1 Nylon washer | 2 | ARNV00000000245 |
| 11 | | Tapón tornillo M5 ISO 7380 | M5 ISO 7380 Allen screw cap | 2 | TAPON-----85 |
| 12 | | Ribete autoadhesivo longitud de 210mm, 8mm, espesor 5mm | Self-Autoadhesive Trim length 210mm , 8mm, thickness 5mm | 1 | PERFIL-PVC-1048 |
| 13 | | Abrazadera cables negra de 3,6x142 | 3,6x142 cable ties | 1 | BRIDAN142X3.6-N |
| 14 | | Kit adhesivos | Stickers set | 1 | ADHESI-----242 |

PLACA FRONTAL PARA - FRONT PLATE FOR - FRONTPLATTE FÜR
DUCATI SCRAMBLER DESERT SLED

INSTRUCCIONES DE MONTAJE - MOUNTING INSTRUCTIONS - MONTAGEANLEITUNG

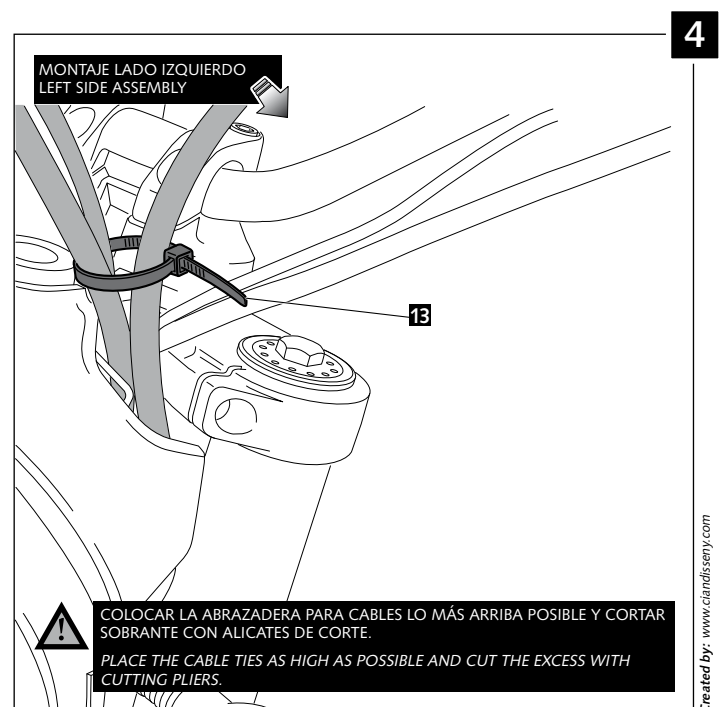
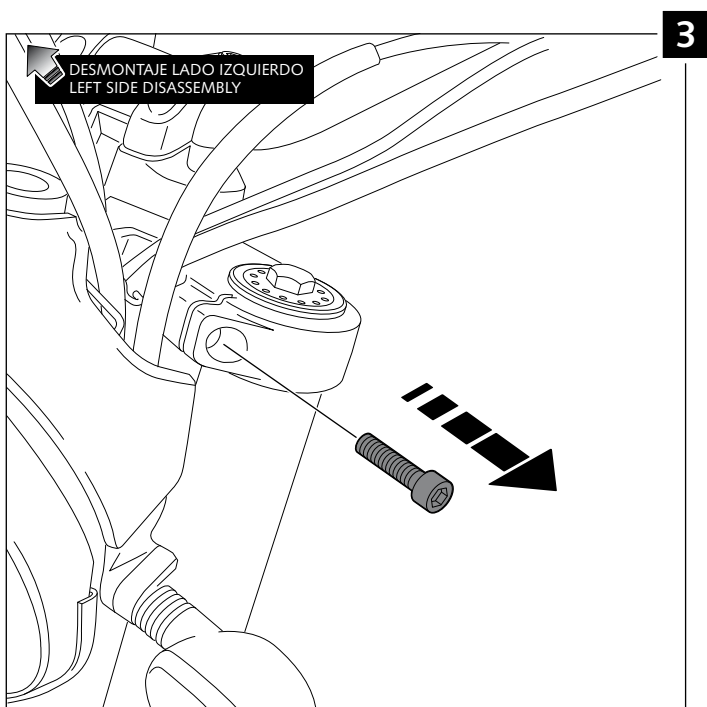
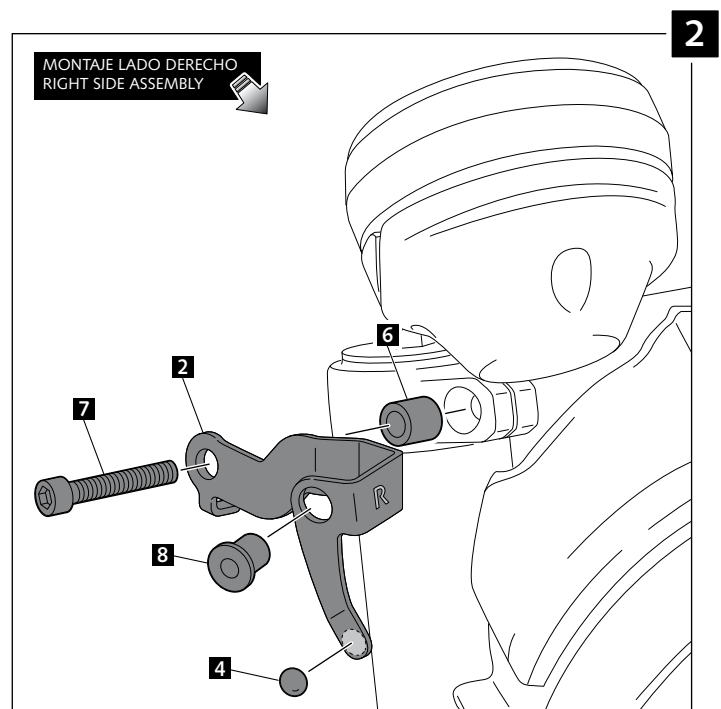
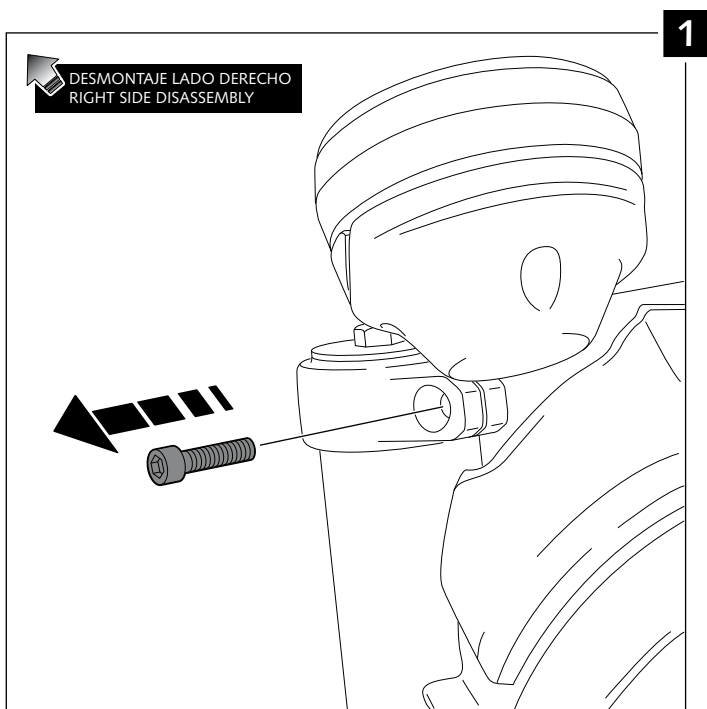

PLACA FRONTAL PARA - FRONT PLATE FOR - FRONTPLATTE FÜR
DUCATI SCRAMBLER DESERT SLED

INSTRUCCIONES DE MONTAJE - MOUNTING INSTRUCTIONS - MONTAGEANLEITUNG

