

V3 FRAME SLIDERS KIT 2.0

**KAWASAKI ER 6 F**

year of production: '12-

product code: SR135



Assembly position (left side)



Assembly position (right side)

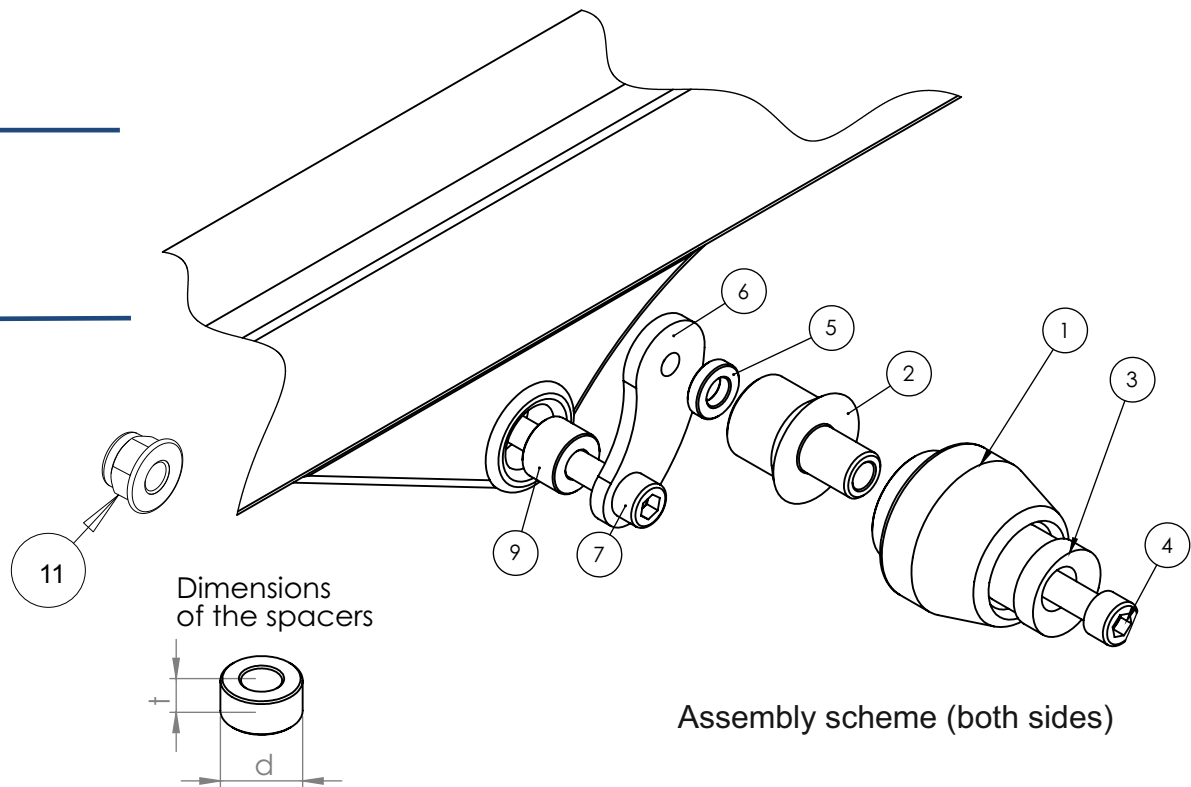

Assembly scheme (both sides)

**Assembly instructions**

1. Remove the original bolts indicated with the arrows on the assembly position scheme above.
  2. Replace the original bolt by the new mounting bolt (parts #7), the spacer 1 (parts #9) and adapter (part #6) according to the scheme on the right page. Put the adapter (part #6) in the right position according to the drawing on the right page.
  3. Assemble the slider, round cylindrical body, the bolt and the steel sleeve (parts #1, #2, #3, #4 and #5) according to the drawing on the right page. Put them into the threaded hole in adapter (part #6).
  4. Same operation is required in another side of the motorbike.
- We suggest to use the threadlocker (eg. Loctite®) to make sure that the vibrations of the engine do not loosen the bolts.

Part #	Part name	Left side (as You sit on the motorbike)	Right side
1	Slider	1 pcs.	1 pcs.
2	Round cylindrical body	L = 80 mm	L = 80 mm
3	Steel washer	1 pcs.	1 pcs.
4	Allen bolt (8,8 class)	M10x110 mm	M10x110 mm
5	Spacer	t=20mm, d=5 mm	t=20mm, d=5 mm
6	Adapter	Steel	Steel
7	Mounting bolt 1	M10x120	M10x120
8	Mounting bolt 2	-	-
9	Spacer 1	t=20mm, d=15 mm	t=20mm, d=15 mm
10	Spacer 2	-	-
11	Nut	1 pcs. M10	1 pcs. M10
12	Washer	-	-

Legal note. This product is a professional accessory to be used on the race track. Neither manufacturer, nor Seller take responsibility for any damages occurred despite of using protective accessories. For more information go to [vortexracing.com](http://vortexracing.com)