



# AltRider Bracket Set for Honda Africa Twin Crash Bars INSTALLATION INSTRUCTIONS

The most up to date instructions can be downloaded from the product page at [altrider.com](http://altrider.com), under the instructions tab.

Dear Rider,  
Thank you for choosing AltRider! Whether a seasoned world adventurer or a first time ADV-Newbie, we welcome you to the AltRider experience. You can install your new product with the utmost confidence. AltRider designs, tests, and manufactures all of its products here in the United States. We are proud to do what we do, and honored to present to you the product of our labors.

Enjoy it, show it off, and most of all, RIDE IT!

Venture On,  
Jeremy LeBreton

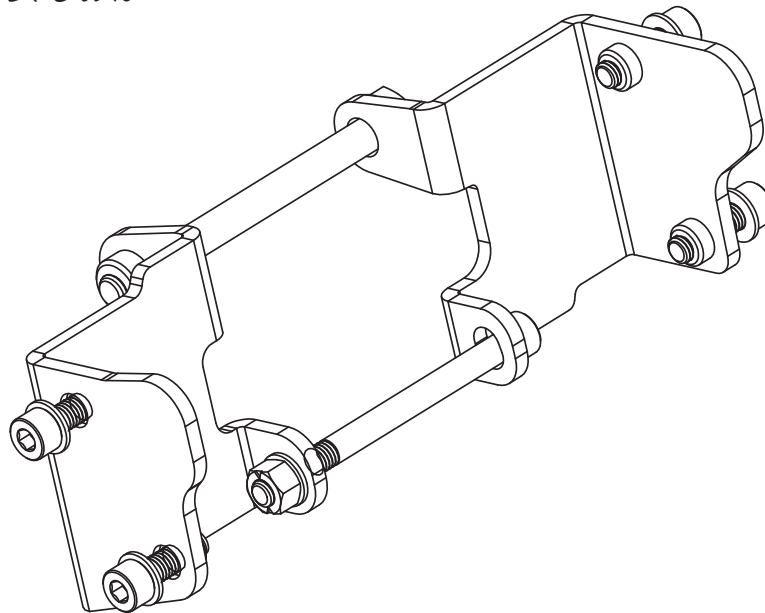

## AltRider Bracket Set Honda Africa Twin Crash Bars

### Package Contents:

- Bracket Set
- Hardware Kit
- Instructions

## AltRider LLC

### Global

mailing: 4000 Aurora Ave N Ste 100  
Seattle, WA 98103 USA  
phone: 206-922-3618  
email: [info@altrider.com](mailto:info@altrider.com)  
web: [www.altrider.com](http://www.altrider.com)

### Europe

mailing: AltRider EU  
Heliumstraat 230  
2718 RS Zoetermeer  
The Netherlands

email: [info@altrider.eu](mailto:info@altrider.eu)

REV 13.1  
MADE IN THE USA

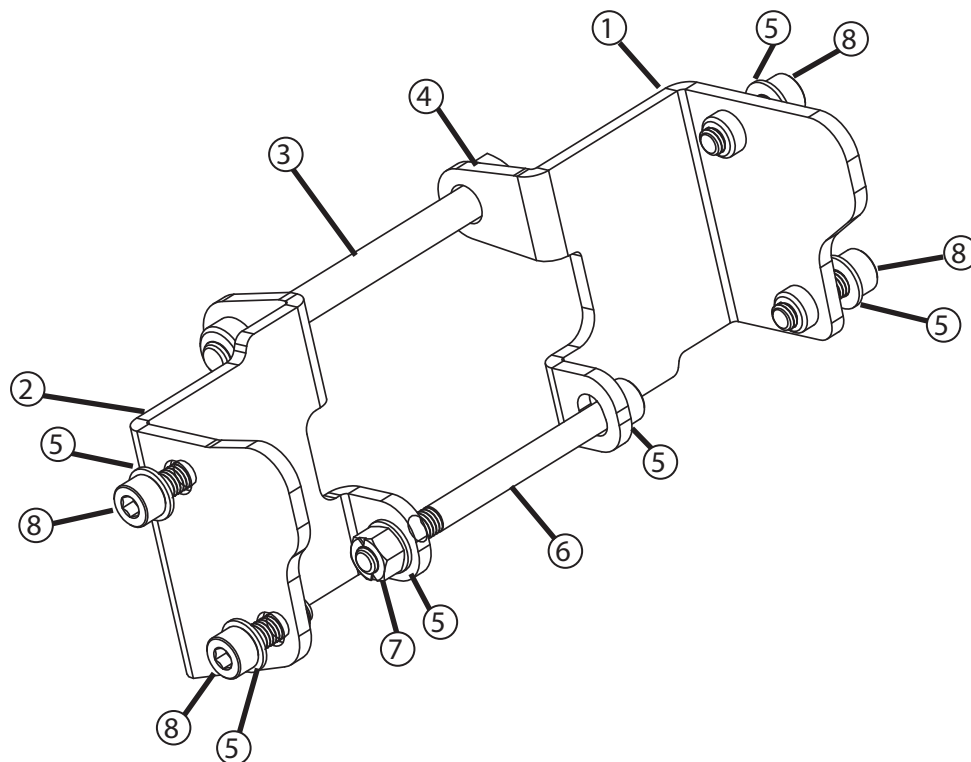

**Kit:**

- ① Left bracket
- ② Right bracket
- ③ M10 x 110 hex head screw
- ④ M10 washer
- ⑤ (qty 6) M8 washer
- ⑥ M8 x 100 socket cap screw
- ⑦ M8 lock nut
- ⑧ (qty 4) M8 x 25 socket cap screw

**Required Tools:**

- ① 12mm spanner
- ② 12mm spanner
- ③ 13mm spanner
- ④ 13mm socket
- ⑤ 17mm socket
- ⑥ 6mm hex allen tool
- ⑦ Ratchet handle
- ⑧ Extension
- ⑨ thread locker



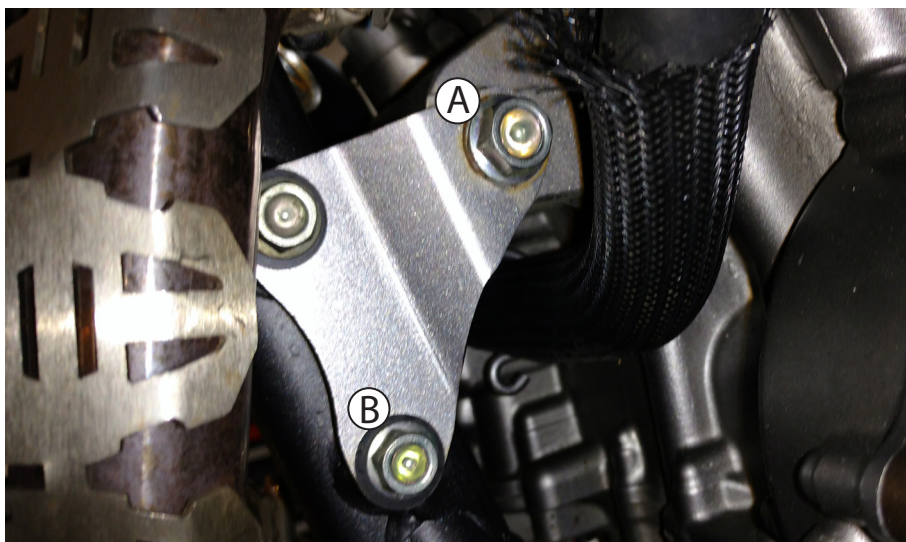

- ① The brackets fit to either side of the central frame tube, behind the headers.  
 (A) Use 13mm spanner and 13mm socket to loosen the M10 bolt and nut shown.  
 (B) Use 12mm spanner and 12mm socket to loosen the M8 bolt and nut shown.

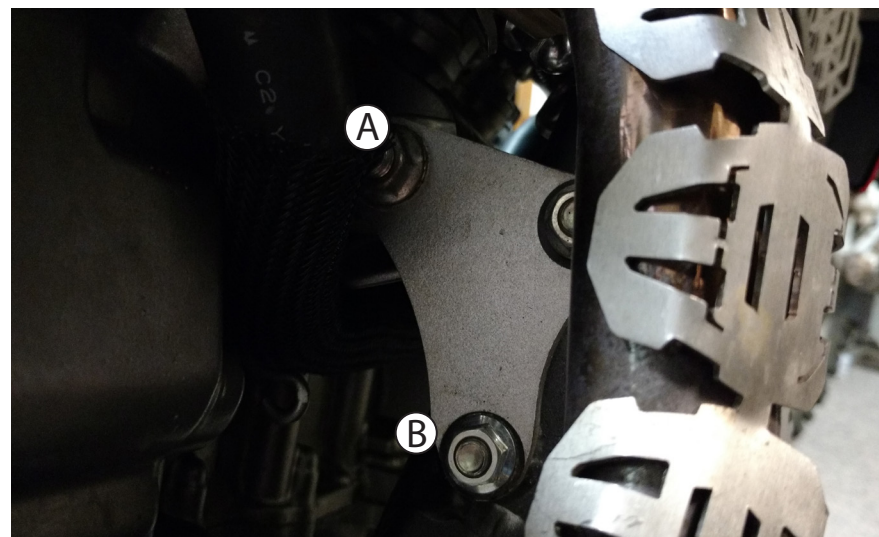

- ② (A) Remove the M10 screw and nut, you will not re use these. Caution, there are two M10 spacers, one on each side between the engine and flat bracket. Do not lose these, they should stay in place. (You can use a long M8 screw or an L-hex wrench through the hole to keep them).  
 (B) Remove the M8 screw and nut, you will not re use these.



- ③ Insert the M10 x 110 hex cap screw with washer into the Left AltRider bracket. Place the bracket and screw in place and insert the screw through the Honda brackets and engine case, be sure the two OEM spacers are still in place.



- ④ !!TIP If the screw insertion is difficult, use two 12mm spanners to loosen the last M8 bolt and nut, just enough to allow the brackets to move and allow easy screw insertion.



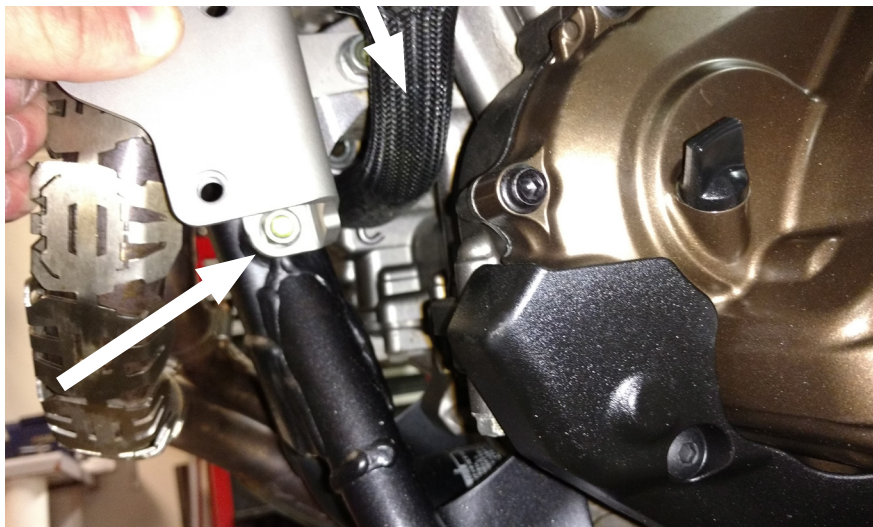

- ⑤ Insert the M8 x 100 socket cap screw and washer through the AltRider bracket and through the engine case. This will be easier to do if the bracket is pulled slightly outward loosely.

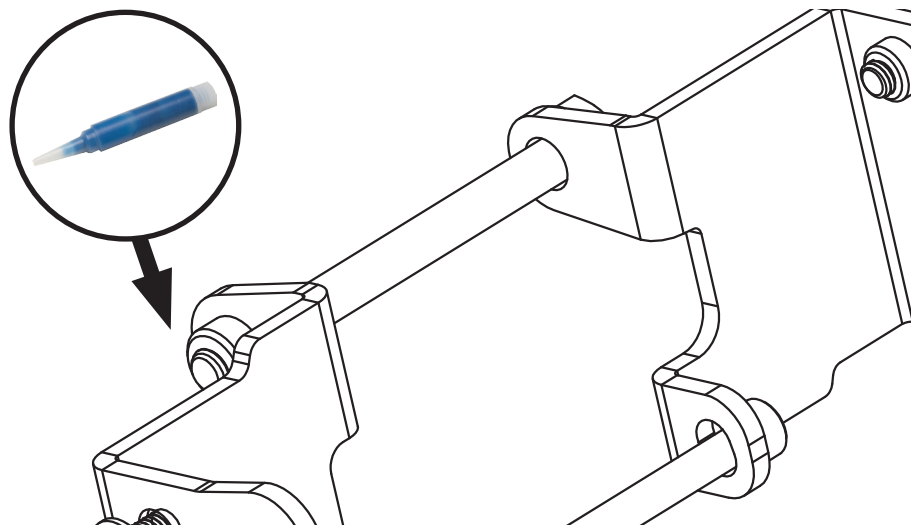

- ⑥ Place a drop of thread locker into the M10 captive nut on the Right bracket. Put the bracket in place and loosely screw in the M10 x 110 hex cap screw.



- ⑦ Screw the M8 x 100 socket cap screw into the M8 lock nut and washer. Hold screw steady with 6mm allen tool, and use 13mm wrench. Tighten to 21Nm. Tighten the OEM M8 nut and screw (from step 4) to 25Nm.

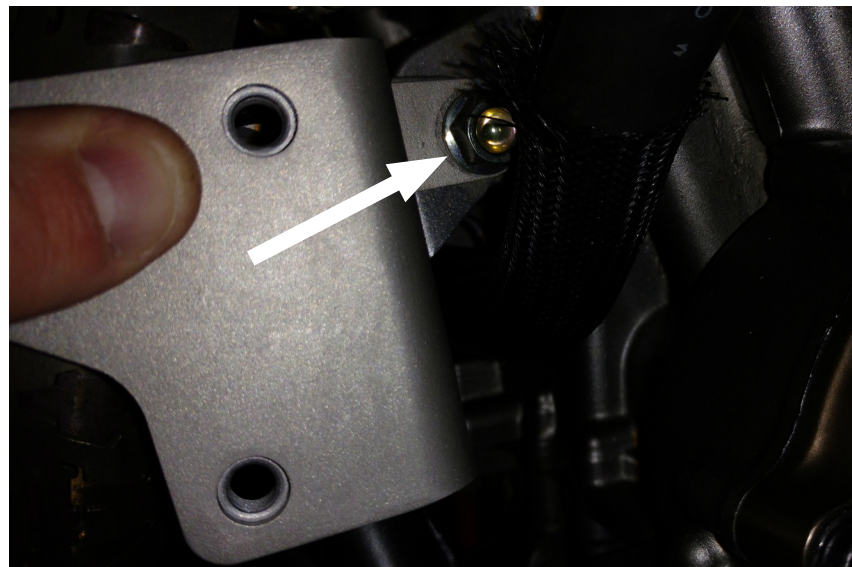

- ⑧ Use 17mm socket and tighten the M10 screw to 49Nm. Bracket installation complete. Save the M8 x 25 socket cap screws for installing the crash bars.

## CONGRATULATIONS!

**You've completed your installation. If at any point you have questions about your installation or have any feed back for us, we'd love to hear it. A downloadable version of these instructions can be found at our web site. [www.AltRider.com](http://www.AltRider.com)**

**After 5 hours of riding, or 100 miles, check all the fasteners on the assembly to ensure they are tightened to spec.**

### Global Office:

**email: info@AltRider.com**  
**phone: +1 206-922-3618**  
**address: 4000 Aurora Ave N**  
**Ste 100**  
**Seattle, WA 98103**

### Europe Office:

**email: info@AltRider.eu**  
**address: AltRider EU**  
**Heliumstraat 230**  
**2718 RS Zoetermeer**  
**The Netherlands**

#### TERMS OF USE, WARRANTY AND LIABILITY WAIVER

AltRider LLC, a Washington company, having its principal place of business in Seattle, WA ("AltRider") offers its motorcycle accessories (the "Product") with the terms, conditions and notices as follows:

##### Terms of Use

This Product is offered to you conditioned upon your acceptance without modification of the terms, conditions, and notices contained herein. Installation and/or use of this product implies acceptance of all such terms, conditions, and notices. If you do not agree to these terms, do not buy the Product. If you have already bought the Product and do not agree to these terms, return this Product promptly including the packaging and all written materials, to AltRider.

##### Limitation of Liability and Warranty Disclaimer

You may return your merchandise for a full refund or exchange, less any original or return shipping fees under these conditions:

1. Only if the merchandise is in 100% factory condition. Original manufacturer's packaging and same condition as sold – original boxes, packaging material, instructions, documentation, parts, and attached tags.
2. Only unused, unscratched, uninstalled, undamaged merchandise will be accepted. Do not install equipment until you are sure you want to keep it. Package items carefully in protective materials before returning them. Never ship an item in its original manufacturers packaging – it will arrive damaged. Please use a postal box or other adequate packaging to ensure your return or exchange is not damaged on the way back to AltRider.com.

To read more about our exchanges and returns policy, on the web, navigate to <http://www.altrider.com/info/exchangesAndReturns>

Excepting the warranties stated in the preceding paragraph, AltRider hereby disclaims all other warranties and conditions with regard to the Product including all implied warranties and conditions of merchantability and fitness for a particular purpose. There are no warranties which extend beyond the description on the face hereof. AltRider does not warrant against damages or defects arising out of use or installation of the Product. Installation instructions are provided for your convenience. AltRider is not responsible for any damages arising out of the installation, improper or otherwise, of the Product. No warranty of any kind, expressed or implied, is made regarding the safety of this Product.

To the extent allowed by law, AltRider shall not be held liable for any direct, indirect, punitive, incidental, special or consequential damages arising out of, or connected with, the use or misuse of this Product. Buyer assumes all risks and liability arising from use of this Product.

##### Entire Agreement

This document states the entire obligation of AltRider with respect to the Product. If any part of this agreement is determined to be void, invalid, unenforceable or illegal, including, but not limited to the warranty disclaimers and liability limitations set forth above, then the remainder of the agreement shall remain in full force and effect.

##### Applicable Law

This agreement is governed by the laws of Washington, USA. You hereby consent to the exclusive jurisdiction and venue of the courts of Washington, USA, in all disputes arising out of or relating to the use of this product.

