



## C/5 Sport Brake Lever Part# BRC555

Congratulations on your purchase of an ASV C/5 Sport Streetbike lever. The correct installation of control levers on a sport/street motorcycle is critical. Incorrect installation or the installation of an incorrect part can result in a malfunction of your clutch and / or front brake system. This lever should be installed by a certified mechanic; preferably at your local motorcycle dealer service dept. ASV Inventions, Inc. accepts no liability for malfunctions as a result of incorrect installation or the installation of a part that was not designed specifically for your motorcycle. Please check the list below to confirm that the correct year, make and model of your motorcycle is listed. If the correct year, make and model of your motorcycle is *not* listed below, then this part is *not* the correct part for your motorcycle and must *not* be installed onto your motorcycle.

### ASV C/5 Sport front brake lever part number: BRC555 fits only the following motorcycles:

Please disregard any dashes or letters after this part number, (ex; BRC555-SK) Any dashes or letters following your part number are for colors and/or length of the lever (Shorty) and do not affect the application of the lever to the bike.

APRILIA	YEAR	PART#
RSV Mille/R	(99-03)	BRC555
Tuono/R	(03-07)	BRC555
Falco/SL 1000	(00-04)	BRC555

DUCATI	YEAR	PART#
MS4/MS4R	(01-06)	BRC555
M900/M1000	(00-05)	BRC555
900SS /1000SS	(98-06)	BRC555
996/998B/S/R	(99-03)	BRC555
748/750SS	(99-02)	BRC555
MTS1000SDS/DS	(04-06)	BRC555
MTS1100/S	(07-08)	BRC555
ST4/S/ABS	(04-06)	BRC555

ST3/S/ABS	(03-07)	BRC555
Sport 1000	(06-08)	BRC555
GT 1000	(06-08)	BRC555
Paul Smart LE	(2006)	BRC555
Monster S2R 1000	(06-08)	BRC555

If your motorcycle is not on this list, this part # BRC555 is not the correct part for your Motorcycle.

For any questions regarding correct application for your motorcycle, please call ASV Inventions, Inc., toll free, at: **1-877-278-7000**

## INSTALLATION INSTRUCTIONS FOR PART # BRC555

**Tools and supplies needed: 1) Flat Blade Screwdriver, 1) 10mm wrench or socket**

**1** To remove your stock lever, use a 10mm wrench or socket to remove the locknut attached to the main pivot bolt that holds the lever. (Photo 1)

**2** Once the locknut is removed, unscrew the main pivot bolt with a Flat blade screwdriver. After the pivot bolt is removed, the lever will detach from the master cylinder. (Photo 2) Be sure to also remove the plunger rod from the master cylinder that was inserted into the barrel on the original lever.



**See other side for further instructions**

**INSTALLATION INSTRUCTIONS FOR PART # BRC555 (continued from other side)**

**3** When installing the ASV lever, you will use the supplied plunger barrel (Photo 3a) and plug it into the stock OEM Plunger rod as shown in photo 3b.

**4** Align the lever and the master cylinder pivot bolt holes and Install the main pivot bolt, and tighten it until it is snug against the master cylinder. Do not over-tighten, as it could cause the lever to bind in the master cylinder. Install the locknut onto the main pivot bolt and tighten. Use the flat blade screwdriver to keep the main pivot bolt from turning while tightening the locknut. (Photo 4) Do not over tighten the locknut as it can cause binding of the lever and master cylinder. Maximum torque on locknut should be five (5) foot-lbs. or sixty (60) inch-lbs.

**After installation is complete, with the engine off and bike out of gear, apply the front brake several times to ensure it is functioning properly. You should hear the “clicking” sound of the brake light switch being activated each time you pull the brake lever in. There should be no drag and the front wheel should spin freely when brake is not engaged. With the Key in the “ON” position, your rear brake light should light up when the front brake is applied, and turn off when the brake lever is released. If something does not seem right, consult your mechanic or contact ASV technical support before riding your motorcycle.**

**IMPORTANT: Do not ride your motorcycle if there is any drag or the front wheel does not spin freely after installation.**

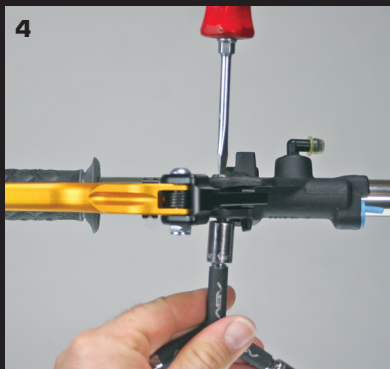
**3a****3b****4**

**ASV Inventions, Inc.**  
 16421 Gothard Street Suite A,  
 Huntington Beach, CA 92647 • 714-861-1400