



Part No. 2350-0201

MEM5807

REVISION 0

Wind Management Device  
Bullet Booster Wing Lite  
Bullet Fairing

Before assembly, read Warnings inside



**WARNING**

1. During installation, make sure that the Bullet Booster Wing/Fairing and hardware do not interfere with any cables or wiring when the forks are turned all the way in either direction. Also make sure, through the full range of adjustment, that the Wing / Fairing and hardware do not hit the gas tank.
2. The improper installation of this product and related components could result in serious injury or death.



**CAUTION**

1. Memphis Shades Bullet Booster Wings are made from Lucite® acrylic, and will last for years with proper care. Clean your Booster Wing with plenty of soapy water (mild dishwashing liquid is best) and a soft cotton cloth. Use your bare hands to feel and dislodge bugs, or cover with a wet, soapy towel and let it soak. Don't use paper towels and scrape with anything. Small scratches can be removed with NOVUS #2.
2. Never use any glass cleaning products, petroleum based chemicals, or cleaning agents with ammonia, bleach or any other harsh chemicals. This includes (but not limited to) RainX, brake fluid, acetone, paint thinner, benzene and gasoline. "If it hurts your nose, it will hurt the plastic."
3. Glass cleansing agents will cause severe damage to your Bullet Booster Wing, and will void your warranty. For care and cleaning we recommend using **Memphis Shades All Kleer**, a unique cleaner/polish, bug remover and rain repellent that leaves a super slick surface that makes the next cleaning even easier.

Memphis Shades warrants all product components, metal and plastic, against defects in materials and workmanship for 24 months.

**For Parts and Warranty Help, Contact:**

Memphis Shades, Inc.

P.O. Box 429

Rossville, TN 38066

(901) 853 0293

Visit us on the web at [www.memphisshades.com](http://www.memphisshades.com) or you can also reach us by email:

[customerservice@memphisshades.com](mailto:customerservice@memphisshades.com)

## 1. Kit Contents

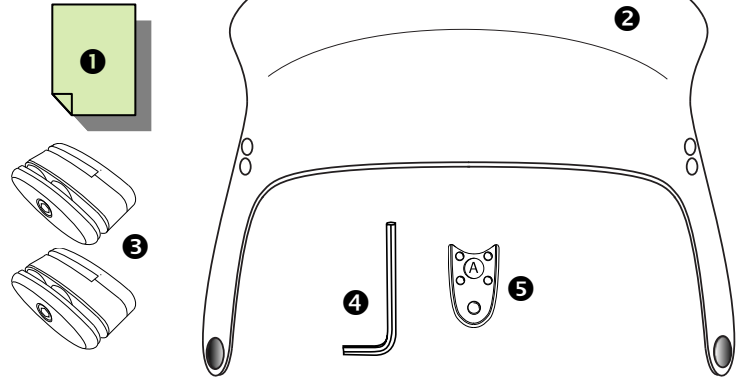

Ref	Code	Description	Qty
①	I5807	Mounting Instructions	1
②	MEP5807	Booster Wing	1
③	S1240	HW Biplane clamp - nylon	2
④	M943	Allen wrench, 5/32"	1
⑤		A pad	4

## 2. Mounting Instructions

1. Cover gas tank and front fender with towels to avoid damage during installation.
2. Use the 5/32" allen wrench to remove the Socket head cap screw from the Wing mount part of the Biplane clamp (Fig 1).
3. Insert the posts on the Wing mount through the corresponding holes in the Bullet Booster Wing. The Wing mount should face to the outside. Reassemble the Biplane clamp by fitting and tightening the Socket head cap screw (Fig 2). Do this for each pair of holes. (Fig 3)
4. Use the 5/32" short arm allen wrench to remove the screw in the wing clamp part of the Biplane clamps. (Fig. 4)
5. Fit "A" pad into Wing clamp and Wing mount by aligning pads and pressing into place. Repeat for other Biplane clamp (Fig. 5)
6. Position the Biplane clamps (with Bullet Booster Wing Lite fitted) over the existing Bullet Fairing. Once satisfied with the position, tighten down the Socket head cap screw to secure the Biplane clamps in place (Fig 6).
7. Reach behind the Bullet Booster Wing, and pull the backing strip off the rear of the Dual Lock Disc. Ensure everything is aligned correctly then push down hard on the outside of the Booster Wing securing the Dual Lock Disc in place on the Bullet Fairing. (Fig 7)
8. The Top Wing can be removed from the Bullet Fairing by loosening each Biplane Clamp and separating the two halves of each Dual Lock Disc. (Fig 8)

Fig. 1

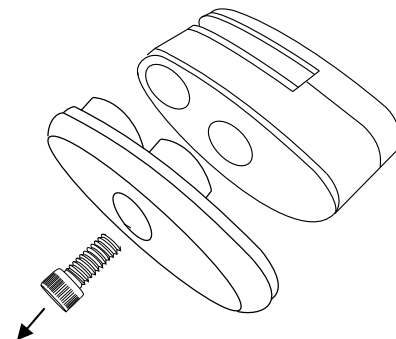

## 2. Mounting Instructions, continued

Fig. 2

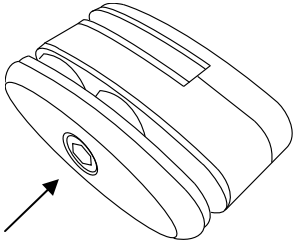

Fig. 6

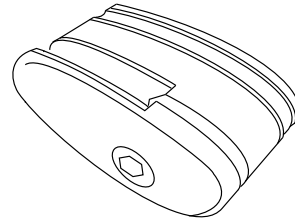

Fig. 3

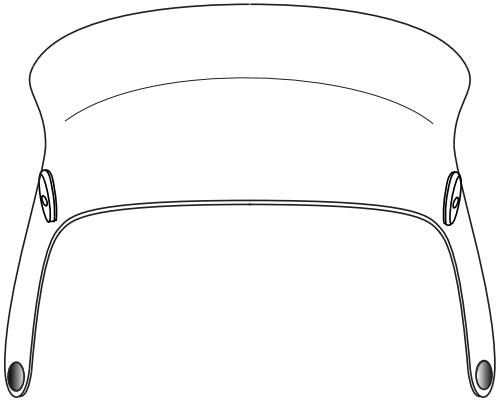

Fig. 7

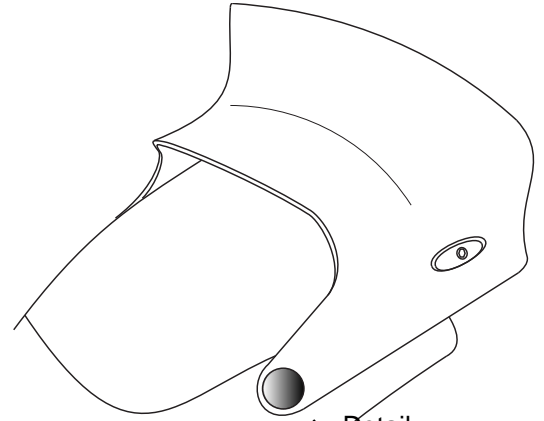

Fig. 4

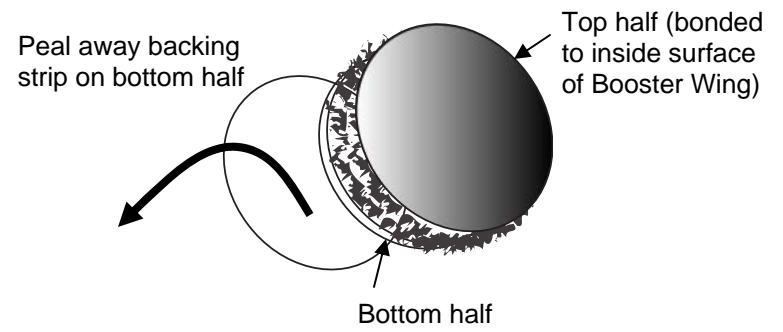
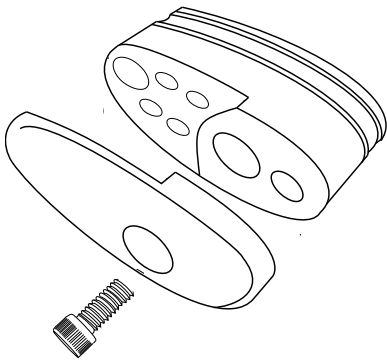

Fig. 5

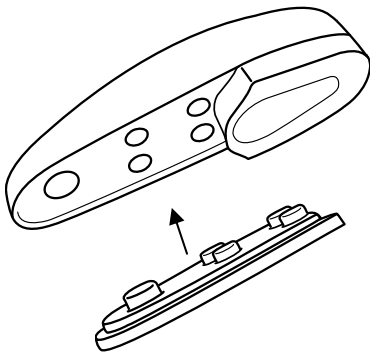

Fig. 8

