



INSTALLATION

LICENSE PLATE FRAME REAR PANEL ACCENT

3139

THANK YOU FOR CHOOSING KÜRYAKYN!

PROTECT YOURSELF AND OTHERS FROM POSSIBLE INJURY AND PROPERTY DAMAGE OR LOSS. PAY CLOSE ATTENTION TO ALL INSTRUCTIONS, WARNINGS, CAUTIONS, AND NOTICES REGARDING THE INSTALLATION, USE, AND CARE OF THIS PRODUCT.

WARNING	THIS INDICATION ALERTS YOU TO THE FACT THAT IGNORING THE CONTENTS DESCRIBED HEREIN CAN RESULT IN POTENTIAL DEATH OR SERIOUS INJURY.
CAUTION	This indication alerts you to the fact that ignoring the contents described herein can result in minor or moderate potential injury.
NOTICE	This indication alerts you to the fact that ignoring the contents described herein may negatively affect product performance and functionality or damage the product itself or the product to which it is being attached.

MAKE SURE THE FOLLOWING PARTS HAVE BEEN INCLUDED IN THE KIT:

- 1 License Plate Frame
- 1 Back-plate Weldment
- 1 Hardware Kit containing:
 - 6 #6-19 X 3/8" Panhead Screws
 - 1 1" X 3" X 0.10" Adhesive Pad
- 1 Installation instructions

TOOLS SUGGESTED:

Phillips head screw driver, set of metric hex wrenches, set of metric wrenches or sockets and ratchet

NOTICE	These installation instructions contain important information. Ensure that the end user receives this copy and is aware of its importance for future reference.
---------------	--

- STEP 1** Read and understand all steps in the instructions before starting the installation. Park the motorcycle on a hard, level surface and turn off the ignition. Allow the exhaust system to cool.

WARNING	YOU WILL BE WORKING AROUND THE EXHAUST SYSTEM DURING INSTALLATION. ENSURE THAT THE EXHAUST SYSTEM HAS FULLY COOLED TO PREVENT INJURY.
----------------	--

ASSEMBLE THE NEW FRAME:

- STEP 2** Remove the existing license plate from the bike.
- STEP 3** Locate the included License Plate Frame and Back-plate Weldment.

3139-21GL-0514

-cont.-

CUSTOMER SERVICE

877.370.3604 (toll free)

INSTALLATION QUESTIONS

techsupport@kuryakyn.com
or call 715.247.2983

LIMITED WARRANTY

Küryakyn warrants that any Küryakyn products sold hereunder, shall be free of defects in materials and workmanship for a period of one (1) year from the date of purchase by the consumer excepting the following provisions:

- Küryakyn shall have no obligation in the event the customer is unable to provide a receipt showing the date the customer purchased the product(s).
- The product must be properly installed, maintained and operated under normal conditions.
- Küryakyn makes no warranty, expressed or implied, with respect to any gold plated products.
- Küryakyn shall not be liable for any consequential and incidental damages, including labor and paint, resulting from failure of a Küryakyn product, failure to deliver, delay in delivery, delivery in nonconforming condition, or for any breach of contract or duty between Küryakyn and a customer.
- Küryakyn products are often intended for use in specific applications. Küryakyn makes no warranty if a Küryakyn product is used in applications other than intended.
- Küryakyn electrical products are warranted for one (1) year from the date of purchase by the consumer. L.E.D.'S contained in components of Küryakyn products will be warranted for defects in materials and workmanship for 3 years from the date of purchase where as all other components shall be warranted for one(1) year. This includes, but is not limited to; control modules, wiring, chrome & other components.
- Küryakyn makes no warranty of any kind in regard to other manufacturer's products distributed by Küryakyn. Küryakyn will pass on all warranties made by the manufacturer and where possible, will expedite the claim on behalf of the customer, but ultimately, responsibility for disposition of the warranty claim lies with the manufacturer.

ABOUT OUR CATALOG

For purchasing Küryakyn® products, you can receive a complete catalog free of charge. Send the Proof-of-Purchase below with your address to: Küryakyn
454 County Road V V
Somerset, WI 54025-9031
Please indicate either Accessories Catalog for Harley-Davidson® or GL & Metric Cruisers.

Be sure to ask your local dealer about other Küryakyn® products, the motorcycle parts and accessories designed for riders by riders.

©2005 Küryakyn USA® All Rights reserved.



kuryakyn.com

STEP 4 Refer to **PIC 1**. Position the license plate in the License Plate Frame

STEP 5 Refer to **PIC 2**. Secure the plate and Weldment to the Frame with the six (6) included screws; **DO NOT OVER TIGHTEN THE SCREWS!**

NOTE: If necessary, install the included Foam Pad between the Weldment and license plate to reduce vibration/rattling of thinner plates.

BIKE PREP:

STEP 6 Refer to **PIC 3**. Remove the four screws securing the rear fender panel to the bike; save the screws for reinstallation.

STEP 7 Gently, remove the panel, then disconnect the connector.

STEP 8 Remove the two nuts and washers from the backside of the panel; save the nuts and washers for later use.

STEP 9 Remove the existing license plate bracket; it will not be reused.

NOTE: Refer to **PIC 4**. Ensure that the top hat washers remain in their holes as the existing bracket is removed.

INSTALL THE NEW FRAME:

STEP 10 Insert the threaded studs on the new Frame assembly through the holes in the panel; secure the Frame to the panel with the nuts and washers from **STEP 8**; leave the nuts snug for now to allow for adjustment.

STEP 11 Align the Frame on the panel, then tighten the nuts.

STEP 12 Reconnect the connector; turn **IGN ON** and check for proper operation of the license plate light. Reinstall the rear fender panel.

STEP 13 Ensure proper operation of **ALL** rear end lighting **BEFORE** riding the motorcycle

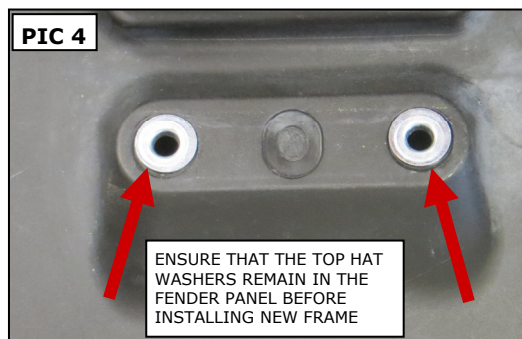
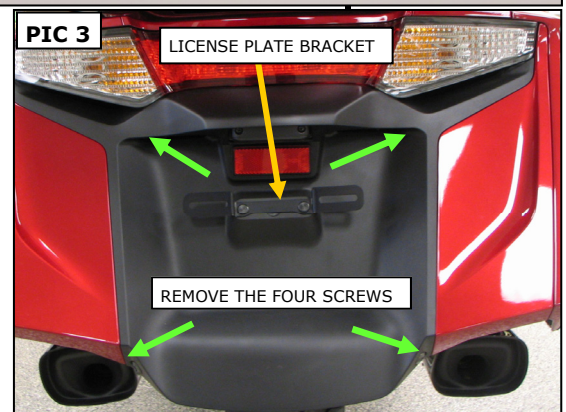
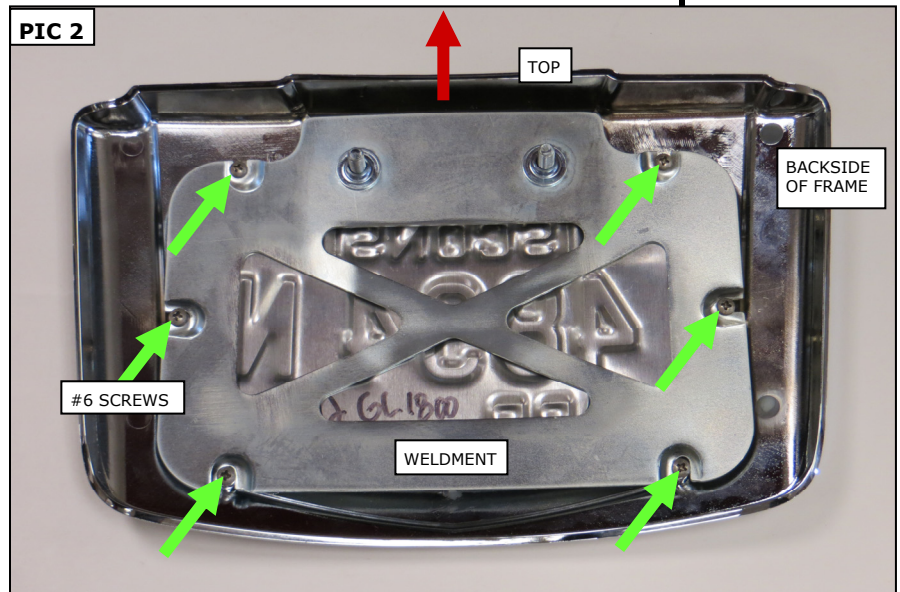

Ride On!