



YOSHIMURA

RESEARCH & DEVELOPMENT OF AMERICA, INC.

5420 DANIELS STREET STE A, CHINO CALIF. 91786 · (800)634-9166 · (909)628-4722 · FACSIMILE (909)591-2198

www.yoshimura-rd.com

CHASSIS PROTECTOR SET

HONDA
04-11
CBR1000RR

040BG120000

CHASSIS PROTECTOR SET - BLACK



Part List:

NO.	DESCRIPTION	QTY	PART #
1	Aluminum Spacer (Right Side)	1	1200-A01-00
2	Chassis Protector (Black)	2	040BG-MS
3	Aluminum Insert for 040BG-MS	2	040BG-MSI-12
4	12mm x 100mm Socket Head Cap Screw	2	M12X1.25X100
5	Aluminum Spacer (Left Side)	1	1200-A02-00
**	Yoshimura Sticker	2	17020C

Right Side

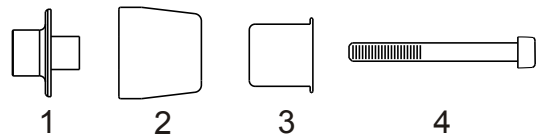

Left Side

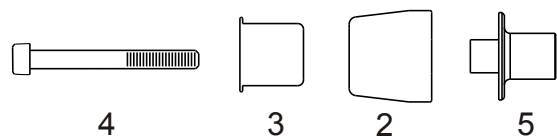

Note: Read through all instructions before beginning installation.

Tools Needed:

5mm Allen Wrench
#1 Phillips Screwdriver
17mm Socket
Ratchet
Masking Tape
Drill
3/16" Drill Bit
2" Hole Saw
Torque Wrench

Installation Steps:

- 1 Remove bottom left fairing.
- 2 Slide 3/16" drill bit into the hole in the stock chassis mount bolt with the cutting end facing out. (See Fig. 1 and 2)
- 3 Reinstall bottom left fairing.
- 4 Press the 3/16" drill bit against the inside of the fairing and turn the drill bit to mark the exact location to drill the pilot hole.
- 5 Remove the fairing and find the mark on the inside of the fairing. Using this mark as your guide, drill a small pilot hole.
- 6 Reinstall the fairing and make sure the pilot hole lines up perfectly with the hole in the stock chassis mount bolt.
- 7 Remove the fairing and tape the area around the pilot hole with masking tape. (See Fig. 3)
- 8 Using the 2" hole saw, cut a 2" hole in the fairing using the pilot hole as a guide.
- 9 Remove the duct tape.
- 10 Repeat the above instructions for the lower right side fairing.

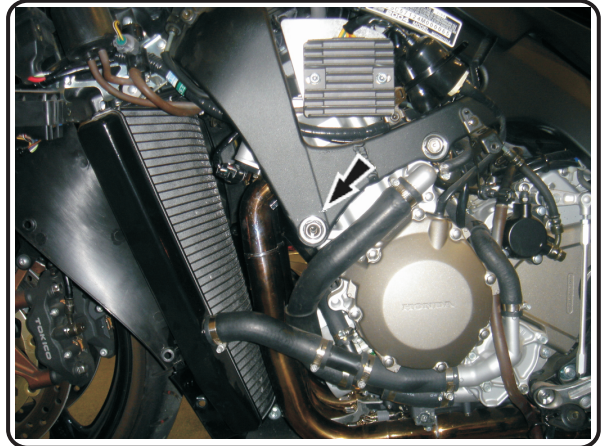

Fig. 1

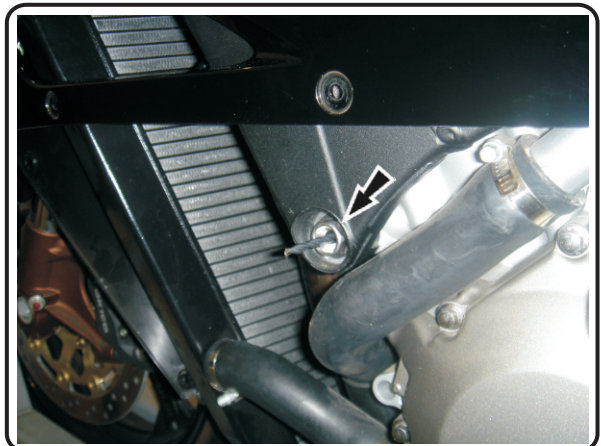

Fig. 2



Fig. 3

11 Remove the left side stock engine mount bolt.

12 Install the left chassis protector with aluminum spacer into the left engine mount using supplied bolt. Torque bolt to 5.5 kg-m (39 lb-ft). (See Fig. 4)

(Note: The longer aluminum spacer belongs on the left side of the motorcycle. The shorter aluminum spacer belongs on the right side of the motorcycle.)

13 Remove right side stock engine mount bolt.

14 Install the right chassis protector with aluminum spacer into right engine mount using supplied bolt. Torque bolt to 5.5 kg-m (39 lb-ft). (See Fig. 5)

15 Reinstall the left and right lower fairings.

IMPORTANT NOTE:

Install Yoshimura Chassis Protector one side at a time. Removing both engine mount bolts simultaneously may cause engine to sag or drop causing the mounting holes to be misaligned.

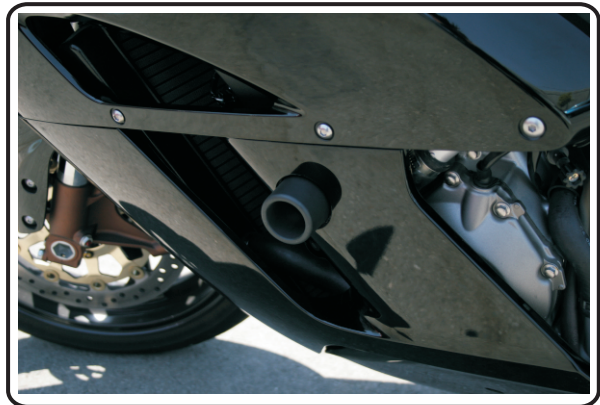

Fig. 4

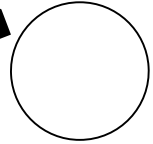

Fig. 5

2008-2011 MODEL TEMPLATE

LEFT SIDE

Cut out
and align



1. Cut out template and tape to fairing.
2. Drill pilot hole and be sure the engine mount bolt is centered to the pilot hole.
3. Remove template from fairing and cut out hole.
4. Re-apply the template to fairing and trace circle onto fairing using a marker.
5. Remove template and carefully widen the pilot hole to the traced circle using a rotary tool. Continuously check fit to see if the spacer and delron slider will clear hole.
6. Assemble and install chassis protector. See diagram for orientation.

NOTE: When installing the chassis protector, Install one side at a time. Removing both left and right engine mount bolts simultaneously may cause engine to drop or sag causing mounting holes to be misaligned.

Drill Pilot Hole

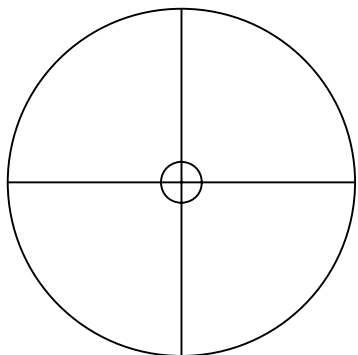

2008-2011 MODEL TEMPLATE

RIGHT SIDE

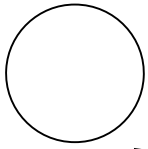

↖
Cut out
and align

1. Cut out template and tape to fairing.
2. Drill pilot hole and be sure the engine mount bolt is centered to the pilot hole.
3. Remove template from fairing and cut out hole.
4. Re-apply the template to fairing and trace circle onto fairing using a marker.
5. Remove template and carefully widen the pilot hole to the traced circle using a rotary tool. Continuously check fit to see if the spacer and delron slider will clear hole.
6. Assemble and install chassis protector. See diagram for orientation.

NOTE: When installing the chassis protector, Install one side at a time. Removing both left and right engine mount bolts simultaneously may cause engine to drop or sag causing mounting holes to be misaligned.

Drill Pilot Hole

