



# YOSHIMURA

RESEARCH & DEVELOPMENT OF AMERICA, INC.

5420 DANIELS STREET STE A, CHINO CA. 91710 · (800)634-9166 · (909)628-4722 · FACSIMILE (909)591-2198

[www.yoshimura-rd.com](http://www.yoshimura-rd.com)

## **YOSHIMURA PERFORMANCE EXHAUST SYSTEM SYSTEM**

**1988-2007  
KAWASAKI  
EX250 NINJA**

**1405255**

STAINLESS STEEL RS3 DUAL SLIP-ON SYSTEM



**THIS PRODUCT IS DESIGNED FOR USE IN CLOSED COURSE RACING AND IS NOT INTENDED FOR HIGHWAY USE.**



NOTE: IN THE STATE OF CALIFORNIA, IT IS ILLEGAL TO MODIFY THE EMISSION CONTROL SYSTEM. WHICH INCLUDES THE CARBURETORS OF ANY VEHICLE.

**Caution:** Exhaust system can be extremely hot. Let motorcycle cool down before beginning installation.

**Note:** Read through all instructions before beginning installation.

## Tools Needed:

- 12mm and 14mm sockets
- 11mm deep socket
- 3/8" ratchet and extension
- 14mm wrench
- Torque wrench
- Drill
- 13/64" drill bit

## Installation Steps:

1. Remove left and right stock mufflers and tailpipes by removing the muffler mounting bolts and the stock collector clamps (see Fig #1, 2, 3 and 4).
2. Apply rubber heat insulators to inside of muffler clamps and slide muffler clamps onto mufflers.
3. Slide supplied exhaust clamps over Yoshimura tailpipe inlets.
4. Install Yoshimura slip-ons using stock hardware.

**NOTE:** Yoshimura muffler clamps mount on the inside of the stock muffler mounting locations (see Fig. 5).



Fig. 1

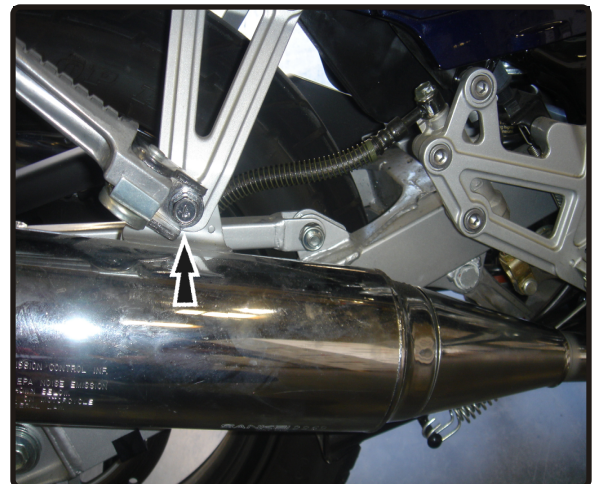

Fig. 2

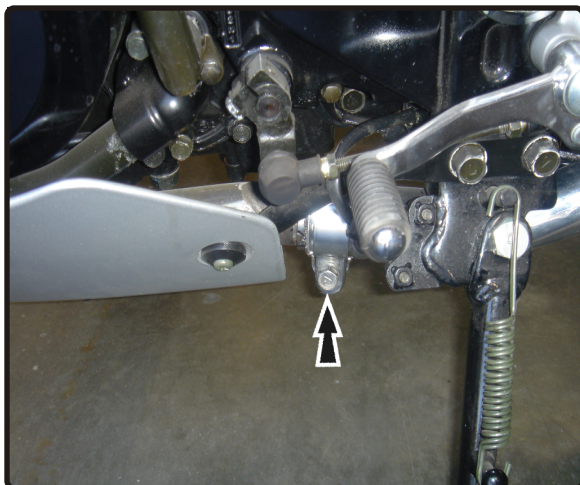
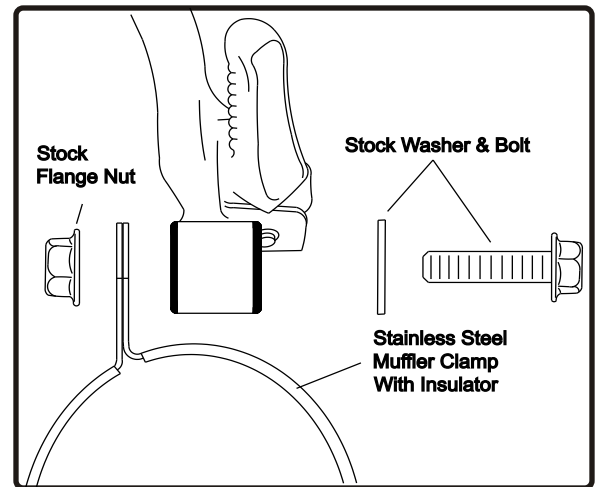

Fig. 3

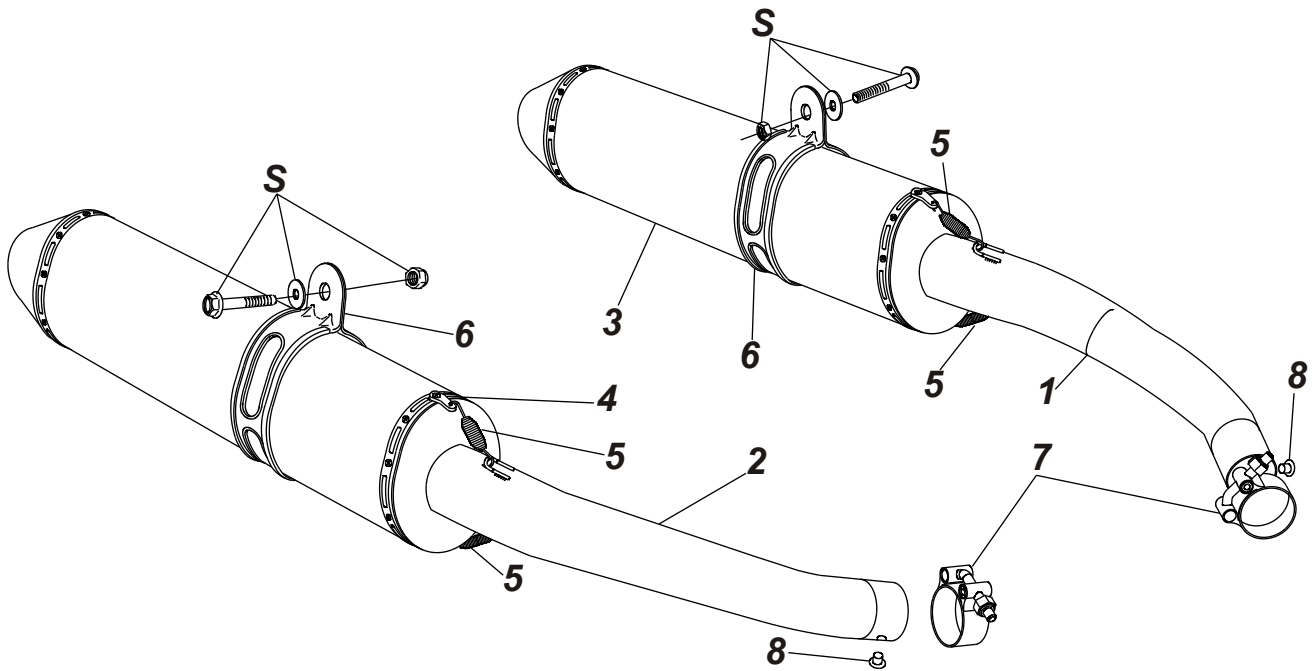

Fig. 4

5. Check for proper alignment of both mufflers. You may have to adjust the mufflers and/or tailpipes independently from each other to achieve proper alignment.
6. Torque muffler mounting bolts to 2.5 kgf-m (18 lb-ft).
7. Near the inlet of both Yoshimura tailpipes are holes. Drill a 13/64" hole in the stock header, using the hole on each tailpipe as a guide. Install supplied collector rivets so the head of the rivets are flush with the tailpipes. Center the exhaust clamp over the rivets and torque left and right exhaust clamps to 1.1 kgf-m (8.0 lb-ft).
8. It is recommended that the entire exhaust system be wiped down with rubbing alcohol to remove oil and fingerprints. This will help prevent tarnishing of the finish after the exhaust is heated up.
9. Before starting motorcycle, check for proper clearance between new exhaust system and motorcycle (i.e. swing-arm, fairings etc.). If any problem is found, please carefully follow through the installation steps again. If problem still persists, please call Yoshimura technical department at (800) 634-9166/ in CA (909) 628-4722.

**Fig. 5**

**#1405255**



**S = STOCK**

Parts Diagram

<b>NO.</b>	<b>DESCRIPTION</b>	<b>QTY</b>	<b>PART #</b>
1	Left Hand Slip-On Tailpipe	1	1405-426
2	Right Hand Slip-On Tailpipe	1	1405-427
3	Left Hand Muffer Assembly	1	1405255-LMA
4	Right Hand Muffer Assembly	1	1405255-RMA
5	Medium Exhaust Springs	4	RACE-SPS-1
6	Muffer Clamp	2	COS400S10ASAX
7	Collector Clamp	2	22053
8	Collector Clamp Rivet	2	S-RIVET
**	Spring Puller	1	ST-200
**	Yoshimura Vinyl Stickers 7"	1	17029
**	Muffer Clamp Heatshield	2	HT SHLDTRS