

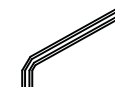

Congratulations, you have purchased the finest exhaust system for your motorcycle on the market. Your Vance & Hines exhaust system is designed and crafted for maximum performance, a perfect fit, a great sound and unbeatable style. Please follow the installation instructions below and if you have any questions, please call our technical support line at (562) 926-5291.

Attention installer (if other than owner), please forward this instruction sheet to the owner of this product. These instructions contain valuable information to the end user.

**TOOLS
REQUIRED**



5mm Allen



5/16 Nutdriver



17mm & 1/2"
Combination
wrenches



Flat blade screwdriver

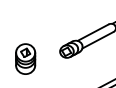

3/8" Extension, 12 and
14mm sockets

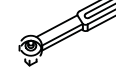

3/8" Drive ratchet

READ ALL INSTRUCTIONS BEFORE BEGINNING INSTALLATION

**STOCK EXHAUST
SYSTEM REMOVAL**

1. If equipped, loosen right side driver floorboard to ease exhaust system removal and installation.
2. On European models or those equipped with O2 sensors, remove seat and right side cover.
3. On European models disconnect front and rear O2 sensors at connectors.
4. Locate the four 10mm bolts holding the header to the stock brackets and remove using a 12mm socket.
5. Remove the four nuts retaining the headers to the cylinder heads. Carefully remove the stock exhaust system as one unit from the

motorcycle. NOTE: Assistance may be required.

6. Remove the four bolts retaining the stock upper and lower brackets and save the two upper bracket bolts for re-use. Both stock brackets are not re-used. (Upper bolts shown in figure 1 & 2)
7. Check the stock exhaust gaskets to be sure they are in good condition. If you have any doubts as to their condition, replace them.

FIGURE 1

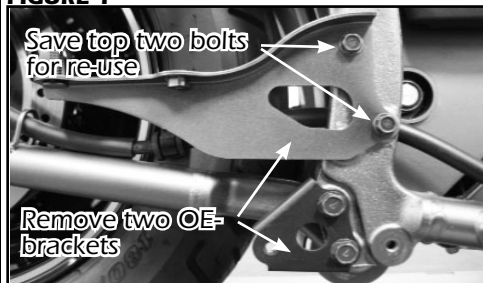

FIGURE 2



FIGURE 3

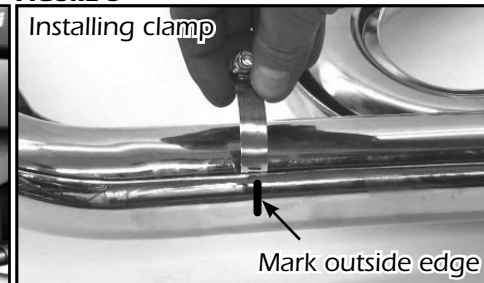

FIGURE 4

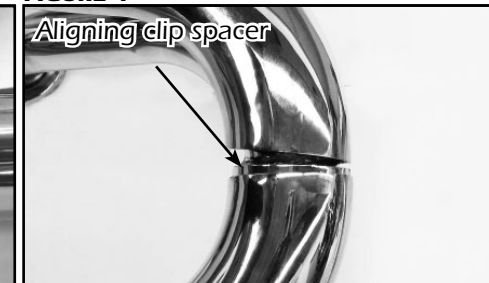

FIGURE 5

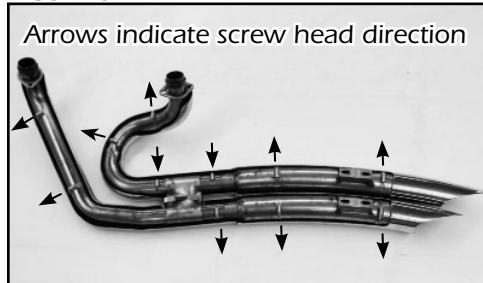

FIGURE 6



FIGURE 7



1. On European models remove O2 sensors from stock headers. Using a small amount of antiseize compound install the O2 sensors using the original front and rear placement in new headers and tighten. On non-O2 equipped models install O2 sensor plugs with copper washers (supplied).
2. Attach mounting bracket 627-P to frame using two stock bracket bolts removed earlier (Figure 2).
3. Remove head pipes and heat shields from protective packaging. Place each heat shield on a non-abrasive surface such as a blanket or carpet. Using a felt tip pen, mark outside edge of each heat shield to show location of mounting clips that hose clamps will loop through (Figure 3).
4. Lay header assembly into heat shields and install hose clamps. Install #20 hose clamps (supplied) on header heat shields and #36 hose clamps (supplied) on muffler body heat shields. Take note of clamp screw head direction (Figure 5). Screw heads must be accessible when system is installed on motorcycle for adjustment purposes. Do not tighten.
5. Make sure upper rear cylinder heat shield rests over the retaining lip of lower rear cylinder heat shield aligning clip spacer (Figure 4).
NOTE: Do not tighten at this time.
6. Using stock flange nuts, carefully install head pipes into exhaust ports. Assistance may be required. NOTE: Do not tighten at this time.
7. Slide nut plates inside bracket that is welded to backside of muffler bodies (Figure 6). While holding nut plates in place, attach muffler bodies to mounting bracket 627-P using four 5/16" x 5/8" flange head bolts (supplied). Leave them loose at this time.
8. Align rear cylinder heat shields evenly then tighten. (Figure 7) Tighten all hose clamps securing header heat shields.
9. Place muffler body heat shields over the front and rear header heat shields so that both header heat shield ends are just covered by the muffler heat shields. Align the front edge of the muffler heat shields so that they are flush with each other. Finger tighten the 5/16" flange head bracket bolts for muffler alignment after the muffler heat shields are installed.
10. Tighten the bracket flange bolts on both mufflers. Tighten all remaining heat shield clamps. Tighten the stock head pipe flange nuts. Tighten right side driver floorboard.
11. Check for adequate clearance of all exhaust system components and motorcycle accessories prone to heat damage.
12. Be sure to tighten all hardware before starting your motorcycle.
13. After installation and before starting motorcycle, completely clean pipes and mufflers with cleaning solvent and a clean, soft cloth that will not leave a residue. NOTE: Any residue, oil, or fingerprints will stain the chrome when the metal heats up.

EXHAUST CARE - HELPFUL HINTS TO AVOID DISCOLORATION OF EXHAUST SYSTEM

1. When installing a new set of chrome pipes, make sure your hands are clean and free of oil. After installation, thoroughly clean pipes with a soft cloth and cleaning solvent that will leave no residue (chrome wax / polish, glass cleaner, alcohol, ammonia, etc...) before starting the motorcycle.
2. Avoid long periods of idling as this can cause discoloration.
3. Intake leaks can cause the engine to run lean and overheat, this could lead to discoloration.
4. Make sure there are no exhaust leaks at the junction of the exhaust pipes and cylinder head. We recommend replacing gaskets if they are worn.

VANCE & HINES OPTIONAL ACCESSORIES

FUELPAK



FUEL MANAGEMENT:

Take the guess work out of fuel injection with Fuelpak Fuel Management. Contact your local dealer or call (562) 921-0071 to order. Visit fuelpakfi.com for more information. Fuelpak is intended for racing or off-highway use only, and is not legal for sale or use in California on pollution-controlled vehicles.

PLEASE NOTE: Every effort is made for Vance & Hines Exhaust Systems to provide improved cornering clearance. However, due to design and space limitations on some motorcycle models, ground and cornering clearance may not be improved and in some cases may be reduced. Be sure to follow proper installation instructions.

PACKING LIST

MORE POWER : LESS NOISE

ALL PARTS SHOWN ARE ACTUAL SIZE

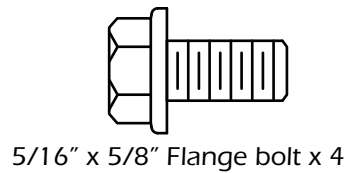
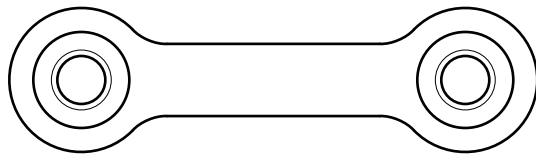
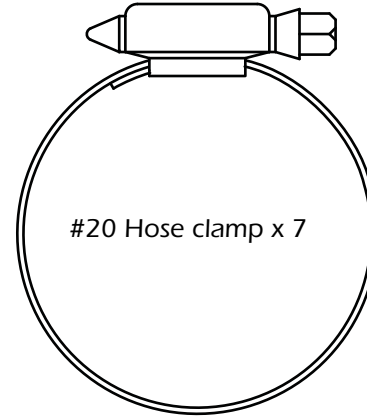
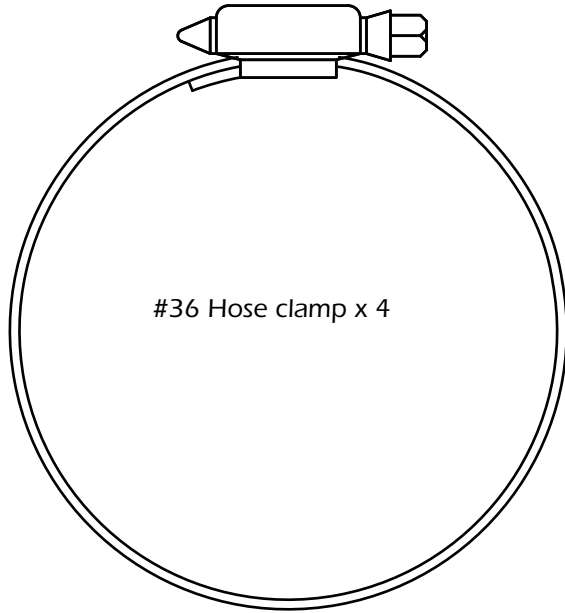

PARTS NOT SHOWN:

- 627-P Bracket x 1
- K375FC Header Assembly x 1
- K375HC Front heat shield x 1
- K376HC Rear heat shield upper x 1
- K377HC Rear heat shield lower x 1
- Y337HC Front muffler body heat shield x 1
- Y338HC Rear muffler body heat shield x 1

WARRANTY

Vance & Hines exhaust systems are warranted against defects in material and workmanship for a period of 90 days from the date of purchase from an authorized dealer. This warranty does not cover discoloration of chrome finishes. This warranty is limited to the repair or replacement of a product proven to be defective from normal use. Vance & Hines exhaust systems are designed to fit and operate on OEM motor and chassis. This warranty does not cover any product subject to abuse, misuse, improper installation or modification.

FUEL MANAGEMENT

GET THE MOST OUT OF YOUR RIDING EXPERIENCE...

AN AFTERMARKET EXHAUST SYSTEM IS ONLY YOUR FIRST STEP, NOW YOU NEED FUEL MANAGEMENT.

NOW YOU NEED FUELPAK.

Your fuel injected Kawasaki® is equipped with an ECU (electronic control unit) that's programmed to deliver fuel to the motor based on an air/fuel ratio for a stock air filter and stock exhaust system. When you install a performance exhaust system, your airflow changes, so you need a fuel management system that adjusts your air/fuel ratio to match the changes. That fuel management system is Fuelpak. Fuelpak adds and takes away fuel, allowing for a more precise range of refinement in your air/fuel ratio. Get the perfect fuel management combination with your Vance & Hines exhaust system, get Fuelpak. For more information visit the tuning center at fuelpakfi.com

NOTICE: Fuelpak is intended for racing or off-highway use only, and is not legal for sale or use in California on pollution-controlled vehicles.



MORE POWER : LESS NOISE

13861 ROSECRANS AVENUE / SANTA FE SPRINGS, CA 90670
SALES: (562) 921-7461 / TECHNICAL: (562) 926-5291 / FAX: (562) 802-0110
VANCEANDHINES.COM