



Fender Eliminator Kit P/N: 680-8100

Kit Contents

Part Number	Description	Quantity	Part Number	Description	Quantity
99-FE-680-8100	Fender Brackets	2	Locknuts	6mm Locknut	2
99-HB-6x16	BH 6x16 Bolt	2	99-Wash6x15	6x15mm Washer	4
99-HB-6x12	BH 6x12 Bolt	2	99-Wash6x12	6x12mm Washer	2

MADE IN THE USA!

Carefully read instructions in their entirety before the installing the part.

Professional installation is recommended. Always use proper safety measures during the installation of this product. Do not try to install this product without proper tools, **safety goggles, and gloves**. The motorcycle must be in a fixed, secure position before the installation process begins. DMP is not responsible for any part of your motorcycle for any reason. Precisely measure location of cut and if in doubt at any point please call us at (949) 453-9111 before the installation process has begun

Note: To complete your installation we recommend using the DMP Marker Lights which are available from your local DMP dealer or www.moto911.com.

1. Remove the rider seat.

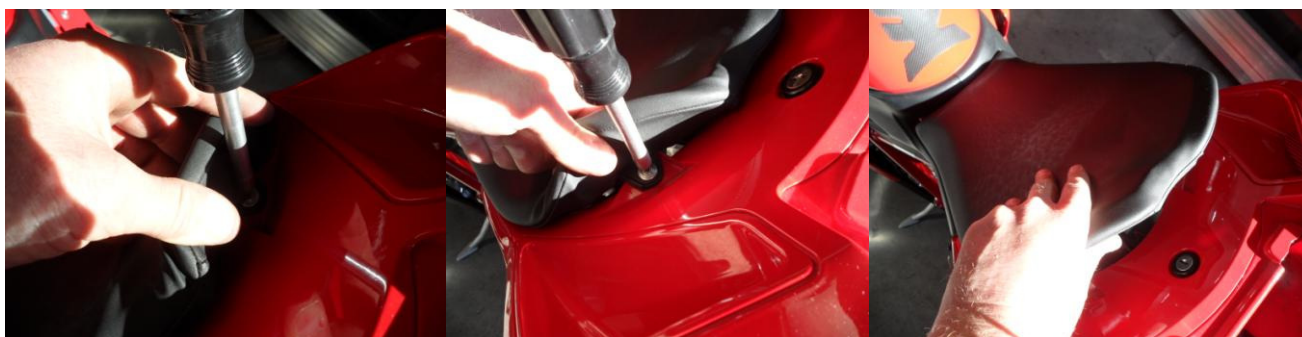

2. Remove the under tail fasteners (six fasteners total)

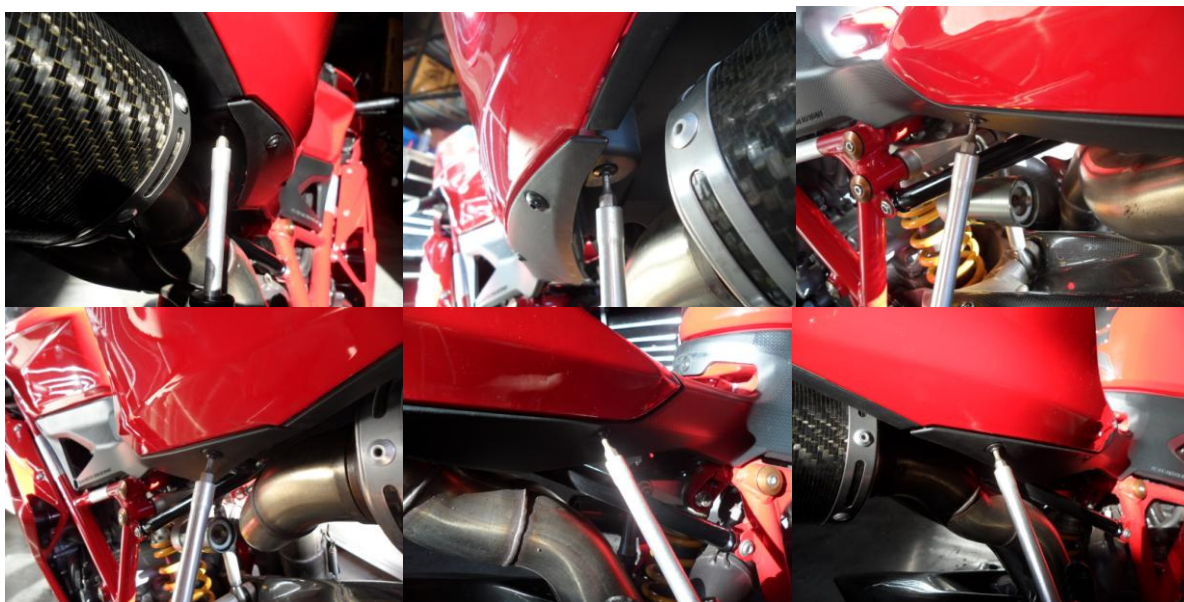

Remove the tail section fasteners.



3. Remove the mid plastic cowling fasteners.



4. Remove mid plastic cowling, one side at a time.

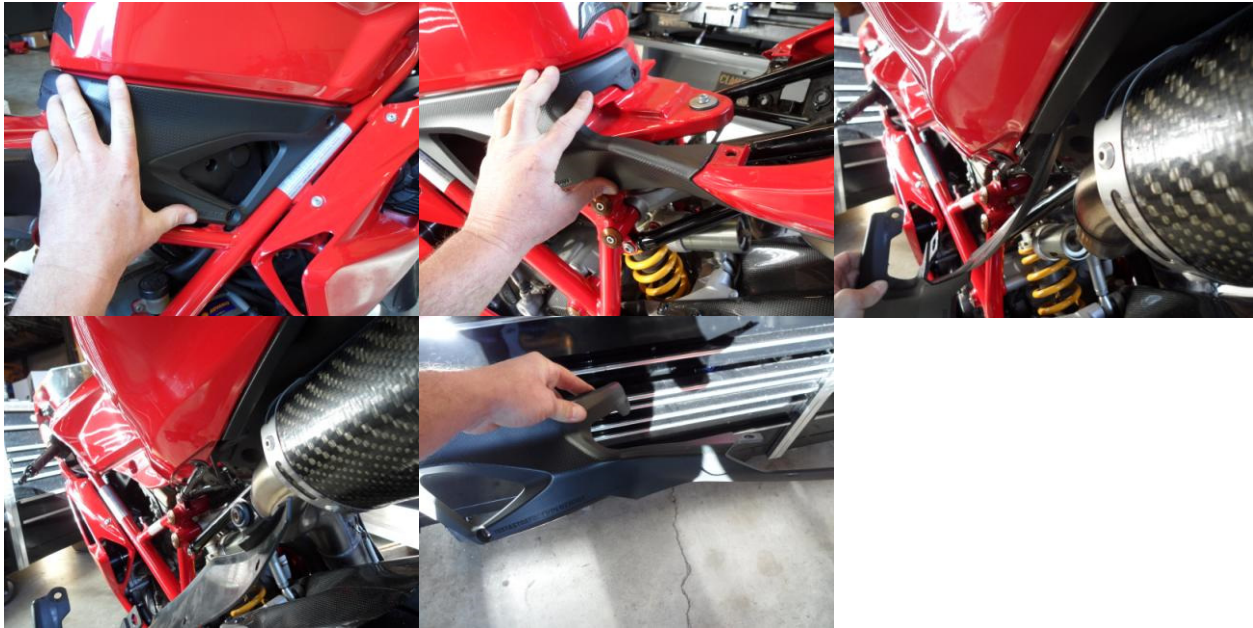

5. Remove the rear exhaust cans. One side at a time.



6. Unplug and remove the stock fender.



7. Separate the tail section from the under tail.



8. Mount the DMP Fender Eliminator using the 6x16 bolts and 6x15 (larger 6mm) washers.



9. To complete install, install turn signals and plate lights, make sure to check the function before completing install.
10. To complete install repeat steps 1-7 in reverse. Remaining hardware is used to mount your license plate.

