



# YOSHIMURA

RESEARCH&DEVELOPMENT OF AMERICA, INC.

5420 DANIELS STREET STE A, CHINO CA., 91786 · (800)634-9166 · (909)628-4722 · FACSIMILE (909)591-2198

[www.yoshimura-rd.com](http://www.yoshimura-rd.com)

## **TRS TRI-OVAL PERFORMANCE EXHAUST SYSTEM**

**SUZUKI**  
**2004 GSX-R600**  
**2004 GSX-R750**

<b>1108462</b>	TRS RACE ONLY BOLT-ON SYSTEM WITH CARBON FIBER
<b>1108465</b>	TRS RACE ONLY BOLT-ON SYSTEM WITH STAINLESS STEEL
<b>1108467</b>	TRS RACE ONLY BOLT-ON SYSTEM WITH TITANIUM



**THIS PRODUCT IS DESIGNED FOR USE IN CLOSED COURSE  
RACING AND IS NOT INTENDED FOR HIGHWAY USE.**



NOTE: IN THE STATE OF CALIFORNIA, IT IS ILLEGAL TO MODIFY THE EMISSION CONTROL SYSTEM. WHICH INCLUDES THE CARBURETORS OF ANY VEHICLE.

**Caution:** Exhaust system can be extremely hot. Let motorcycle cool down before beginning installation.

**Note:** Read through all instructions before beginning installation.

## Tools Needed:

12mm socket  
Ratchet and extension  
12mm and 14mm wrench  
Torque wrench

## Installation Steps:

- 1 Remove stock muffler and gasket. (See Fig.1)
- 2 Loosen tail-pipe bolt at chassis mount (See Fig.1)
- 3 Install new muffler gasket.  
(Not supplied - Suzuki part no. 14181-02F00)
- 4 Install Yoshimura muffler using supplied bolts. Torque bolts to 2.5 kg-m (18 lb-ft).

**Note:** If you are looking directly at the four holes that connect the tailpipe to the muffler, the 16mm bolt will be used in the upper left corner. Use the 20mm bolts for the remaining 3 bolt holes.

- 5 Apply heat insulator to inside of muffler clamp and slide clamp onto muffler. (Note direction of clamp in Fig. 3)
- 6 Mount clamp to outside of stock muffler bracket using stock bolt, washer, and nut. (see Fig. 3)  
Torque bolt to 2.3 kg-m (16 lb-ft)
- 7 Tighten tail-pipe bolt at chassis mount. Torque bolt to 2.5 kg-m (18 lb-ft)
- 8 Before starting the motorcycle, check for proper clearance between new muffler and motorcycle. (i.e. swing-arm, passenger foot-peg, rear wheel, etc.) If any problem is found, please carefully follow through the installation steps again. If problem still persists, please call Yoshimura tech. Dept. at (800)634-9166 / in CA (909)628-4722.

**NOTE:** After starting motorcycle, it is normal for new muffler to emit smoke until oil residue burns off.



Fig. 1

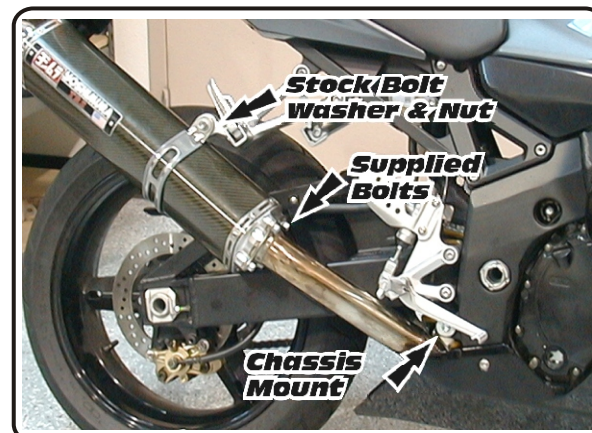

Fig. 2

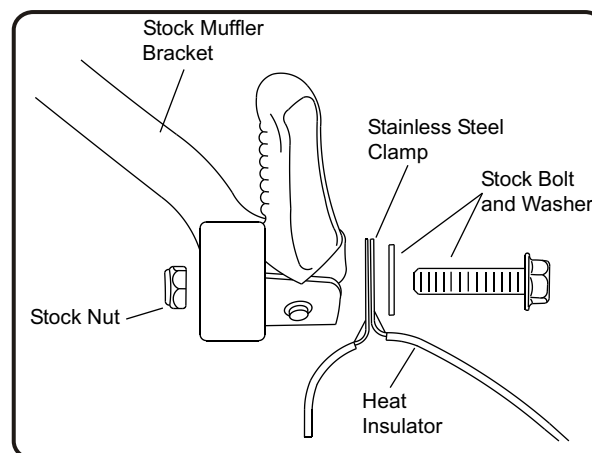
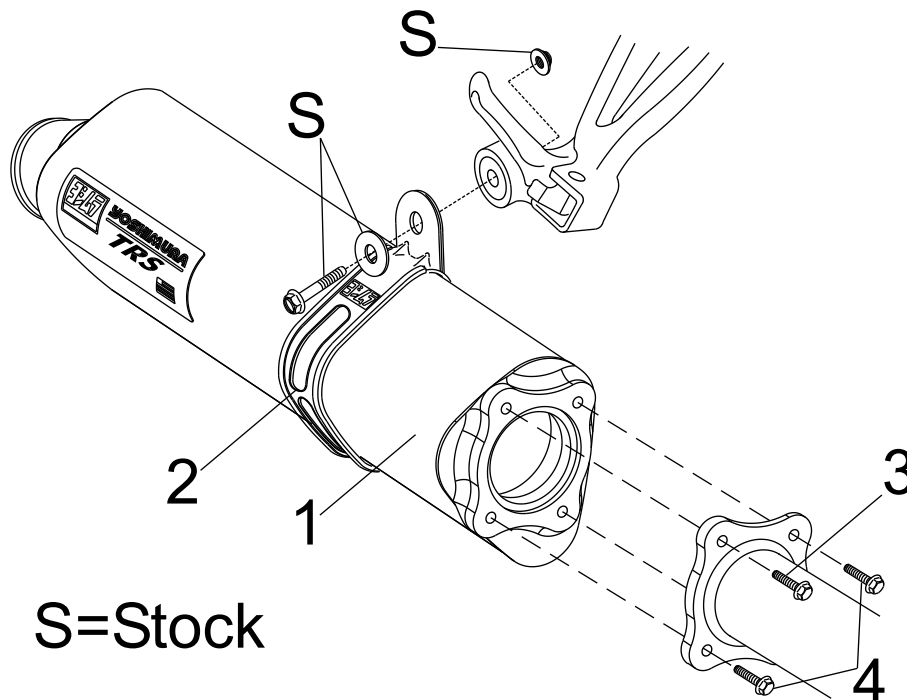

Fig. 3



**#110846 (2,5,7)**



Parts Diagram

NO.	DESCRIPTION	QTY	PART #
1	TRS Tri-Oval Muffler Assembly	1	**
2	TRS Stainless Steel Muffler Clamp Stainless Steel or Titanium Sleeve use Carbon Fiber Sleeve use	1	CTS083X CTS083
3	8mm x 16mm Flange Hex Bolt	1	M8X16H
4	8mm x 20mm Flange Hex Bolt	3	M8X20H
**	Muffler Clamp Heat Insulator	1	HT SHLDTRS
**	Yoshimura Vinyl Sticker	2	17028-BLK

**Nuts and Bolts Guide (Actual Size):**

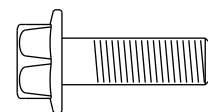

8mm x 20mm  
Flange Hex Bolt

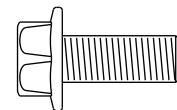

8mm x 16mm  
Flange Hex Bolt